

TRANSPORTATION COMMITTEE AGENDA
Room 404, Government Center
115 E. Washington Street, Bloomington, IL
Tuesday, January 11, 2005
8:00 a.m.

Roll Call

Approval of Minutes from December 7, 2004 Meeting

Recommend Payment of Bills to County Board

Appearance by Members of the Public and County Employees

Items to be Presented for Action

- | | | |
|----|---|---------|
| A. | Letting Results from December 29, 2004 for
County Projects | 1 – 2 |
| B. | Weight Limit Ordinance | 3 – 17 |
| C. | Resolution – CH 15 Stop Signs | 18 |
| D. | Safety Application – Evergreen Lake | 19 – 22 |

Items to be Presented for Information

- | | | |
|----|------------------------------|--|
| A. | Road Work Status | |
| | 1. Weathered Out of Projects | |
| B. | Other | |

Adjournment

RESOLUTION BY THE COUNTY BOARD OF MCLEAN COUNTY

WHEREAS, the bids were reviewed by the Transportation Committee of the McLean County Board at their meeting on January 11, 2005, for a letting held on December 29, 2004 for McLean County Maintenance Sections, and

WHEREAS, the Transportation Committee duly approved the bids on January 11, 2005

NOW THEREFORE BE IT RESOLVED by the County Board of McLean County that they award the following materials:

2005 MFT SECTIONS:

McLean County.....Section 05-00000-00-GM GR. 7

The successful bidder on the above section was:

Rowe Construction Company, Bloomington.....\$9,700.00

McLean County.....Section 05-00000-00-GM GR. 8

The successful bidder on the above section was:

McLean County Asphalt, Bloomington.....\$7,600.00

McLean County.....Section 05-00000-00-GM GR. 9

The successful bidder on the above section was:

McLean County Asphalt, Bloomington.....\$9,375.00

Rowe Construction Company, Bloomington.....\$9,500.00

Michael F. Sweeney, Chairman

STATE OF ILLINOIS]
] SS
COUNTY OF MCLEAN]

I, Peggy Ann Milton, County Clerk in and for said County is the State aforesaid and keeper of the records and files thereof, as provided by statutes, do hereby certify the foregoing to be a true, perfect and complete copy of a resolution adopted by the County Board of McLean County at its monthly meeting held at Bloomington, Illinois on January 18, 2005.

IN TESTIMONY WHEREOF, I have hereunto set my hand and affixed the seal of said County at my office in Bloomington, Illinois, in said County this 18th day of January A.D., 2005.

[SEAL]

County Clerk

McLEAN COUNTY HIGHWAY DEPARTMENT
DECEMBER 29, 2004

McLEAN COUNTY
SEC. 05-000000-00-GM GR 7

ITEM
Bituminous Patching Mix M19-02a
Location of Stockpile

DELIVERY UNIT QUANTITY UNIT PRICE
On Truck Ton 200 \$45.00

ENGINEERS ESTIMATE
TOTAL \$9,000.00

ROWE	
UNIT PRICE	TOTAL
\$48.50	\$9,700.00
	\$9,700.00
	7.78%
	DOWNNS

McLEAN CO ASPHALT

UNIT PRICE TOTAL
\$0.00
\$0.00
-100.00%

McLEAN COUNTY
SEC. 05-000000-00-GM GR 8

ITEM
Bituminous Premix Sylvax M 120-00
Location of Stockpile

DELIVERY UNIT QUANTITY UNIT PRICE
On Truck Ton 100 \$78.00

ENGINEERS ESTIMATE
TOTAL \$7,800.00

ROWE	
UNIT PRICE	TOTAL
	\$0.00
	\$0.00
	-100.00%

McLEAN CO ASPHALT

UNIT PRICE TOTAL
\$76.00 \$7,600.00
\$7,600.00
-2.56%

McLEAN COUNTY
SEC. 05-000000-00-GM GR 9

ITEM
Incidental Bituminous Surface
Location of Asphalt Plant

DELIVERY UNIT QUANTITY UNIT PRICE
On Truck Ton 250 \$40.00

ENGINEERS ESTIMATE
TOTAL \$10,000.00

ROWE	
UNIT PRICE	TOTAL
\$38.00	\$9,500.00
	\$9,500.00
	-5.00%
	NORTHTOWN, DOWNNS, SHIRLEY

McLEAN CO ASPHALT

UNIT PRICE TOTAL
\$37.50 \$9,375.00
\$9,375.00
-6.25%

ORDINANCE IMPOSING WEIGHT LIMITATIONS UPON TRUCKS AND
COMMERCIAL VEHICLES AND PROVIDING A PENALTY FOR
A VIOLATION THEREOF

WHEREAS, the State of Illinois, by its General Assembly, has enacted "The Illinois Vehicle Code" effective July 1, 1970, with amendments thereto, which act is now in full force and effect, and,

WHEREAS, Section 625 ILCS 5/15-316 of the Illinois Compiled Statutes provides that local authorities, with respect to highways under their jurisdiction, may by ordinance or resolution, prohibit the operation of trucks and other commercial vehicles, or may impose limitations as to the weight thereof on designated highways, which prohibitions and limitations shall be designated by appropriate signs placed on such highways, and

WHEREAS, certain highways under the jurisdiction of the County of McLean, State of Illinois, have been seriously damaged and deteriorated by the operation of certain vehicles of excessive weight thereon, and

WHEREAS, the continued use of trucks and commercial vehicles on said roads in excess of certain weights will in the future seriously damage and deteriorate said roads,

NOW, THEREFORE, BE IT ORDAINED by the Board of McLean County, in regular session, by virtue of the Act of hereinabove referred to, that referred to, that the weight of trucks and commercial vehicles operated upon the particular Class "A" roads hereinafter set forth shall be limited as follows:

From January 15th until April 15th of each year the operation of trucks and commercial vehicles upon said highways of a gross weight of more than twenty thousand (20,000) pounds shall be prohibited.

From the period of April 15th to the 15th day of the following January in each year, the operation of the following described trucks and commercial vehicles shall be prohibited on said highways.

Trucks and commercial vehicles with one front axle and two rear tandem axles with dual tires, of a gross weight over thirty-eight thousand (38,000) pounds.

Trucks and commercial vehicles with one front axle and two rear axles, including trailer axles, more than seventy-two inches (72") apart with dual tires, of a gross weight over forty-two thousand (42,000) pounds.

Trucks and commercial vehicle with one front axle and three rear axles including trailer axles, each rear axle having dual tires, of a gross weight over fifty-four thousand (54,000) pounds.

Trucks and commercial vehicles with one front axle and four rear axles including trailer axles, each rear axle having dual tires, a gross weight over sixty-four thousand (64,000) pounds.

The weight referred to above means the overall weight of vehicle and its load.

Single flotation type tires will be recognized in lieu of dual tires if certified equivalent by the manufacturer.

BE IT FURTHER ORDAINED that the highways upon which the operation of said trucks and commercial vehicles of the weights herein set forth are as follows:

COUNTY HIGHWAY 17: (Cooksville Road) beginning at Route 9 at the SW corner of the SE ¼ of Sec. 35, T 24 N, R 4 E, of the 3rd P.M. and extending northerly approximately 3 ½ miles to the South Corporate Limits of Cooksville at approximately the SW corner of the NE ¼ of Sec. 14, T 24 N, R 4 E of the 3rd P.M.

COUNTY HIGHWAY 21: (LeRoy Road) beginning at the SE corner of Sec. 33, T 22 N, R 4 E of the 3rd P.M. at Route 136 and extending northerly and westerly approximately 2 ½ miles to the LeRoy Spur near the SW corner of the SE ¼ of the NE ¼ of Sec. 29, T 22 N, R 4 E of the 3rd P.M. Also beginning near the SE corner of Sec. 20, T 22 N, R 4 E of the 3rd P.M. at Rt 150 and extending in a northerly direction approximately 9 ¼ miles to Route 9 near the NW corner of Sec. 4, T 23 N, R 4 E of the 3rd P.M.

COUNTY HIGHWAY 21: (Lexington – LeRoy Road) beginning at Route 165 at the SE corner of Sec. 8, T 24 N, R 4 E of the 3rd P.M. and extending northerly 6 ½ miles to the NW corner of the SW ¼ of Sec. 9, T 25 N, R 4 E of the 3rd P.M.

COUNTY HIGHWAY 29: (Gillium Road) beginning at the SW corner of Sec. 32, T 22 N., R 3 E of the 3rd P.M. at Route 136 and extending northerly approximately 5 miles to the NW corner of Sec. 8, T 22 N., R 3 E of the 3rd P.M.

COUNTY HIGHWAY 31: (Pipeline Road) beginning at the SW corner Sec. 24, T 25 N, R 2 E of the 3rd P.M. and extending northerly and easterly approximately 4 miles to County Highway 8 near the NE corner of the NW ¼ of Sec. 12, T 25 N, R 2 E of the 3rd P.M.

COUNTY HIGHWAY 59: (Stanford – McLean Road) beginning at Route 136 near the SE corner of Sec. 34, T 22, R 1 W of the 3rd P.M. and extending in a northerly and westerly direction approximately 3 miles to a point near the NW corner Sec. 27, T 22 N, R 1 W of the 3rd P.M. Also beginning at the SW corner of the SE1/4 of Sec. 33, T 23 N, R 1 W, of the 3rd P.M. and extending northerly for 2 miles to the NW corner of the NE1/4 of Sec. 28, T 23 N, R 1 W, of the 3rd P.M.

COUNTY HIGHWAY 63: (Ron Smith Memorial Highway) beginning at County Highway 31 near the SW corner of the NE ¼ of Sec. 13, T 25 N, R 2 E of the 3rd P.M. and extending in an easterly and northerly direction 4 ¼ miles to a point near the NW corner of the SW ¼ of Sec. 6, T 25 N, R 3 E of the 3rd P.M. at County Highway 8.

NOW THEREFORE, BE IT ORDAINED by the Board of McLean County, in regular session, by virtue of the Act hereinabove referred to, that the weight of trucks and commercial vehicles operated upon the particular Class “B” roads hereinafter set forth shall be limited as follows:

From January 15th until April 15th of each year the operation of trucks and commercial vehicles upon said highways of a gross weight of more than sixteen thousand (16,000) pounds shall be prohibited.

From the period of April 15th to the 15th day of the following January in each and every year, the operation of the following described trucks and commercial vehicles shall be prohibited on said highways.

Trucks and commercial vehicles with one front and one rear axle with dual tires, of a gross weight of twenty –six thousand (26,000) pounds or over.

Trucks and commercial vehicles with one front and two rear axles with dual tires, of a gross weight of thirty-six thousand (36,000) pounds or over.

Trucks and commercial vehicles with one front axle and three or more rear axles, and rear axle having dual tires, of a gross weight of forty-six thousand (46,000) pounds or over.

The maximum load weight of any truck or commercial vehicle shall not exceed forth-six thousand (46,000) pounds.

The weights referred to above mean the overall weight of vehicle and its load.

Single floatation type tires will be recognized in lieu of dual tires if certified equivalent by the manufacturer.

BE IT FURTHER ORDAINED that the Class “B” highways upon which the operation of said trucks and commercial vehicles of the weights hereinabove set forth are prohibited as follows:

COUNTY HIGHWAY 3: (Mansfield Road) beginning at the NE corner of Sec. 3, T 21 N, R 6 E of the 3rd P.M. at Route 136 and extending southerly approximately two miles to the SE corner of Sec. 10, T 21 N, R 6 E of the 3rd P.M. at the Piatt County line.

COUNTY HIGHWAY 6: (Kappa Road) beginning at the NW corner of Sec. 34, T 26 N, R 2 E of the 3rd P.M. at the Woodford County line and extending easterly approximately five miles to the NE corner of the SW ¼ of Sec. 32, T 26 N, R 3 E of the 3rd P.M.

COUNTY HIGHWAY 8: (Lexington East Road) beginning at Cargill Hybrid Seeds Entrance a point near the NW corner of the SW ¼ of Sec. 9, T 25 N, R 4 E of the 3rd P.M. and extending easterly approximately ten and one-quarter miles to the SE corner of the NE ¼ of the NE ¼ of Sec. 12, T 25 N, R 5 E of the 3rd P.M. at the Livingston County line.

COUNTY HIGHWAY 11: (Farmer City Road) beginning at the NE corner of the NW ¼ of Sec. 4, T 21 N, R 5 E of the 3rd P.M. at Route 136 and extending southerly approximately two miles to 670 feet west of the SW ¼ of Sec. 9, T 21 N, R 5 E of the 3rd P.M. on the DeWitt County line.

COUNTY HIGHWAY 12: (Hudson Road) beginning at the NE corner of the SW ¼ of the SW ¼ of Sec. 20, T 25 N, R 1 E of the 3rd P.M. at the Woodford County line and extending easterly approximately five miles to the NE corner of the SE ¼ of Sec. 24, T 25 N, R 1 E of the 3rd P.M. Also beginning at the NW corner of Sec. 30, T 25 N, R 2 E of the 3rd P.M. and extending easterly to the SE corner of Sec. 20, T 25 N, R 2 E of the 3rd P.M. at I-39. Also beginning at the NW corner of Sec. 25, T 25 N, R 2 E of the 3rd P.M. and extending two miles to the NE corner of Sec. 30, T 25 N, R 3 E of the 3rd P.M. Also beginning at the NW corner of the NE ¼ of Sec. 29, T 25 N, R 3 E of the 3rd P.M. extending in an easterly direction approximately three and one-quarter miles to the SW corner of the SE ¼ of the SE ¼ of Sec. 23, T 25 N, R 3 E of the 3rd P.M.

COUNTY HIGHWAY 15: (Sabina Road) beginning at the SW corner of Sec. 33, T 22 N, R 5 E of the 3rd P.M. at Route 136 and extending northerly and easterly approximately nine miles to the NE corner of Sec. 28, T 23 N, R 5 E of the 3rd P.M.

COUNTY HIGHWAY 19: (Chenoa Road) beginning at Route 66 near the north corporate limit of Chenoa a point near the SW corner of the NW ¼ of Sec. 1, T 23 N, R 4 E of the 3rd P.M. and extending in a northerly direction approximately ¼ mile to the NW corner of Sec. 1, T 26 N, R 4 E of the 3rd P.M. at the Livingston County line.

COUNTY HIGHWAY 19: (Chenoa Road) beginning at the SW corner of the NW ¼ of Sec. 11, T 25 N, R 4 E of the 3rd P.M. and extending northerly and easterly approximately seven miles to the south corporate limits of Chenoa near the NW corner of the SW ¼ of Sec. 12, T 26 N, R 4 E of the 3rd P.M.

COUNTY HIGHWAY 21: (LeRoy Road) beginning at the SE corner of Sec. 9, T 21 N, R 4 E of the 3rd P.M. at the DeWitt County line and extending northerly approximately two miles to the NW corner of Sec. 3, T 21 N, R 4 E of the 3rd P.M. at Route 136.

COUNTY HIGHWAY 23: (Meadows Road) beginning near the SE corner of the NE $\frac{1}{4}$ of the NW $\frac{1}{4}$ of Sec. 7, T 25 N, R 4 E of the 3rd P.M. and extending northerly approximately seven and three-quarters miles to the NE corner of Sec. 6, T 26 N, R 4 E of the 3rd P.M. at the Livingston County line.

COUNTY HIGHWAY 25: (Holder Road) beginning at the SW corner of Sec. 18, T 23 N, R 4 E of the 3rd P.M. and extending northerly approximately one-half miles to the railroad tracks at Holder near NW corner of the SW $\frac{1}{4}$ of Sec. 18, T 23 N, R 4 E of the 3rd P.M.

COUNTY HIGHWAY 27: (South Downs Road) beginning at the SE corner of Sec. 9, T 21 N, R 3 E of the 3rd P.M. at the DeWitt County line and extending northerly approximately seven and three-quarters miles to a point near the SE corner of the SW $\frac{1}{4}$ of the SW $\frac{1}{4}$ of Sec. 4, T 22 N, R 3 E of the 3rd P.M.

COUNTY HIGHWAY 28: (Ireland Grove Road) beginning at the NW corner of Sec. 17, T 23, N, R 3 E of the 3rd P.M. and extending easterly approximately five miles to the NE corner of Sec. 13, T 23 N, R 3 E of the 3rd P.M. Also beginning at the SW corner of Sec. 18, T 23 N, R 4 E of the 3rd P.M. and extending easterly approximately four and one-half miles to the SE corner of the SW $\frac{1}{4}$ of Sec. 14, T 23 N, R 4 E of the 3rd P.M. Also beginning at the SW corner of the SE $\frac{1}{4}$ of Sec. 11, T 23 N, R 4 E, 3rd P.M. extending easterly approximately four and one-half miles to the NE corner of Sec. 16, T 23 N, R 5 E of the 3rd P.M.

COUNTY HIGHWAY 30: (Colonial Motel Road) beginning at approximately the SW corner of the NW $\frac{1}{4}$ of the NE $\frac{1}{4}$ Sec. 26, T 23 N, R 2 E, 3rd P.M. and extending easterly and northerly approximately 1 $\frac{3}{4}$ miles to Route 150 a point near the NE corner of the SW $\frac{1}{4}$ of Sec. 24, T 23 N, R 2 E of the 3rd P.M.

COUNTY HIGHWAY 34: (Shirley Road) beginning at the SW corner of Sec. 34, T 23 N, R 1 W and extending easterly and northerly approximately eight miles to the SW corner of the NE $\frac{1}{4}$ of Sec. 35, T 23 N, R 1 E of the 3rd P.M. at Rt. 66. Also beginning at the intersection of CH 41 and CH 34 a point near the SW corner of the NE $\frac{1}{4}$ of Sec. 37, T 23 N, R 1 E of the 3rd P.M. and extending easterly approximately two and one-quarter miles to the SE corner of the NW $\frac{1}{4}$ of Sec. 32, T 23 N, R 2 E of the 3rd P.M.

COUNTY HIGHWAY 36: (Funks Grove Road) beginning at the SW corner of Sec. 10, T 22 N, R 1 W of the 3rd P.M. and extending easterly approximately twelve and three-quarter miles to a point approximately six hundred feet north of the SW corner of the SE $\frac{1}{4}$ of Sec. 9, T 22 N, R 2 E of the 3rd P.M. at Route 51. Also (Thomas Craft Road) beginning at the SW corner of the SE $\frac{1}{4}$ of Sec. 33, T 23 N, R 3 E of the 3rd P.M. at Route 150 and extending easterly approximately five and one-half miles to the SE corner of Sec. 32, T 23 N, R 4 E of the 3rd P.M.

Also (Dawson Lake Road) beginning at the SW corner of the NW ¼ of the NW ¼ of Sec. 33, T 23 N, R 4 E of the 3rd P.M. and extending easterly and northerly approximately eight and three-quarter miles to the NE corner of Sec. 28, T 23 N, R 5 E of the 3rd P.M.

COUNTY HIGHWAY 40: (Rock Road) beginning at the SW corner of Sec. 16, T 22 N, R 5 E of the 3rd P.M. and extending easterly approximately six and one-half miles to the NE corner of the NW ¼ of Sec. 21, T 22 N, R 6 E of the 3rd P.M.

COUNTY HIGHWAY 45: (Waynesville Road) beginning at the SW corner of Sec. 8, T 21 N, R 1 E of the 3rd P.M. at the DeWitt County line and extending northerly approximately one and three-quarters miles to a point near the SW corner of the NW ¼ of the NW ¼ of Sec. 5, T 21 N, R 1 E of the 3rd P.M. approximately ¼ mile south of Route 136.

COUNTY HIGHWAY 53: (Danvers – Carlock Road) beginning at the north corporate limits of Danvers near the SW corner of the SE ¼ of the NE ¼ of Sec 14, T 24 N, R 1 W of the 3rd P.M. and extending in a northerly and easterly direction approximately five miles to the West On/Off Ramps of I-74 at Carlock near the SW corner of the NE ¼ of Sec. 31, T 25 N, R 1 E of the 3rd P.M.

COUNTY HIGHWAY 55: (Congerville Road) beginning at the SE corner of the SW ¼ of Sec. 14, T 24 N, R 1 W of the 3rd P.M. at the West Corporate Limit of Danvers and extending westerly and northerly approximately five and one-half miles to the NW corner of the SE ¼ of Sec. 27, T 25 N, R 1 W of the 3rd P.M. at the Woodford County line.

COUNTY HIGHWAY 65: (Sweeney Road) beginning at the SW corner of SE ¼ of the SE ¼ of Sec. 23, T 25 N, R 3 E of the 3rd P.M. and extending northerly ¼ mile to the NW corner of the SE ¼ of the SE ¼ of Sec. 23, T 25 N, R 3 E, of the 3rd P.M. at Route 66

NOW THEREFORE, BE IT ORDAINED by the Board of McLean County, in regular session, by virtue of the Act hereinabove referred to, that the weight of trucks and commercial vehicles operated upon the particular Class “C” roads hereinafter set forth shall be limited as follows:

From January 15th until April 15th of each year the operation of trucks and commercial vehicles upon said highways of a gross weight of more than twenty thousand (20,000) pounds shall be prohibited.

From the period of April 15th to the 15-day of the following January in each year, the operation of the following described trucks and commercial vehicles shall be prohibited on said highways.

Trucks and commercial vehicles of a gross weight over seventy-three thousand two hundred eighty pounds (73,280) as provided in Section 625 ILCS 5/15-111 of the Illinois Compiled Statutes.

COUNTY HIGHWAY 1: (Cropsey Road) beginning at Yates street in Cropsey near the SE corner of the NE ¼ of Sec. 23, T 25 N, R 6 E of the 3rd P.M. and extending northerly and westerly approximately one and one-half miles to the NW corner of Sec. 23, T 25 N, R 6 E of the 3rd P.M.

COUNTY HIGHWAY 5: (Saybrook – Bellflower Road) beginning at the North Corporate limits of Bellflower at the approximate NW corner of the SE ¼ of Sec. 21, T 22 N, R 6 E of the 3rd P.M. and extending northerly approximately five and one-quarter miles to the South Corporate limits at Saybrook at the SE corner of the NW ¼ of Sec. 28, T 23 N, R 5 E of the 3rd P.M.

COUNTY HIGHWAY 7: (Anchor Road) beginning at Route 9 at the SE corner of Sec. 32, T 24 N, R 6 E of the 3rd P.M. and extending northerly approximately five and one-half miles to the South Corporate limits of Anchor at the NW corner of the SE ¼ of Sec. 5, T 24 N, R 6 E of the 3rd P.M.

COUNTY HIGHWAY 8: (Comlara Park Road) beginning at the Woodford County line near the NW corner of Sec. 7, T 25 N, R 2 E of the 3rd P.M. and extending easterly approximately 2 miles to the West on/off ramps of I-39 near the NE corner of Sec. 8, T 25 N, R 2 E of the 3rd P.M.

COUNTY HIGHWAY 8: (P.J. Keller Highway) beginning near SE corner of the NW ¼ of Sec. 1, T 25 N, R 2 E of the 3rd P.M. at the entrance to the City of Bloomington filtration plant located on the west side of Lake Bloomington and extending easterly approximately seven and one-half miles to the west on/off ramps of I-55 near the SW corner of the NE ¼ of the NE ¼ of Sec. 12, T 25 N, R 3 E of the 3rd P.M.

COUNTY HIGHWAY 12: (Hudson Road) beginning at the east corporate limits of Hudson a point near the NW corner of Sec. 27, T 25 N, R 2 E of the 3rd P.M. and extending in an easterly direction for two miles to the NE corner of Sec. 26, T 25 N, R 2 E of the 3rd P.M.

COUNTY HIGHWAY 13: (Colfax-Weston Road) beginning at Route 165 in Colfax at the SE corner of Sec. 34, T 25 N, R 5 E of the 3rd P.M. and extending northerly approximately 12 miles to Route 24 at the NE corner of Sec. 10, T 26 N, R 5 E of the 3rd P.M. Also beginning at approximately the SW corner Sec. 3, T 24 N, R 5 E of the 3rd P.M. and extending easterly approximately 1 mile and northerly ¼ mile to the south corporate limits of Colfax.

COUNTY HIGHWAY 14: (Towanda-East Road) beginning at the intersection of Jefferson & Hely streets in Towanda a point near the SW corner of Sec. 5 and extending easterly and southerly 4 ¾ miles to a point near the SE corner of Sec. 11, T 24 N, R 3 E of the 3rd P.M. at Route 165.

COUNTY HIGHWAY 15: (Arrowsmith Road) beginning at the south corporate limits of Arrowsmith at the approximate NW corner of the SW $\frac{1}{4}$ of Sec. 15, T 23 N., R 5 E of the 3rd P.M. and extending southerly approximately 1 $\frac{1}{4}$ miles to the SW corner of Sec. 22, T 23 N, R 5 E of the 3rd P.M.

COUNTY HIGHWAY 15: (Colfax Road) beginning at the SE corner of Sec. 33, T 24 N, R 5 E of the 3rd P.M. at Route 9 and extending in a northerly direction approximately five and one-quarter miles to the NE corner of the SE $\frac{1}{4}$ of the SE $\frac{1}{4}$ of Sec. 4, T 24 N, R 5 E of the 3rd P.M. at Route 165.

COUNTY HIGHWAY 17: (Ellsworth Road) beginning at the SE corner of the NE $\frac{1}{4}$ of the NW $\frac{1}{4}$ of Sec. 26, T 23 N, R 4 E of the 3rd P.M. and extending northerly approximately 1 $\frac{1}{2}$ miles to the South Corporate limits of Ellsworth a point near the NE corner of the SE $\frac{1}{4}$ of Sec. 14, T 23 N, R 4 E of the 3rd P.M.

COUNTY HIGHWAY 18: (Danvers-Yuton Road) beginning at the East Corporate Limits of Danvers at the NW corner of the NE $\frac{1}{4}$ of Sec. 24, T 24 N, R 1 W of the 3rd P.M. and extending easterly approximately 5 $\frac{1}{4}$ miles to a point near the NW corner of the NE $\frac{1}{4}$ of the NE $\frac{1}{4}$ of Sec. 23, T 24 N, R 1 E of the 3rd P.M. (Elevator Entrance).

COUNTY HIGHWAY 21: (Lexington-Leroy Road) beginning at Route 9 at the SE corner of Sec. 32, T 24 N, R 4 E of the 3rd P.M. and extending northerly approximately four miles to Route 165 near the NE corner of Sec. 17, T 24 N, R 4 E of the 3rd P.M.

COUNTY HIGHWAY 24: (Sec. V) beginning at the NW corner of Sec. 6, T 23 N, R 1 W of the 3rd P.M. the Tazwell County line and extending easterly approximately 4 miles to Route 122 at the NE corner of Sec. 3, T 23 N, R 1 W of the 3rd P.M.

COUNTY HIGHWAY 29: (Gillium Road) beginning at the NW corner of Sec. 8, T 22 N, R 3 E of the 3rd P.M. and extending northerly approximately 2 $\frac{1}{4}$ miles to Rt. 150.

COUNTY HIGHWAY 29: (Towanda-Barnes Road) beginning at the SW corner of Sec. 20, T 24 N, R 3 E of the 3rd P.M. and extending northerly approximately three and one-fourth miles to County Highway 14.

COUNTY HIGHWAY 29: (Towanda - Gridley Road) beginning at approximately the SE corner of the NE $\frac{1}{4}$ of Sec. 31, T 25 N, R 3 E, of the 3rd P.M. and extending northerly and easterly approximately 12 miles to the South Corporate Limits of Gridley at the SW corner of the NW $\frac{1}{4}$ of the NE $\frac{1}{4}$ of Sec. 9, T 26 N, R 3 E of the 3rd P.M.

COUNTY HIGHWAY 30: (Colonial Motel Road) beginning at the SW Corner of the SE $\frac{1}{4}$ of Sec. 21, T 23 N, R 2 E, of the 3rd P.M. at Route 51 and extending easterly 2 miles to SW corner of the NW $\frac{1}{4}$ of the NE $\frac{1}{4}$ of Sec. 26, T 23 N, R 2 E or the 3rd P.M.

COUNTY HIGHWAY 31: (Pipeline Road) beginning at Northtown Road near the SW corner of Sec. 12, T 24 N, R 2 E of the 3rd P.M. and extending in a northerly direction approximately four miles to the NE corner of Sec. 26, T 25 N, R 2 E of the 3rd P.M.

COUNTY HIGHWAY 32: (Stringtown Road) beginning at the SW corner of the SE ¼ of Sec. 21, T 23 N, R 1 W of the 3rd P.M. and extending in an easterly direction approximately 6 ½ miles to a point near the SE corner of Sec. 21, T 23 N, R 1 E of the 3rd P.M.

COUNTY HIGHWAY 33: (Comlara Park Road) beginning at the SW corner of Sec. 8, T 25 N, R 2 E of the 3rd P.M. and extending northerly approximately 1 ¼ miles to County Highway 8 near the NE corner of Sec. 7, T 25 N, R 2 E of the 3rd P.M.

COUNTY HIGHWAY 34: (Olympia School Road) beginning at the Tazewell County Line near the SW corner of Sec. 31, T 23 N, R 1 W of the 3rd P.M. and extending easterly to the SE corner of Sec. 33, T 23 N, R 1 W of the 3rd P.M.

COUNTY HIGHWAY 36: (Downs Road) beginning at The Kickapoo Creek Bridge a point near the NE corner of the NW ¼ of Sec. 11, T 22 N, R 2 E of the 3rd P.M. and extending easterly 2 ½ miles to County Highway 29 a point near the NE corner of Sec. 7, T 22 N, R 3 E, of the 3rd P.M..

COUNTY HIGHWAY 36: (Saybrook Road) beginning at the SW corner of Sec. 22, T 23 N, R 5 E of the 3rd P.M. and extending easterly approximately five miles to the SE corner of Sec. 20, T 23 N, R 6 E near the Saybrook corporate limits.

COUNTY HIGHWAY 37: (Linden Street) beginning at Northtown Road a point near the SE corner of Sec. 9 and extending in a northerly and westerly direction 4 ¼ miles to County Highway 12 a point near the NW corner of the NE ¼ of the NE ¼ of Sec. 28, T 25 N, R 2 E of the 3rd P.M.

COUNTY HIGHWAY 39: (Ropp Road) beginning at County Highway 70 a point near the SW corner of Sec. 19, T 24 N, R 2 E of the 3rd P.M. at extending northerly approximately 8 ½ miles to Evergreen Lake near the SW corner of the NW ¼ of Sec. 7, T 25 N, R 2 E of the 3rd P.M.

COUNTY HIGHWAY 40: (Leroy School Road) beginning at County Highway 21 a point near the SW corner of Sec. 16, T 22 N, R 4 E of the 3rd P.M. and extending easterly 6 miles to the SW corner of Sec. 16, T 22 N, R 5 E of the 3rd P.M.

COUNTY HIGHWAY 59: (Stanford-McLean Road) beginning at the SE corner of Sec. 21, T 22 N, R 1 W of the 3rd P.M. and extending northerly for four miles to the NE corner of Sec. 4, T 22 N, R 1 W.

COUNTY HIGHWAY 67: (Gridley Road) beginning at the Railroad tracks in Gridley and extending northerly 7/8 mile to the Livingston County line near the NW corner of Sec. 3, T 26 N, R 3 E of the 3rd P.M.

NOW THEREFORE, BE IT ORDAINED by the Board of McLean County, in regular session, by virtue of the Act hereinabove referred to, that the weight of trucks and commercial vehicles operated upon the particular Class "D" roads hereinafter set forth shall be limited as follows:

The operation of trucks and commercial vehicles upon said highways of a gross weight of more than Seventy three thousand two hundred eighty (73,280) pounds as provided for in Section 625 ILCS 5/15-111 of the Illinois Compiled Statutes shall be prohibited

BE IT FURTHER ORDAINED that the Class "D" highways upon which the operation of said trucks and commercial vehicles of the weights hereinabove set forth are prohibited as follows:

COUNTY HIGHWAY 5: (Bellflower Spur) beginning at Route 136 near the SW corner of the SE ¼ of Sec. 33, T 22 N, R 6 E of the 3rd P.M. and extending northerly for two and ½ miles to the north corporate limits of Bellflower. Also beginning at the south corporate limits of Saybrook and extending northerly for approximately 3/8 mile to a point approximately 512 feet north of the railroad crossing (Lincoln Street) of County Highway 5 in Saybrook.

COUNTY HIGHWAY 7: (Anchor Road) beginning at the south corporate limits of Anchor and extending north for approximately ½ mile to Illinois Route 165.

COUNTY HIGHWAY 12: (Hudson Road) beginning at the SW corner of Sec. 21, T 25 N, R 2 E, 3rd P.M. (west on/off ramps of I-39) and extending easterly for 1 mile to the east corporate limits of Hudson.

COUNTY HIGHWAY 13: (Colfax Road) beginning at the south corporate limits of Colfax and extending northerly approximately ¾ mile to Illinois Route 165.

COUNTY HIGHWAY 17: (Ellsworth Road) beginning at the south corporate limits of Ellsworth and extending northerly for 2 ¾ mile to Illinois Route 9. Also the Cooksville Road beginning at the south corporate limits of Cooksville to and extending northerly approximately ½ mile to Illinois Route 165.

COUNTY HIGHWAY 18: (Danvers-Yuton Road) beginning at the intersection of West Street and North Street in Danvers and extending easterly for ¾ mile to the east

corporate limits of Danvers. Also beginning at the Yuton Elevator entrance off CH 18 west of the railroad tracks and extending easterly for ¼ mile to Whiteoak Road (CH 70).

COUNTY HIGHWAY 19: (Chenoa Road) beginning at the south corporate limits of Chenoa and extending northerly approximately 1 ¼ miles to Route 66 near the north corporate limits of Chenoa.

COUNTY HIGHWAY 25: (Holder Road) beginning at the railroad near the NW corner of the SW ¼ of Sec. 18, T 23 N, R 4 E of the 3rd P.M. and extending northerly 2 ½ miles to Illinois Route 9.

COUNTY HIGHWAY 27: (Downs Road) beginning at Franklin Street in Downs and extending northerly ½ mile to Route 150.

COUNTY HIGHWAY 29: (Towanda-Barnes Road) beginning at the intersection of CH 29 (Jefferson Street) and CH 14 (Hely Street) near the south corporate limits of Towanda and extending northerly ½ mile to Route 66.

COUNTY HIGHWAY 29: (Gridley Road) beginning at the south corporate limits of Gridley and extending north ¼ mile to Route 24 in Gridley.

COUNTY HIGHWAY 34: (Shirley Road) beginning at the SE corner of the NW ¼ of Sec. 32, T 23 N, R 2 E, of the 3rd P.M. and extending easterly one mile to Illinois route 51.

COUNTY HIGHWAY 36: (Downs Road) beginning at the NW corner of Sec. 8, T 22 N, R 3 E of the 3rd P.M. (intersection of CH 29 and CH 36) and extending easterly 1 ½ mile to the intersection of CH 36 and CH 27. Also beginning at the intersection of Seminary and Washington Streets in Downs and extending easterly ½ mile to Route 150.

COUNTY HIGHWAY 36: (Saybrook Road) beginning at the West Corporate Limits of Saybrook a point near the SE Coner of Sec 20, T 23 N, R 6 E of the 3rd P.M. and extending easterly ½ mile to the Saybrook slab.

COUNTY HIGHWAY 41: (Funk Farm Road) beginning at the NW corner of the SW ¼ of Sec. 13, T 22 N, R 1 E, 3rd P.M. and extending northerly 3 ½ miles to CH 34 (Shirley Road) near the I-55 overpass at Shirley.

COUNTY HIGHWAY 44: (McLean Road) beginning at the intersection of Route 136 and West Street in McLean and extending northerly ½ mile thence westerly ½ mile to County Highway 59 a point near the SW corner of the NW ¼ of Sec. 35, T 22 N, R 1 W of the 3rd P.M.

COUNTY HIGHWAY 45: (Waynesville Road) beginning at the NW corner of the SW ¼ of the NW ¼ of Sec. 5, T 21 N, R 1 W of the 3rd P.M. and extending northerly ¼ mile to Route 136.

COUNTY HIGHWAY 53: (Danvers-Carlock Road) beginning at the intersection of West Street (CH 53) and North Street (CH 18) and extending northerly ½ mile to the

north corporate limits of Danvers. Also beginning at the east on/off ramps of I-74 at Carlock and extending easterly ¼ mile to Rt. 150 in Carlock.

COUNTY HIGHWAY 55: (Congerville Road) beginning at the west corporate limits of Danvers and extending easterly ½ mile to the intersection of West Street (CH 53) and North Street (CH 18) in Danvers.

COUNTY HIGHWAY 59: (Stanford-McLean Road) beginning at the NW corner of the NE ¼ of Sec. 28, T 23 N, R 1 W of the 3rd P.M. and extending northerly ½ mile to Main Street in Stanford.

COUNTY HIGHWAY 67: (Gridley Road) beginning at the intersection of Ford Street (CH 67) and Rt. 24 and extending northerly 1/8 mile to the Railroad tracks in Gridley.

COUNTY HIGHWAY 70: (Whiteoak Road) beginning at the intersection of Locust street and Whiteoak Road (CH 70) and extending Northwesterly for 4 ½ miles to the NW corner of the SW ¼ of Sec. 13, T 24 N, R 1 E, 3rd P.M. the intersection with new Rt. 150.

NOW THEREFORE, BE IT ORDAINED by the Board of McLean County, in regular session, by virtue of the Act hereinabove referred to, that the weight of trucks and commercial vehicles operated upon the particular Class "III" roads hereinafter set forth shall be limited as follows:

The operation of trucks and commercial vehicles upon said highways of a gross weight of more than Eighty Thousand (80,000) as provided for in Section 625 ILCS 5/15-111 of the Illinois Compiled Statutes shall be prohibited.

BE IT FURTHER ORDAINED that the Class "III" highways upon which the operation of said trucks and commercial vehicles of the weights hereinabove set forth are prohibited as follows:

COUNTY HIGHWAY 1: (Cropsey Road) beginning at Route 165 and extending northerly to Yates Street in Cropsey.

COUNTY HIGHWAY 8: (Lake Spur) beginning at I-39 and extending easterly to Lake Bloomington Dam.

COUNTY HIGHWAY 8: (Lexington Road) beginning at Interstate 55 and extending easterly to Cargill Hybrid Seeds entrance.

COUNTY HIGHWAY 13: (Weston Road) beginning at U.S. 24 and extending northerly approximately 1 mile to the Livingston County Line

COUNTY HIGHWAY 15: (Arrowsmith Road) beginning at Route 9 to the southern corporate limit of Arrowsmith.

COUNTY HIGHWAY 28: (Ireland Grove Road) beginning at Stride Drive and extending easterly 1 mile to the Towanda-Barnes Road (County Highway 29).

COUNTY HIGHWAY 29: (Towanda-Barnes Road) beginning at Rt. 150 and extending northerly 6 ¾ miles to Ft. Jesse Road.

COUNTY HIGHWAY 29: (Towanda-Barnes Road) beginning at the I-55 interchange and extending north approximately 2,150 feet to Reeve's Farm North Entrance.

COUNTY HIGHWAY 32: (Stringtown Road) beginning at Covell Road (CH 43) and extending easterly to Route 66 a distance of 3.15 miles.

COUNTY HIGHWAY 36: (Downs Road) beginning at Rt. 51 and extending easterly 2 miles to the Kickapoo Creek Bridge.

COUNTY HIGHWAY 43: (Covell Road) beginning at IL Route 9 southerly to Stringtown Road (C.H. 32) a distance of 4.03 miles.

BE IT FURTHER ORDAINED that it shall be unlawful for any person, firm or corporation to operate any truck or commercial vehicle upon the highways hereinabove designated, which truck or commercial vehicle exceeds the gross weights hereinabove set forth during the restricted periods contained herein, in violation of this Ordinance.

BE IT FURTHER ORDAINED that any person, firm or corporation duly found to be in violation of any of the terms and provisions hereof shall be guilty of a petty offense, with a penalty of a fine not to exceed \$500.00.

BE IT FURTHER ORDAINED that the County Superintendent of Highways shall erect or cause to be erected and maintained signs designating by work or symbol the provisions of the ordinance at each end of the portion of highways affected thereby.

BE IT FURTHER ORDAINED that the provisions of this Ordinance shall not apply to fire apparatus, or to vehicles operating under the terms of a special permit.

BE IT FURTHER ORDAINED that upon application in writing and good cause being shown, the County Superintendent of Highways may issue a Special Permit, at his discretion, in writing, authorizing the applicant to operate or move a vehicle of excessive maximum weight temporarily upon said highways, upon showing an undue hardship or upon showing that said vehicles cannot reasonable be dismantled or disassembled, said

Superintendent of Highways, however, may require such applicant to indemnify said County against any damages to road foundations or surfaces or structures, and may require such undertaking or other security as may be deemed necessary to compensate for any injury to said road or road structure prior to granting said permit.

This Ordinance shall be in full force and effect immediately upon its passage, adoption and approval as provided by law.

BE IT FURTHER ORDAINED that all previous resolutions and ordinances imposing weight limitations on McLean County Highways are hereby replaced.

Approved by the County Board of McLean County this 18th day of January.

Michael F. Sweeney, Chairman (Date)

STATE OF ILLINOIS]
] SS
COUNTY OF MCLEAN

I, Peggy Ann Milton, County Clerk in and for said County in the State aforesaid, and keeper of the records and files thereof, as provided by Statute, do hereby certify the foregoing to be a true, perfect and complete copy of an ordinance adopted by the County Board of McLean County at its monthly meeting held at Bloomington, Illinois on January 18, 2005.

IN TESTIMONY WHEREOF I have hereunto set my hand and affixed the seal of said County at my office in Bloomington, Illinois in said County this 18th day of January, A.D., 2005.

[SEAL]

County Clerk

**A RESOLUTION BY THE McLEAN COUNTY BOARD
TO INSTALL ALL WAY STOPS**

WHEREAS, the intersections on the Sabina / Arrowsmith Road (CH 15) at 750 North Road with 3200 East Road and at 750 North Road with 3300 East Road have been the site of several accidents, and

WHEREAS, the turning movement has become the heavier traffic volume, and

WHEREAS, the McLean County Highway Department has studied the said intersections and recommended that all way stops be installed, now

THEREFORE, be it hereby resolved by the McLean County Board that the above intersections on Sabina / Arrowsmith Road (CH 15) at 3200 East Road and at 3300 East Road be all way stops, and that the McLean County Highway Department is hereby directed to install the appropriate signing at said intersections.

APPROVED:

Michael F. Sweeney, (date)
Chairman, McLean County Board

ATTEST:

Peggy Ann Milton, Clerk of the County Board
McLean County, Illinois

IDOT District 3

Local Agency: McLEAN COUNTY HIGHWAY DEPT.

Route Name/ Number: C.H. 39

Limits 500' TO 1000' FROM BOAT RAMP. (Add Location Map)

Project Description: SEE ATTACHED SHEET.

ADT: 200

Traffic Signal Warrants:

	Number of personal Injury Accidents	Number of Property Damage Accidents	Total Number of Accidents
2003	<u>1</u>		
2002	<u>2</u>		
2001			<u>1 (3 FATALITIES)</u>
2000			

Total Estimated Cost: \$ 200,000 Total Safety Funds: \$ 180,000

NOTE: PROJECTS WILL BE CONSIDERED ONLY WHEN SUPPORTED BY ACCIDENT DATA (REPORTS AND/OR DIAGRAMS). SKID PROOFING WILL BE CONSIDERED IF SKID NUMBERS ARE PROVIDED.

Hazard Elimination Safety Program
C.H. 39
Evergreen Lake
12-21-04

Evergreen Lake was built in the early 1970's on the northwest side of McLean County. C.H. 39 was a due north-south road that intersected C.H. 8 before the lake was built. Once the lake was built, C.H. 39 was terminated approximately one quarter mile before C.H. 8. In the late 1970's, a boat ramp was constructed to provide access to the lake and C.H. 39 was reconstructed as a bituminous road to the boat ramp. Exhibit 1 is a map that shows the location of the site.

Over the years there have been many accidents at this location because drivers are unaware that the road ends. Exhibits 2 thru 5 are newspaper articles showing a few of the injuries and fatalities that have occurred the last three years. There have been numerous safety measures taken to warn drivers of the roadway ending such as speed reduction zones, rumble strips, double stop signs and other warning signs. Exhibits 6 thru 8 are pictures of the traffic signs and devices that are in place to warn of the pavement ending.

A proposed solution to the problem is to provide an offset intersection approximately 900 feet from the lake. At this location, the drivers will be forced to stop, make a left hand turn and then a right turn before connecting back into the existing road with a reverse curve at a distance of 350 feet from the stop sign. Exhibit 9 shows the proposed improvement. The existing roadway between the stop sign and the reverse curve would be removed and replaced with an arrester bed to stop an unaware motorist.

This improvement would allow for a deliberate change of the roadway alignment and force drivers to execute driving maneuvers to break up the monotony of a 55 mph straight road. The arrester bed will provide a safety zone that would stop an unacquainted motorist before driving off the ramp into the lake.

The approximate cost of the improvement would be \$200,000 in which \$75,000 would be contracted out, \$115,000 to be done by the County's day labor and engineering sections, and \$10,000 for additional lighting.

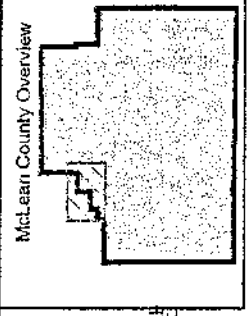
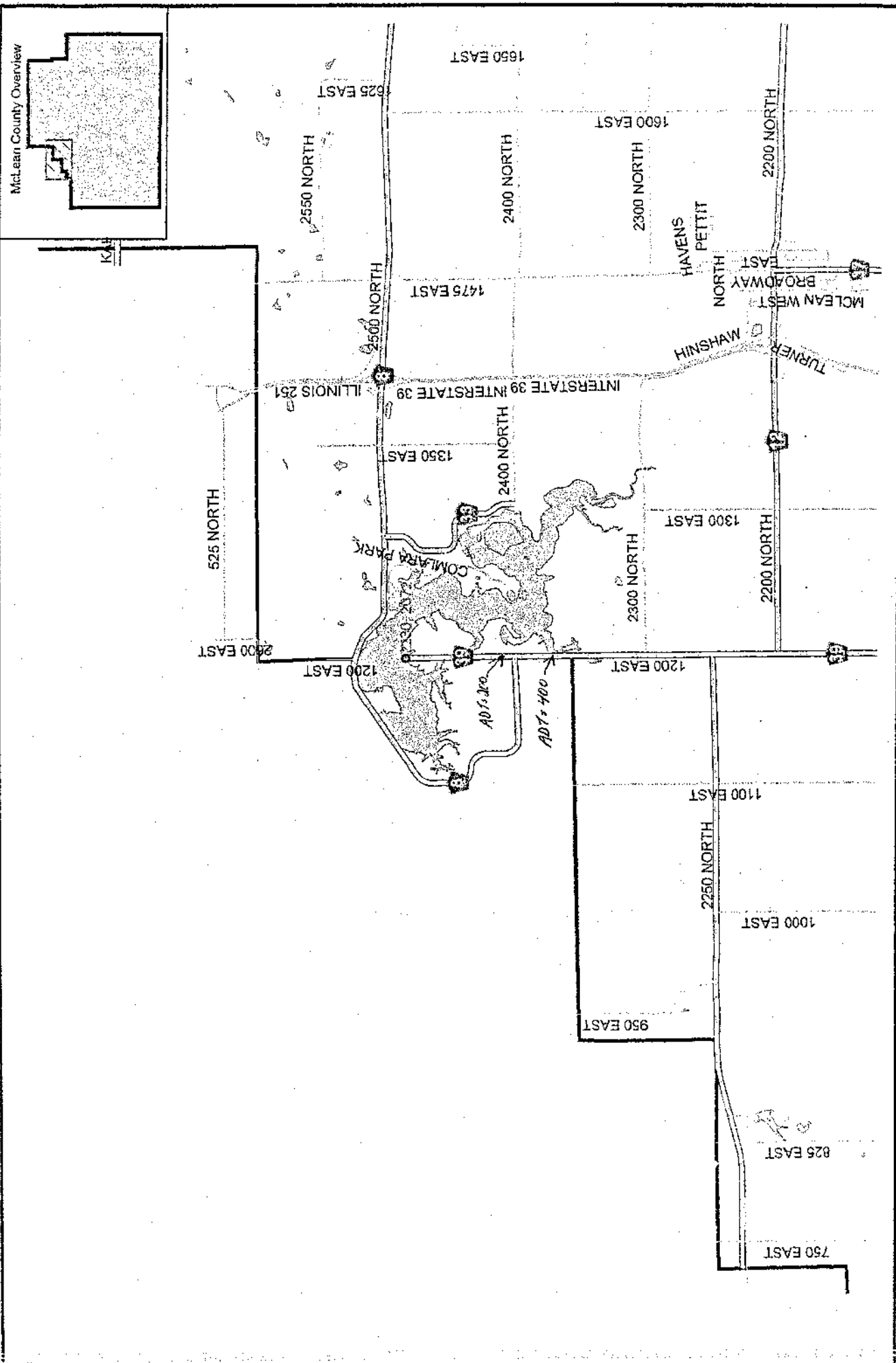

Accidents Location Report
McLean County Highway Department

