



EXECUTIVE COMMITTEE AGENDA
Room 400, Government Center

Monday, March 9, 2009

4:30 p.m.

1. Call to Order
2. Chairman's Approval of Minutes – February 10, 2009
January 20, 2009 Stand-Up Meeting
3. Appearance by Members of the Public
4. Departmental Matters
5. Report of Standing Committees:
 - A. Executive Committee – Chairman Sorensen
 - 1) Items to be Presented for Action:
 - a) REAPPOINTMENTS:

None
 - b) APPOINTMENTS:

EMERGENCY TELEPHONE SYSTEM BOARD

Interim Chief Randall D. McKinley
Bloomington Police Department
305 S. East Street
P.O. Box 3157
Bloomington, IL 61702-3157
(To complete a term to expire on January 20, 2011)

McLEAN COUNTY REGIONAL PLANNING COMMISSION

Mr. William C. Doud

1328 Crown Court

Bloomington, IL 61704

(Three-year term to expire on December 31, 2011)

c) RESIGNATIONS:

EMERGENCY TELEPHONE SYSTEM BOARD

Chief Roger Aikin

Bloomington Police Department

305 S. East Street

P.O. Box 3157

Bloomington, IL 61702-3157

- d) Request Approval of an Ordinance Amending "an Ordinance Describing and designating an area Located partially within the City of Bloomington, The Town of Normal and Unincorporated McLean County as an Enterprise Zone" 1-2
- e) Request Approval of an Amendment to Intergovernmental Agreement – Enterprise Zone 3-64
- 2) Items to be Presented to the Board:
 - a) General Report
 - b) Other

B. Finance Committee – Chairman Owens

- 1) Items to be Presented for Action:
 - a) Request Approval of an Emergency Appropriation Ordinance Amending the McLean County Fiscal Year 2008 Combined Annual Appropriation and Budget Ordinance, McLean County General Fund 0001, McLean County Information Technologies Department 0043 and McLean County Recorder Department 0006, McLean County Auditor's Office 65-66
 - b) Request Approval of an Emergency Appropriation Ordinance Amending the McLean County Fiscal Year 2009 Combined Annual Appropriation and Budget Ordinance, McLean County General Fund 0001, McLean County Information Technologies Department 0043 and McLean County Recorder Department 0006, McLean County Auditor's Office 67-68
- 2) Items to be Presented to the Board:
 - a) Request Approval of an Ordinance of the McLean County Board Amending Chapter 10 of the McLean County Code – County Administrator's Office

- b) Request Approval of Supplemental Election Judge List – County Clerk
 - c) General Report
 - d) Other

- C. Justice Committee – Chairman Renner
 - 1) Items to be Presented for Action:
 - a) Request Approval of an Emergency Appropriation Ordinance Amending the McLean County Fiscal Year 2009 Combined Annual Appropriation and budget Ordinance, General Fund 0001, Sheriff's Department 0029 69-72
 - b) Request Approval to apply for a \$50,000.00 Grant through the US Department of Justice for a Mental Health Court Planning Grant (20% match) – Court Services 73-75
 - 2) Items to be Presented to the Board:
 - a) Request Approval of a Contract between John J. Bussan, Special Public Defender, and the Public Defender's Office – Public Defender's Office
 - b) General Report
 - c) Other

- D. Land Use and Development Committee – Chairman Gordon
 - 1) Items to be Presented to the Board:
 - a) General Report
 - b) Other

- E. Property Committee – Chairman Bostic
 - 1) Items to be Presented for Action:
 - a) Request Approval of a Resolution of the McLean County Board in Memory and Recognition of the Late John W. English 76-78
 - 2) Items to be Presented to the Board:
 - a) General Report
 - b) Other

- F. Transportation Committee – Chairman Hoselton
 - 1) Items to be Presented for Action:
 - a) Request Approval to Apply for a White Oak Launch Safety Grant 79-82
 - 2) Items to be Presented to the Board:
 - a) Request Approval of Resolutions for Sec. 96-00306-00-SP – White Oak Road & Martin Luther King Jr. Dr. Intersection
 - (1) Resolution for Improvement, White Oak Road, Sec. 96-00306-00-SP) – MFT

- (2) Resolution Improvement, White Oak Road, Sec. 96-00306-00-SP) – Matching Tax Resolution
 - b) Request Approval of Timber Bridge Engineering Agreement with Hampton Lenzini & Renwick, Inc. (HLR)
 - c) General Report
 - d) Other
- G. Report of the County Administrator
 - 1) Items to be Presented for Action:
 - a) EXECUTIVE SESSION: Personnel Matters
 - 2) Items to be Presented to the Board:
 - a) General Report
 - b) Other
- 6. Other Business and Communications
- 7. Recommend Payment of Bills and Approval of Transfers, if any, to County Board
- 8. Adjournment

**AN ORDINANCE AMENDING "AN ORDINANCE DESCRIBING AND DESIGNATING
AN AREA LOCATED PARTIALLY WITHIN THE CITY OF BLOOMINGTON, THE
TOWN OF NORMAL AND UNINCORPORATED MCLEAN COUNTY AS AN
ENTERPRISE ZONE"**

WHEREAS, the County of McLean did on December 18, 1984, adopt an *Ordinance Describing and Designating an Area Located Partially within the City of Bloomington, Town of Normal and Unincorporated McLean County as an Enterprise Zone*; and

WHEREAS, the County of McLean did on numerous occasions after establishment of the Enterprise Zone, adopt Ordinances amending said Ordinance, including those lengthening the duration of the Enterprise Zone and amending the territory included within the Enterprise Zone; and

WHEREAS, the County of McLean now desires to amend the territory included within the Enterprise Zone and to memorialize the same by amending the Enterprise Zone Intergovernmental Agreement (as hereafter defined); and

WHEREAS, a public hearing regarding such amendments has been held as provided by law.

BE IT ORDAINED by the County Board of McLean County, Illinois as follows:

SECTION ONE: That Appendix "A", which is attached to the original *Ordinance Describing and Designating an Area Located Partially within the City of Bloomington, Town of Normal and Unincorporated McLean County as an Enterprise Zone* and incorporated by reference in Section One of said Ordinance, as amended by subsequent Ordinances modifying the boundary of the territory included within the Enterprise Zone, shall be, and the same is, hereby further amended by adding the territory described in Exhibit A to the territory of the Enterprise Zone.

SECTION TWO: That the Chairman of the Board of the County of McLean, Illinois shall have, and is hereby given authority to execute the Amendment to the Enterprise Zone Intergovernmental Agreement between the Town of Normal, Illinois, the City of Bloomington, Illinois, and the County of McLean, Illinois (the "Enterprise Zone Intergovernmental Agreement") attached hereto as Exhibit B, which Amendment memorializes the addition of the territory identified in this Ordinance to the territory of the Enterprise Zone.

SECTION THREE: That the provisions of said Ordinance as previously amended and as hereby amended, being an *Ordinance Describing and Designating an Area Located Partially within the City of Bloomington, the Town of Normal and Unincorporated McLean County as an Enterprise Zone* shall remain in full force and effect.

SECTION FOUR: That this Ordinance shall be in full force and effect from and after its passage and approval and publication as required by law and from and after its approval by the Illinois Department of Commerce and Economic Opportunity.

SECTION FIVE: That the County Clerk be and is hereby directed and authorized to publish this Ordinance in pamphlet form as required by law and forward a certified copy of this Ordinance to the Illinois Department of Commerce and Economic Opportunity for its approval and to file a certified copy of this Ordinance with the County Clerk for McLean County.

SECTION SIX: That this Ordinance is adopted pursuant to the authority granted the County of McLean by the Illinois Enterprise Zone Act.

SECTION SEVEN: That the Enterprise Zone Administrator is hereby authorized and directed to cause application to be made to the State of Illinois pursuant to the Illinois Enterprise Zone Act.

APPROVED this ____ day of _____, 2009.

ATTEST:

APPROVED:

Peggy Ann Milton, Clerk of the County
Board of McLean County, Illinois

Matt Sorensen
Chairman, McLean County Board

(SEAL)

AMENDMENT TO INTERGOVERNMENTAL AGREEMENT

This Amendment is entered into the ____ day of _____, 2009 by and between the City of Bloomington, a municipal corporation, the Town of Normal, a municipal corporation, and the County of McLean, a body politic and incorporate, pursuant to the authority granted under Article VII, Section 10 of the Illinois Constitution and State law.

WHEREAS, the parties entered into an Intergovernmental Agreement in December 1984, for the purpose of creating and operating an Enterprise Zone within the jurisdiction of said parties pursuant to the Illinois Enterprise Zone Act (the "Act"); and

WHEREAS, the Enterprise Zone was originally certified as an enterprise zone by the Department of Commerce and Economic Opportunity of the State of Illinois effective July 1, 1985; and

WHEREAS, the Enterprise Zone now encompasses approximately 8.2 square miles; and

WHEREAS, the Act allows an enterprise zone to encompass up to 13 square miles if the zone is a joint effort of three or more units of government; and

WHEREAS, it has been determined that certain additional territory contiguous to the Enterprise Zone totaling up to approximately .68 square miles would be benefited by being encompassed within the boundaries of said Enterprise Zone; and

WHEREAS, it would be in the best interests of the citizens of the City of Bloomington, Illinois, the Town of Normal, Illinois, and the County of McLean, Illinois that said additional territory be included in the Enterprise Zone.

NOW, THEREFORE, BE IT AGREED BETWEEN THE PARTIES AS FOLLOWS:

1. That Section 2 "Description" of the Intergovernmental Agreement, and the property described in Exhibit "E-1a" and incorporated in said Section by reference, as subsequently amended, be and the same is hereby amended to include therein the area described in Exhibit A attached hereto (the "Amended Area"), and the Amended Area is hereby designated as part of the Enterprise Zone pursuant to and in accordance with the Act, subject to the approval of the State as provided in the Act.

2. Except to the extent amended hereby, that all provisions, agreements, stipulations, rights, obligations, and duties set forth in the original Intergovernmental Agreement, as subsequently amended, are hereby ratified and confirmed, and are hereby applied to the Amended Area of the Enterprise Zone in their entirety.

THE UNDERSIGNED PARTIES HAVE CAUSED THIS AMENDMENT TO INTERGOVERNMENTAL AGREEMENT TO BE EXECUTED BY THEIR DULY DESIGNATED OFFICIALS, PURSUANT TO AUTHORITY CONFERRED BY THEIR RESPECTIVE GOVERNING BODIES THE DATE FIRST SHOWN ABOVE.

City of Bloomington
a Municipal Corporation

By: _____
Mayor

Attest:

City Clerk

County of McLean
a Body Politic and Corporate

By: _____
County Board Chairman

Attest:

County Clerk

Town of Normal
a Municipal Corporation

By: _____
Mayor

Attest:

City Clerk

EXHIBIT A

Legal Description of Territory Added to the Enterprise Zone

Exhibit A

Amended Area

NORMAL TOWNSHIP ENTERPRISE ZONE ADDITIONS

Part of Sections 4, 5, 6, 7, 8 and 9 in Township 24 North, Range 2 East of the Third Principal Meridian, McLean County, Illinois, described as follows:

Passive Enterprise Zone Extension

A part of the SW $\frac{1}{4}$ of Section 4, a part of the NW $\frac{1}{4}$ of Section 9 and a part of the SW $\frac{1}{4}$ of Section 9, being a tract of land 3 feet of even width lying 1.5 feet on each side of the following described centerline: Beginning at a point on the centerline of North Main Street/U.S. Route 51 lying 86.5 feet north of the south line of the N $\frac{1}{2}$ of the S $\frac{1}{2}$ of Section 9; thence northerly 3930.2 feet on the centerline of said Main Street and northerly extension thereof to the north line of the NW $\frac{1}{4}$ of said Section 9; thence westerly 1460.6 feet to the Point of Termination at the northwest corner of the NW $\frac{1}{4}$ of said Section 9.

Together with the following described tracts:

Public Road Area

The South 30 feet of Section 5; the West 30 feet of Section 5; the East 30 feet of Section 6; that part of the 60 feet wide public road located in the South 30 feet of the SW $\frac{1}{4}$ of Section 6; that part of the 60 feet wide public road located in the North 140 feet of the NW $\frac{1}{4}$ of Section 7; that part of the 60 feet wide public road located in the North 180 feet of the NE $\frac{1}{4}$ of Section 7; that part of the 60 feet wide public road located in the North 100 feet of the NW $\frac{1}{4}$ of Section 8; the North 30 feet of the NE $\frac{1}{4}$ of Section 8.

Together with the following described tract:

Turbine 17 & Access Drive

A part of the SE $\frac{1}{4}$ of Section 6 more particularly described as follows: Commencing at the southeast corner of the SE $\frac{1}{4}$ of Section 6; thence northerly 576.51 feet on the east line of said Section 6; thence N.90°-00'-00"W. 1324.41 feet to the Point of Beginning; thence S.00°-00'-00"W. 100 feet; thence N.90°-00'-00"W. 100 feet; thence N.00°-00'-00"E. 100 feet; thence S.90°-00'-00"E. 100 feet to the Point of Beginning.

Also a tract of land 50 feet of even width lying 25 feet on each side of the following described centerline: Commencing at the southeast corner of the SE $\frac{1}{4}$ of Section 6; thence northerly 576.51 feet on the east line of said Section 6; thence N.90°-00'-00"W. 1324.41 feet; thence S.00°-00'-00"W. 100 feet; thence N.00°-00'-00"E. 50 feet to the Point of Beginning; thence S.00°-00'-00"W. 550

feet to the Point of Termination at the centerline of the public road crossing through the North 180 feet of the NE¼ of Section 7.

Together with the following described tract:

Turbine 18 & Access Drive

A part of the SE¼ of Section 6 more particularly described as follows:

Commencing at the northeast corner of the SE¼ of Section 6; thence southerly 566.13 feet on the east line of said Section 6; thence N.90°-00'-00"W. 1386.21 feet to the Point of Beginning; thence S.00°-00'-00"E. 100 feet; thence N.90°-00'-00"W. 100 feet; thence N.00°-00'-00"E. 100 feet; thence S.90°-00'-00"E. 100 feet to the Point of Beginning.

Also a tract of land 50 feet of even width lying 25 feet on each side of the following described centerline: Commencing at the northeast corner of the SE¼ of Section 6; thence southerly 566.13 feet on the east line of said Section 6; thence N.90°-00'-00"W. 1436.21 feet to the Point of Beginning; thence N.00°-00'-00"E. 613.46 feet to the Point of Termination.

Together with the following described tract:

Turbine 19 & Access Drive

A part of the S½ of Section 6 more particularly described as follows:

Commencing at the northeast corner of the SE¼ of Section 6; thence northerly 160.33 feet on the east line of the NE¼ of said Section 6; thence N.90°-00'-00"W. 2221.10 feet to the Point of Beginning; thence continuing S.00°-00'-00"E. 100 feet; thence N.90°-00'-00"W. 100 feet; thence N.00°-00'-00"E. 100 feet; thence N.90°-00'-00"E. 100 feet to the Point of Beginning.

Also a tract of land 50 feet of even width lying 25 feet on each side of the following described centerline: Commencing at the northeast corner of the SE¼ of Section 6; thence southerly 25.01 feet on the east line of said SE¼ of Section 6 to the Point of Beginning; thence N.88°-06'-50"W. 2271.93 feet to the Point of Termination.

Together with the following described tract:

Turbine 20 & Access Drive

A part of the SW¼ of Section 6 more particularly described as follows:

Commencing at the southeast corner of the SW¼ of Section 6; thence westerly 905.04 feet on the south line of the SW¼ of Section 6; thence N.00°-00'-00"W. 1224.88 feet to the Point of Beginning; thence continuing N.00°-00'-00"W. 100 feet; thence N.90°-00'-00"E. 100 feet; thence S.00°-00'-00"E. 100 feet; thence N.90°-00'-00"W. 100 feet to the Point of Beginning.

Also a tract of land 50 feet of even width lying 25 feet on each side of the following described centerline: Commencing at the southeast corner of the SW¼ of Section 6; thence westerly 855.02 feet on the south line of the SW¼ of Section

6 to the Point of Beginning; thence N.00°-00'-00"W. 1226.35 feet to the Point of Termination.

Together with the following described tract:

Turbine 21 & Access Drive

A part of the SW¼ of Section 6 more particularly described as follows:

Commencing at the southwest corner of the SW¼ of Section 6; thence northerly 1920.19 feet on the west line of the SW¼ of said Section 6; thence N.90°-00'-00"E. 732.31 feet to the Point of Beginning; thence N.00°-00'-00"E. 100 feet; thence S.90°-00'-00"E. 100 feet; thence S.00°-00'-00"W. 100 feet; thence S.90°-00'-00"W. 100 feet to the Point of Beginning.

Also a tract of land 50 feet of even width lying 25 feet on each side of the following described centerline: Commencing at the southwest corner of the SW¼ of Section 6; thence northerly 1970.19 feet on the west line of the SW¼ of said Section 6 to the Point of Beginning; thence N.90°-00'-00"E. 732.22 feet to the Point of Termination.

Together with the following described tract:

Turbine 31 & Access Drive

A part of the NW¼ of Section 6 more particularly described as follows:

Commencing at the northwest corner of the NW¼ of Section 6; thence southerly 1505.94 feet on the west line of said Section 6; thence N.90°-00'-00"E. 2251.08 feet to the Point of Beginning; thence continuing N.90°-00'-00"E. 100 feet; thence S.00°-00'-00"E. 100 feet; thence S.90°-00'-00"W. 100 feet; thence N.00°-00'-00"W. 100 feet to the Point of Beginning.

Also a tract of land in the SE¼, in the SW¼ and in the NW¼ of Section 6 being 50 feet of even width lying 25 feet on each side of the following described centerline: Commencing at the northeast corner of the SE¼ of Section 6; thence southerly 25.01 feet on the east line of the SE¼ of said Section 6; thence N.88°-06'-50"W. 2271.93 feet parallel with the north line of the SE¼ of said Section 6 to the Point of Beginning; thence continuing N.88°-06'-50"W. 495.43 feet to a point lying 25 feet west of the east line of the SW¼ of said Section 6; thence N.01°-13'-03"E. 96.14 feet; thence N.88°-58'-24"W. 753.66 feet; thence N.26°-09'-58"W. 205.25 feet; thence northwesterly 228.69 feet on a tangential curve concave to the northeast having a radius of 350 feet, central angle of 37°-26'-13" and a chord of 224.64 feet bearing N.07°-26'-53"W. from the last described course; thence N.11°-16'-13"E. 176.56 feet; thence N.17°-37'-26"E. 232.74 feet; thence northeasterly 283.84 feet on a tangential curve concave to the southeast having a radius of 350 feet, central angle of 46°-27'-55" and a chord of 276.13 feet bearing N.40°-51'-52"E. from the last described course; thence N.64°-05'-51"E. 63.40 feet; thence N.00°-00'-00"W. 125.55 feet to the Point of Termination.

Together with the following described tract:

Turbine 32 & Access Drive

A part of the NE¼ of Section 6 more particularly described as follows:

Commencing at the northeast corner of the NE¼ of Section 6; thence southerly 888.11 feet on the east line of the NE¼ of said Section 6; thence N.90°-00'-00"W. 436.93 feet to the Point of Beginning; thence S.00°-00'-00"E. 100 feet; thence S.90°-00'-00"W. 100 feet; thence N.00°-00'-00"E. 100 feet; thence S.90°-00'-00"E. 100 feet to the Point of Beginning.

Also a tract of land 50 feet of even width lying 25 feet on each side of the following described centerline: Commencing at the northeast corner of the NE¼ of Section 6; thence southerly 938.10 feet on the east line of the NE¼ of said Section 6 to the Point of Beginning; thence N.90°-00'-00"W. 436.82 feet to the Point of Termination.

Together with the following described tract:

Energy Collection System Group

A part of Section 6 being a tract of land 20 feet of even width lying 10 feet on each side of the following described centerline: Commencing at the northeast corner of the NW¼ of Section 6; thence westerly 619.64 feet on the north line of said Section 6 to the Point of Beginning; thence S.00°-06'-48"W. 1517.52 feet; thence S.38°-19'-30"W. 2454.86 feet; thence S.57°-10'-30"E. 1386.00 feet; thence S.10°-07'-04"E. 1303.37 feet to the Point of Termination on the south line of said Section 6.

And also the following described tract:

A tract of land 20 feet of even width lying 10 feet of each side of the following described centerline: Commencing at the northeast corner of the NW¼ of Section 6; thence westerly 619.64 feet on the north line of said Section 6; thence S.00°-06'-48"W. 1517.52 feet to the Point of Beginning; thence N.79°-31'-18"E. 2859.56 feet to the Point of Termination.

And also the following described tract:

A tract of land 20 feet of even width lying 10 feet on each side of the following described centerline: Commencing at the northeast corner of the NW¼ of Section 6; thence westerly 619.64 feet on the north line of said Section 6; thence S.00°-06'-48"W. 1517.52 feet to the Point of Beginning; thence S.38°-26'-45"E. 1646.28 feet; thence S.48°-20'-18"E. 1115.45 feet to the Point of Termination.

And also the following described tract:

A tract of land 20 feet of even width lying 10 feet on each side of the following described centerline: Commencing at the southeast corner of the SW¼ of Section 6; thence westerly 625.96 feet on the south line of said Section 6; thence

N.10°-07'-04"W. 1303.37 feet to the Point of Beginning; thence S.69°-31'-29"E. 2447.95 feet to the Point of Termination.

Together with the following described tract:

Turbine 130 & Access Drive

A part of the NW¼ of Section 7 more particularly described as follows:

Commencing at the northeast corner of the NW¼ of Section 7; thence southerly 505.41 feet on the east line of the NW¼ of said Section 7; thence N.90°-00'-00"W. 472.84 feet to the Point of Beginning; thence S.00°-00'-00"W. 100 feet; thence N.90°-00'-00"W. 100 feet; thence N.00°-00'-00"E. 100 feet; thence N.90°-00'-00"E. 100 feet to the Point of Beginning.

Also a tract of land 50 feet of even width lying 25 feet on each side of the following described centerline: Commencing at the northeast corner of the NW¼ of Section 7; thence westerly 648.43 feet on the north line of the NW¼ of Section 7 to the Point of Beginning; thence S.00°-02'-56"W. 574.51 feet; thence N.90°-00'-00"E. 75.35 feet to the Point of Termination.

Together with the following described tract:

Turbine 140 & Access Drive

A part of the NW¼ of Section 7 more particularly described as follows:

Commencing at the northeast corner of the NW¼ of Section 7; thence southerly 1732.64 feet on the east line of the NW¼ of Section 7; thence S.90°-00'-00"W. 1205.97 feet to the Point of Beginning; thence S.00°-00'-00"W. 100 feet; thence N.90°-00'-00"W. 100 feet; thence N.00°-00'-00"E. 100 feet; thence N.90°-00'-00"E. 100 feet to the Point of Beginning.

Also a tract of land 50 feet of even width lying 25 feet on each side of the following described centerline: Commencing at the northeast corner of the NW¼ of Section 7; thence westerly 648.43 feet on the north line of the NW¼ of said Section 7; thence S.00°-02'-56"W. 574.51 feet to the Point of Beginning; thence continuing S.00°-02'-56"W. 744.68 feet; thence N.88°-18'-43"W. 609.18 feet; thence S.00°-00'-00"W. 450.30 feet to the Point of Termination.

Together with the following described tract:

Energy Collection System Group

A part of the NW¼ of Section 7 being a tract of land 20 feet of even width lying 10 feet on each side of the following described centerline: Commencing at the northeast corner of the NW¼ of Section 7; thence westerly 625.96 feet on the north line of the NW¼ of said Section 7 to the Point of Beginning; thence S.10°-07'-04"E. 582.92 feet; thence S.30°-55'-07"W. 1430.28 feet to the Point of Termination.

Said land area herein described in Normal Township containing 43 acres, more or less.

HUDSON TOWNSHIP ENTERPRISE ZONE ADDITIONS

Part of Sections 19, 30 and 31 in Township 25 North, Range 2 East of the Third Principal Meridian, McLean County, Illinois, described as follows:

Public Road Area

The South 30 feet of the SW¼ of Section 30; the North 30 feet of the NW¼ of Section 31.

Together with the following described tract:

Turbine 113 & Access Drive

A part of the NW¼ of Section 19 more particularly described as follows:
Commencing at the southwest corner of the NW¼ of Section 19; thence northerly 1429.44 feet on the west line of said Section 19; thence N.90°-00'-00"E. 1789.29 feet to the Point of Beginning; thence continuing N.90°-00'-00"E. 100 feet; thence S.00°-00'-00"E. 100 feet; thence N.90°-00'-00"W. 100 feet; thence N.00°-00'-00"E. 100 feet to the Point of Beginning;

Also a tract of land 50 feet of even width lying 25 feet on each side of the following described centerline: Commencing at the southwest corner of the NW¼ of Section 19; thence northerly 1379.44 feet on the west line of said Section 19 to the Point of Beginning; thence N.90°-00'-00"E. 1789.26 feet to the Point of Termination.

Together with the following described tract:

Turbine 89 & Access Drive

A part of the SW¼ of Section 19 more particularly described as follows:
Commencing at the northwest corner of the SW¼ of Section 19; thence southerly 1013.07 feet on the west line of said Section 19; thence N.90°-00'-00"E. 861.36 feet to the Point of Beginning; thence N.00°-00'-00"E. 100 feet; thence S.90°-00'-00"E. 100 feet; thence S.00°-00'-00"W. 100 feet; thence S.90°-00'-00"W. 100 feet to the Point of Beginning.

Also a tract of land 50 feet of even width lying 25 feet on each side of the following described centerline: Commencing at the northwest corner of the SW¼ of Section 19; thence southerly 963.07 feet on the west line of said Section 19 to the Point of Beginning; thence N.90°-00'-00"E. 861.36 feet to the Point of Termination.

Together with the following described tract:

Turbine 156 & Access Drive

A part of the NW¼ of Section 19 more particularly described as follows:

Commencing at the southwest corner of the NW¼ of Section 19; thence northerly 1158.84 feet on the west line of said Section 19; thence N.90°-00'-00"E. 762.25 feet to the Point of Beginning; thence N.00°-00'-00"W. 100 feet; thence S.90°-00'-00"E. 100 feet; thence S.00°-00'-00"W. 100 feet; thence S.90°-00'-00"W. 100 feet to the Point of Beginning.

Also a tract of land 50 feet of even width lying 25 feet on each side of the following described centerline: Commencing at the southwest corner of the NW¼ of Section 19; thence northerly 1379.44 feet on the west line of said Section 19; thence N.90°-00'-00"E. 812.36 feet to the Point of Beginning; thence S.00°-00'-00"E. 120.66 feet to the Point of Termination.

Together with the following described tract:

Energy Collection System Group

A part of the W½ of Section 19 being a tract of land 20 feet of even width lying 10 feet on each side of the following described centerline; Commencing at the southeast corner of the W½ of Section 19; thence westerly 1030.33 feet on the south line of Section 19 to the Point of Beginning; thence N.04°-06'-31"W. 930.46 feet; thence N.55°-29'-58"W. 1442.00 feet; thence N.21°-37'-17"E. 2519.81 feet; thence S.80°-34'-03"W. 1040.97 feet to the Point of Termination.

Together with the following described tract:

Turbine 72 & Access Drive

A part of the SW¼ of Section 30 more particularly described as follows:

Commencing at the northeast corner of the SW¼ of Section 30; thence southerly 1012.93 feet on the east line of the SW¼ of Section 30; thence N.90°-00'-00"W. 407.62 feet to the Point of Beginning; thence continuing N.90°-00'-00"W. 100 feet; thence N.00°-00'-00"E. 100 feet; thence S.90°-00'-00"E. 100 feet; thence S.00°-00'-00"E. 100 feet to the Point of Beginning.

Also a tract of land 50 feet of even width lying 25 feet on each side of the following described centerline: Commencing at the northwest corner of the SW¼ of Section 30; thence southerly 25 feet on the west line of said Section 30 to the Point of Beginning; thence easterly 2732.32 feet parallel with the north line of the SW¼ of said Section 30; thence S.00°-00'-00"E. 891.05 feet to the Point of Termination;

Together with the following described tract:

Turbine 73 & Access Drive

A part of the NW¼ of Section 30 more particularly described as follows:

Commencing at the southeast corner of the NW¼ of Section 30; thence northerly 1015.57 feet on the east line of the NW¼ of said Section 30; thence N.90°-00'-00"W. 855.64 feet to the Point of Beginning; thence continuing N.90°-00'-00"W.

100 feet; thence N.00°-00'-00"E. 100 feet; thence N.90°-00'-00"E. 100 feet; thence S.00°-00'-00"W. 100 feet to the Point of Beginning.

Also a tract of land 50 feet of even width lying 25 feet on each side of the following described centerline: Commencing at the southeast corner of the NW¼ of Section 30; thence northerly 1015.57 feet on the east line of the NW¼ of said Section 30; thence N.90°-00'-00"W. 905.64 feet to the Point of Beginning; thence S.00°-00'-00"W. 1009.44 feet to the Point of Termination on the south line of the NW¼ of said Section 30.

Together with the following described tract:

Turbine 74 & Access Drive

A part of the SW¼ of Section 30 more particularly described as follows: Commencing at the northwest corner of the SW¼ of Section 30; thence southerly 405.14 feet on the west line of said Section 30; thence N.90°-00'-00"E. 882.39 feet to the Point of Beginning; thence continuing N.90°-00'-00"E. 100 feet; thence S.00°-00'-00"E. 100 feet; thence S.90°-00'-00"W. 100 feet; thence N.00°-00'-00"W. 100 feet to the Point of Beginning.

Also a tract of land 50 feet of even width lying 25 feet on each side of the following described centerline: Commencing at the northwest corner of the SW¼ of Section 30; thence southerly 405.14 feet on the west line of said Section 30; thence N.90°-00'-00"E. 932.39 feet to the Point of Beginning; thence N.00°-00'-00"W. 348.82 feet to the Point of Termination lying 50 feet south of the north line of the SW¼ of said Section 30.

Together with the following described tract:

Energy Collection System Group

A part of the W½ of Section 30 being a tract of land 20 feet of even width lying 10 feet on each side of the following described centerline: Commencing at the southwest corner of Section 30; thence northerly 1457.31 feet on the west line of said Section 30 to the Point of Beginning; thence N.50°-15'-43"E. 1214.89 feet; thence S.73°-36'-54"E. 1876.93 feet to the Point of Termination.

And also the following described tract:

A part of the W½ of Section 30 being a tract of land 20 feet of even width lying 10 feet on each side of the following described centerline: Commencing at the southwest corner of Section 30; thence northerly 1457.31 feet on the west line of said Section 30; thence N.50°-15'-43"E. 1214.89 feet to the Point of Beginning; thence N.66°-32'-21"E. 1133.98 feet; thence N.16°-57'-57"E. 1095.23 feet; thence N.04°-06'-31"W. 1645.52 feet to the Point of Termination on the north line of the W½ of said Section 30.

Together with the following described tract:

Turbine 51 & Access Drive

A part of the NW¼ of Section 31 more particularly described as follows:

Commencing at the southwest corner of the NW¼ of Section 31; thence northerly 437.78 feet on the west line of said Section 31; thence N.90°-00'-00"E. 768.51 feet to the Point of Beginning; thence N.00°-00'-00"E. 100 feet; thence N.90°-00'-00"E. 100 feet; thence S.00°-00'-00"W. 100 feet; thence S.90°-00'-00"W. 100 feet to the Point of Beginning.

Also a tract of land 50 feet of even width lying 25 feet on each side of the following described centerline: Commencing at the southwest corner of the NW¼ of Section 31; thence northerly 437.78 feet on the west line of said Section 31; thence N.90°-00'-00"E. 818.51 feet to the Point of Beginning; thence S.00°-00'-00"E. 423.04 feet to a point lying 25 feet north of the south line of the NW¼ of said Section 31; thence westerly 818.68 feet parallel with the south line of the NW¼ of Section 31 to the Point of Termination on the west line of Section 31.

Together with the following described tract:

Turbine 52 & Access Drive

A part of the NW¼ of Section 31 more particularly described as follows:

Commencing at the southeast corner of the NW¼ of Section 31; thence westerly 425.41 feet on the south line of the NW¼ of said Section 31; thence N.00°-00'-00"E. 389.47 feet to the Point of Beginning; thence N.90°-00'-00"W. 100 feet; thence N.00°-00'-00"E. 100 feet; thence N.90°-00'-00"E. 100 feet; thence S.00°-00'-00"W. 100 feet to the Point of Beginning.

Also a tract of land 50 feet of even width lying 25 feet on each side of the following described centerline: Commencing at the southeast corner of the NW¼ of Section 31; thence westerly 425.41 feet on the south line of the NW¼ of said Section 31; thence N.00°-00'-00"E. 439.47 feet to the Point of Beginning; thence N.90°-00'-00"E. 405.65 feet to a point lying 25 feet west of the east line of the NW¼ of Section 31; thence N.00°-40'-52"E. 2214.18 feet parallel with the east line of the NW¼ of said Section 31 to the Point of Termination on the north line of the NW¼ of said Section 31.

Together with the following described tract:

Turbine 53 & Access Drive

A part of the NW¼ of Section 31 more particularly described as follows:

Commencing at the northeast corner of the NW¼ of Section 31; thence westerly 775.23 feet on the north line of the NW¼ of said Section 31; thence S.00°-00'-00"E. 636.73 feet to the Point of Beginning; thence continuing S.00°-00'-00"E. 100 feet; thence S.90°-00'-00"W. 100 feet; thence N.00°-00'-00"W. 100 feet; thence S.90°-00'-00"E. 100 feet to the Point of Beginning.

Also a tract of land 50 feet of even width lying 25 feet on each side of the following described centerline: Commencing at the northeast corner of the NW¼

of Section 31; thence westerly 775.23 feet on the north line of the NW¼ of said Section 31; thence S.00°-00'-00"E. 686.73 feet to the Point of Beginning; thence N.90°-00'-00"E. 717.11 feet to the Point of Termination lying 50 feet west of the east line of the NW¼ of Section 31.

Together with the following described tract:

Turbine 164 & Access Drive

A part of the SE¼ of Section 31 more particularly described as follows:

Commencing at the northwest corner of the SE¼ of Section 31; thence easterly 391.66 feet on the north line of the SE¼ of said Section 31; thence S.00°-00'-00"E. 650.43 feet to the Point of Beginning; thence continuing S.00°-00'-00"E. 100 feet; thence N.90°-00'-00"W. 100 feet; thence N.00°-00'-00"E. 100 feet; thence N.90°-00'-00"E. 100 feet to the Point of Beginning.

Also a tract of land 50 feet of even width lying 25 feet on each side of the following described centerline: Commencing at the northeast corner of the NW¼ of Section 31; thence westerly 25 feet on the north line of the NW¼ of said Section 31; thence S.00°-40'-52"W. 2214.18 feet parallel with the east line of the W½ of said Section 31 to the Point of Beginning; thence continuing S.00°-40'-52"W. 1154.95 feet parallel with the east line of the W½ of said Section 31; thence N.90°-00'-00"E. 325.93 feet to the Point of Termination.

Together with the following described tract:

Energy Collection System Group

A part of the NW¼ of Section 31 being a tract of land 20 feet of even width lying 10 feet on each side of the following described centerline: Commencing at the southwest corner of the NW¼ of Section 31; thence northerly 1280.48 feet on the west line of the NW¼ of Section 31 to the Point of Beginning; thence S.45°-53'-02"E. 1138.75 feet to the Point of Termination.

And also the following described tract:

A part of the W½ and a part of the SE¼ in Section 31 being a tract of land 20 feet of even width lying 10 feet on each side of the following described centerline: Commencing at the southeast corner of the SW¼ of Section 31; thence westerly 827.38 feet on the south line of Section 31 to the Point of Beginning; thence N.00°-06'-48"W. 658.53 feet; thence N.42°-36'-07"E. 1777.28 feet; thence N.35°-17'-38"W. 1413.18 feet; thence N.11°-44'-20"W. 1566.33 feet; thence N.82°-41'-07"W. 2384.41 feet to the Point of Termination on the west line of Section 31.

Said land area herein described in Hudson Township containing 32 acres, more or less.

DRY GROVE TOWNSHIP ENTERPRISE ZONE ADDITIONS

Part of Sections 1, 2, 3, 10, 11 and 12 in Township 24 North, Range 1 East of the Third Principal Meridian, McLean County, Illinois, described as follows:

Public Road Area

The North 30 feet of Section 1; the West 30 feet of Section 1; the South 30 feet of Section 1; the North 30 feet of Section 2; the West 30 feet of Section 2; the South 30 feet of Section 2; the East 30 feet of Section 2; the North 30 feet of Section 3 lying east of the centerline of U.S. Route 150; the East 30 feet of Section 3; the East 30 feet of Section 10 lying north of the centerline of U.S. Route 150; all that part of the existing public road lying north of the centerline of U.S. Route 150 in the NE¼ of Section 10; the West 30 feet of the NW¼ of Section 11 lying north of the centerline of U.S. Route 150; the North 30 feet of Section 11; the East 30 feet of the NE¼ of Section 11; the North 30 feet of Section 12; the West 30 feet of the NW¼ of Section 12.

Together with the following described tract:

Turbine 15 & Access Drive

A part of the SW¼ of Section 1 more particularly described as follows:

Commencing at the southwest corner of the SW¼ of Section 1; thence northerly 951.68 feet on the west line of said Section 1; thence N.90°-00'-00"E. 989.52 feet to the Point of Beginning; thence N.00°-00'-00"W. 100 feet; thence N.90°-00'-00"E. 100 feet; thence S.00°-00'-00"W. 100 feet; thence S.90°-00'-00"W. 100 feet to the Point of Beginning.

Also a tract of land 50 feet of even width lying 25 feet on each side of the following described centerline: Commencing at the southwest corner of the SW¼ of Section 1; thence northerly 951.68 feet on the west line of said Section 1; thence N.90°-00'-00"E. 1039.52 feet to the Point of Beginning; thence S.00°-00'-00"W. 965.05 feet to the Point of Termination on the south line of Section 1.

Together with the following described tract:

Turbine 22 & Access Drive

A part of the SW¼ of Section 1 more particularly described as follows:

Commencing at the southeast corner of the SW¼ of Section 1; thence westerly 443.53 feet on the south line of said Section 1; thence N.00°-00'-00"E. 1809.92 feet to the Point of Beginning; thence N.90°-00'-00"W. 100 feet; thence N.00°-00'-00"E. 100 feet; thence S.90°-00'-00"E. 100 feet; thence S.00°-00'-00"W. 100 feet to the Point of Beginning.

Also a tract of land in the SE¼ and in the SW¼ of Section 1 being 50 feet of even width lying 25 feet on each side of the following described centerline: Commencing at the southwest corner of the SE¼ of Section 1; thence easterly 25.01 feet to the Point of Beginning; thence N.00°-00'-50"E. 475.25 feet parallel with the west line of the SE¼ of said Section 1; thence N.89°-15'-25"W. 50.00 feet to a point lying 25 feet west of the east line of the SW¼ of said Section 1; thence N.00°-00'-37"E. 1390.37 feet parallel with the east line of the SW¼ of said Section 1; thence N.90°-00'-00"W. 418.86 feet to the Point of Termination.

Together with the following described tract:

Turbine 30 & Access Drive

A part of the NE¼ of Section 1 and a part of the NW¼ of Section 1 more particularly described as follows: Commencing at the southwest corner of the NE¼ of Section 1; thence westerly 76.88 feet on the south line of the NW¼ of said Section 1; thence N.00°-00'-00"E. 639.25 feet to the Point of Beginning; thence N.90°-00'-00"W. 100 feet; thence N.00°-00'-00"E. 100 feet; thence S.90°-00'-00"E. 100 feet; thence S.00°-00'-00"W. 100 feet to the Point of Beginning.

Also a tract of land in the NW¼ of Section 1 being 50 feet of even width lying 25 feet on each side of the following described centerline: Commencing at the northeast corner of the NW¼ of Section 1; thence westerly 25 feet on the north line of said Section 1 to the Point of Beginning; thence S.00°-01'-48"W. 1994.77 feet; thence N.90°-00'-00"W. 52.23 feet to the Point of Termination.

Together with the following described tract:

Turbine 33 & Access Drive

A part of the NE¼ of Section 1 more particularly described as follows: Commencing at the northwest corner of the NE¼ of Section 1; thence easterly 540.62 feet on the north line of said Section 1; thence S.00°-00'-00"E. 435.53 feet to the Point of Beginning; thence N.90°-00'-00"E. 100 feet; thence S.00°-00'-00"W. 100 feet; thence N.90°-00'-00"W. 100 feet; thence N.00°-00'-00"W. 100 feet to the Point of Beginning.

Also a tract of land 50 feet of even width lying 25 feet on each side of the following described centerline: Commencing at the northwest corner of the NE¼ of Section 1; thence easterly 540.62 feet on the north line of Section 1; thence S.00°-00'-00"E. 485.53 feet to the Point of Beginning; thence S.90°-00'-00"W. 540.81 feet to the Point of Termination on the west line of the NE¼ of Section 1.

Together with the following described tract:

Turbine 145 & Access Drive

A part of the SE¼ of Section 1 more particularly described as follows: Commencing at the southwest corner of the SE¼ of Section 1; thence easterly 844.55 feet on the south line of said Section 1; thence N.00°-00'-00"E. 1599.79 feet to the Point of Beginning; thence continuing N.00°-00'-00"E. 100 feet; thence

S.90°-00'-00"E. 100 feet; thence S.00°-00'-00"W. 100 feet; thence S.90°-00'-00"W. 100 feet to the Point of Beginning.

Also a tract of land 50 feet of even width lying 25 feet on each side of the following described centerline: Commencing at the southwest corner of the NE¼ of Section 1; thence easterly 1306.06 feet on the south line of said Section 1 to the Point of Beginning; thence N.00°-03'-16"E. 1660.91 feet; thence N.90°-00'-00"W. 362.96 feet to the Point of Termination.

Together with the following described tract:

Energy Collection System Group

A part of the NE¼, a part of the NW¼ and a part of the SW¼ of Section 1 being a tract of land 20 feet of even width lying 10 feet on each side of the following described centerline: Commencing at the northwest corner of the NE¼ of Section 1; thence easterly 579.96 feet on the north line of said Section 1 to the Point of Beginning; thence S.01°-15'-34"E. 485.03 feet; thence S.25°-35'-52"W. 1663.73 feet; thence S.13°-47'-12"W. 1540.60 feet; thence S.52°-46'-26"W. 1372.07 feet; thence S.09°-17'-06"E. 1030.71 feet to the Point of Termination on the south line of the SW¼ of Section 1.

And also the following described tract:

A part of the SW¼ of Section 1 being a tract of land 20 feet of even width lying 10 feet on each side of the following described centerline: Commencing at the northwest corner of the SW¼ of Section 1; thence southerly 447.15 feet on the west line of said Section 1 to the Point of Beginning; thence S.79°-15'-40"E. 2184.98 feet to the Point of Termination.

And also the following described tract:

A part of the SW¼ and a part of the SE¼ of Section 1 being a tract of land 20 feet of even width lying 10 feet on each side of the following described centerline: Commencing at the northwest corner of the SW¼ of Section 1; thence southerly 447.15 feet on the west line of said Section 1; thence S.79°-15'-40"E. 2184.98 feet to the Point of Beginning; thence S.80°-20'-24"E. 1407.75 feet to the Point of Termination.

Together with the following described tract:

Turbine 14 & Access Drive

A part of the SW¼ of Section 2 more particularly described as follows: Commencing at the southwest corner of the SW¼ of Section 2; thence northerly 1006.13 feet on the west line of said Section 2; thence N.90°-00'-00"E. 1062.99 feet to the Point of Beginning; thence continuing N.90°-00'-00"E. 100 feet; thence S.00°-00'-00"W. 100 feet; thence N.90°-00'-00"W. 100 feet; thence N.00°-00'-00"E. 100 feet to the Point of Beginning.

Also a tract of land 50 feet of even width lying 25 feet on each side of the following described centerline: Commencing at the southeast corner of the SW¼ of Section 1; thence westerly 1288.18 feet on the south line of said Section 2 to the Point of Beginning; thence N.00°-05'-56"W. 967.83 feet; thence S.90°-00'-00"W. 64.69 feet to the Point of Termination.

Together with the following described tract:

Turbine 24 & Access Drive

A part of the SE¼ of Section 2 more particularly described as follows: Commencing at the northeast corner of the SE¼ of Section 2; thence westerly 462.29 feet on the north line of the SE¼ of said Section 2; thence S.00°-00'-00"E. 306.68 feet to the Point of Beginning; thence continuing S.00°-00'-00"E. 100 feet; thence N.90°-00'-00"W. 100 feet; thence N.00°-00'-00"W. 100 feet; thence N.90°-00'-00"E. 100 feet to the Point of Beginning.

Also a tract of land 50 feet of even width lying 25 feet on each side of the following described centerline: Commencing at the northeast corner of the SE¼ of Section 2; thence southerly 349.03 feet on the east line of said Section 2 to the Point of Beginning; thence N.90°-00'-00"W. 466.21 feet to the Point of Termination.

Together with the following described tract:

Turbine 25 & Access Drive

A part of the SE¼ of Section 2 more particularly described as follows: Commencing at the northwest corner of the SE¼ of Section 2; thence southerly 935.02 feet on the west line of the SE¼ of said Section 2; thence N.90°-00'-00"E. 243.42 feet to the Point of Beginning; thence continuing N.90°-00'-00"E. 100 feet; thence N.00°-00'-00"W. 100 feet; thence S.90°-00'-00"W. 100 feet; thence S.00°-00'-00"E. 100 feet to the Point of Beginning.

Also a tract of land 50 feet of even width lying 25 feet on each side of the following described centerline: Commencing at the northwest corner of the SE¼ of Section 2; thence southerly 935.02 feet on the west line of the SE¼ of said Section 2; thence N.90°-00'-00"E. 343.42 feet to the Point of Beginning; thence S.38°-35'-24"E. 623.40 feet to the Point of Termination.

Together with the following described tract:

Turbine 26 & Access Drive

A part of the SW¼ of Section 2 more particularly described as follows: Commencing at the northwest corner of the SW¼ of Section 2; thence easterly 1878.43 feet on the north line of the SW¼ of said Section 2; thence S.00°-00'-00"E. 395.98 feet to the Point of Beginning; thence N.90°-00'-00"E. 100 feet; thence S.00°-00'-00"E. 100 feet; thence S.90°-00'-00"W. 100 feet; thence N.00°-00'-00"W. 100 feet to the Point of Beginning.

Also a tract of land 50 feet of even width lying 25 feet on each side of the following described centerline: Commencing at the southeast corner of the SW¼ of Section 2; thence westerly 1288.18 feet on the south line of said Section 2; thence N.00°-05'-56"W. 967.83 feet to the Point of Beginning; thence continuing N.00°-05'-56"W. 1279.53 feet; thence S.90°-00'-00"E. 526.50 feet to the Point of Termination.

Together with the following described tract:

Turbine 29 & Access Drive

A part of the NE¼ of Section 2 more particularly described as follows: Commencing at the southeast corner of the NE¼ of Section 2; thence westerly 1441.69 feet on the south line of the NE¼ of said Section 2; thence N.00°-00'-00"E. 436.63 feet to the Point of Beginning; thence continuing N.00°-00'-00"E. 100 feet; thence S.90°-00'-00"E. 100 feet; thence S.00°-00'-00"W. 100 feet; thence N.90°-00'-00"W. 100 feet to the Point of Beginning.

Also a tract of land 50 feet of even width lying 25 feet on each side of the following described centerline: Commencing at the southeast corner of the NE¼ of Section 2; thence northerly 694.53 feet on the east line of said Section 2 to the Point of Beginning; thence N.90°-00'-00"W. 1383.57 feet; thence S.00°-00'-00"W. 133.91 feet to the Point of Termination.

Together with the following described tract:

Turbine 35 & Access Drive

A part of the NW¼ of Section 2 more particularly described as follows: Commencing at the northeast corner of the NW¼ of Section 2; thence southerly 726.26 feet on the east line of the NW¼ of said Section 2; thence N.90°-00'-00"W. 549.98 feet to the Point of Beginning; thence continuing N.90°-00'-00"W. 100 feet; thence N.00°-00'-00"E. 100 feet; thence S.90°-00'-00"E. 100 feet; thence S.00°-00'-00"W. 100 feet to the Point of Beginning.

Also a tract of land 50 feet of even width lying 25 feet on each side of the following described centerline: Commencing at the northeast corner of the NW¼ of Section 2; thence westerly 593.64 feet on the north line of said Section 2 to the Point of Beginning; thence S.00°-00'-00"W. 635.63 feet to the Point of Termination.

Together with the following described tract:

Turbine 155 & Access Drive

A part of the NW¼ of Section 2 more particularly described as follows: Commencing at the northeast corner of the NW¼ of Section 2; thence southerly 2004.26 feet on the east line of the NW¼ of said Section 2; thence N.90°-00'-00"W. 167.57 feet to the Point of Beginning; thence S.00°-00'-00"E. 100 feet; thence S.90°-00'-00"W. 100 feet; thence N.00°-00'-00"E. 100 feet; thence S.90°-00'-00"E. 100 feet to the Point of Beginning.

Also a tract of land 50 feet of even width lying 25 feet on each side of the following described centerline: Commencing at the northeast corner of the NW¼ of Section 2; thence westerly 25.01 feet on the north line of Section 2 to the Point of Beginning; thence southerly 2054.66 feet parallel with the east line of the NW¼ of said Section 2; thence N.90°-00'-00"W. 143.01 feet to the Point of Termination.

Together with the following described tract:

Turbine 161 & Access Drive

A part of the SE¼ of Section 2 more particularly described as follows:

Commencing at the southeast corner of the SE¼ of Section 2; thence northerly 1207.60 feet on the east line of said Section 2; thence N.90°-00'-00"W. 1811.10 feet to the Point of Beginning; thence continuing N.90°-00'-00"W. 100 feet; thence N.00°-00'-00"E. 100 feet; thence S.90°-00'-00"E. 100 feet; thence S.00°-00'-00"W. 100 feet to the Point of Beginning.

Also a tract of land 50 feet of even width lying 25 feet on each side of the following described centerline: Commencing at the southeast corner of the SE¼ of Section 2; thence northerly 1317.99 feet on the east line of said Section 2 to the Point of Beginning; thence S.89°-15'-10"E. 1835.00 feet; thence S.00°-00'-00"E. 37.97 feet to the Point of Termination.

Together with the following described tract:

Energy Collection System Group

A part of the SW¼, a part of the SE¼, a part of the NE¼ and a part of the NW¼, all in Section 2 being a tract of land 20 feet of even width lying 10 feet on each side of the following described centerline: Commencing at the southeast corner of the SW¼ of Section 2; thence westerly 1394.64 feet on the south line of said Section 2 to the Point of Beginning; thence N.00°-35'-14"W. 966.87 feet; thence N.83°-20'-44"E. 2180.04 feet; thence N.50°-58'-50"E. 1714.46 feet; thence N.45°-38'-55"W. 1229.63 feet; thence N.84°-00'-39"W. 1477.88 feet; thence N.15°-56'-43"W. 1433.09 feet; thence N.23°-27'-04"E. 742.27 feet to the Point of Termination on the north line of the NW¼ of Section 2.

Also the following described tract:

A part of the SW¼ and a part of the NW¼ of Section 2 being a tract of land 20 feet of even width lying 10 feet on each side of the following described centerline: Commencing at the southwest corner of the SW¼ of Section 2; thence northerly 823.35 feet on the west line of Section 2 to the Point of Beginning; thence N.83°-42'-11"E. 1121.26 feet; thence N.26°-04'-56"E. 2611.77 feet to the Point of Termination.

And also the following described tract:

A part of the SE $\frac{1}{4}$ of Section 2 being a tract of land 20 feet of even width lying 10 feet on each side of the following described centerline: Commencing at the northeast corner of the SE $\frac{1}{4}$ of Section 2; thence southerly 447.15 feet on the east line of Section 2 to the Point of Beginning; thence N.79°-15'-40"W. 526.55 feet to the Point of Termination.

Together with the following described tract:

Turbine 13 & Access Drive

A part of the SE $\frac{1}{4}$ of Section 3 more particularly described as follows:

Commencing at the southwest corner of the SE $\frac{1}{4}$ of Section 3; thence easterly 862.21 feet on the south line of said Section 3; thence N.00°-00'-00"E. 583.05 feet to the Point of Beginning; thence continuing N.00°-00'-00"E. 100 feet; thence S.90°-00'-00"E. 100 feet; thence S.00°-00'-00"W. 100 feet; thence N.90°-00'-00"W. 100 feet to the Point of Beginning.

Also a tract of land 50 feet of even width lying 25 feet on each side of the following described centerline: Commencing at the southeast corner of the SE $\frac{1}{4}$ of Section 3; thence westerly 552.90 feet on the south line of said Section 31 to the westerly right of way line of U.S. Route 150; thence northwesterly 30.06 feet on said right of way line of U.S. Route 150 to the Point of Beginning; thence westerly 1163.11 feet parallel with the south line of said Section 3; thence N.00°-28'-55"E. 558.28 feet to the Point of Termination.

Together with the following described tract:

Turbine 27 & Access Drive

A part of the SW $\frac{1}{4}$ of Section 3 more particularly described as follows:

Commencing at the southeast corner of the SW $\frac{1}{4}$ of Section 3; thence westerly 674.94 feet on the south line of said Section 3; thence N.00°-00'-00"E. 1097.80 feet to the Point of Beginning; thence N.90°-00'-00"W. 100 feet; thence N.00°-00'-00"E. 100 feet; thence S.90°-00'-00"E. 100 feet; thence S.00°-00'-00"W. 100 feet to the Point of Beginning.

Also a tract of land in the SE $\frac{1}{4}$ and in the SW $\frac{1}{4}$ of Section 3 being 50 feet of even width lying 25 feet on each side of the following described centerline: Commencing at the southeast corner of the SE $\frac{1}{4}$ of Section 3; thence westerly 552.90 feet on the south line of said Section 3 to the westerly right of way line of U.S. Route 150; thence northwesterly 30.06 feet on said right of way line of U.S. Route 150; thence westerly 1163.11 feet parallel with the south line of said Section 3 to the Point of Beginning; thence continuing westerly 937.16 feet parallel with the south line of Section 3 to a point 25 feet west of the southeast corner of the SW $\frac{1}{4}$ of said Section 3; thence N.00°-07'-01"E. 1290.51 feet parallel with the east line of the SW $\frac{1}{4}$ of Section 3; thence N.89°-57'-29"W. 702.62 feet; thence S.00°-00'-0"E. 120.87 feet to the Point of Termination.

Together with the following described tract:

Turbine 142 & Access Drive

A part of the NE¼ of Section 3 more particularly described as follows:

Commencing at the northwest corner of the NE¼ of Section 3; thence southerly 446.98 feet on the west line of the NE¼ of said Section 3; thence N.90°-00'-00"E. 745.82 feet to the Point of Beginning; thence continuing N.90°-00'-00"E. 100 feet; thence S.00°-00'-00"E. 100 feet; thence N.90°-00'-00"W. 100 feet; thence N.00°-00'-00"E. 100 feet to the Point of Beginning.

Also a tract of land 50 feet of even width lying 25 feet on each side of the following described centerline: Commencing at the northwest corner of the NE¼ of Section 3; thence easterly 794.99 feet on the north line of said Section 3 to the Point of Beginning; thence S.00°-00'-00"W. 435.22 feet to the Point of Termination.

Together with the following described tract:

Turbine 163 & Access Drive

A part of the SW¼ of Section 3 more particularly described as follows:

Commencing at the southwest corner of the SW¼ of Section 3; thence easterly 524.13 feet on the south line of said Section 3; thence N.00°-00'-00"E. 52.29 feet to the Point of Beginning; thence continuing N.00°-00'-00"E. 100 feet; thence S.90°-00'-00"E. 100 feet; thence S.00°-00'-00"W. 100 feet; thence N.90°-00'-00"W. 100 feet to the Point of Beginning.

Also a tract of land 50 feet of even width lying 25 feet on each side of the following described centerline: Commencing at the southeast corner of the SW¼ of Section 3; thence westerly 908.67 feet to the Point of Beginning; thence N.00°-00'-00"E. 25 feet; thence S.89°-41'-54"W. 1164.71 feet parallel with the south line of said Section 3; thence N.00°-00'-00"E. 27.03 feet to the Point of Termination.

Together with the following described tract:

Energy Collection System Group

A part of the SW¼ of Section 3 being a tract of land 20 feet of even width lying 10 feet on each side of the following described centerline: Commencing at the southeast corner of the SW¼ of Section 3; thence westerly 851.33 feet on the south line of said Section 3 to the Point of Beginning; thence N.06°-16'-43"E. 1155.66 feet to the Point of Termination.

And also the following described tract:

A part of the SW¼ of Section 3 being a tract of land 20 feet of even width lying 10 feet on each side of the following described centerline: Commencing at the southwest corner of the SW¼ of Section 3; thence easterly 764.89 feet to the Point of Beginning; thence N.62°-05'-43"W. 215.86 feet to the Point of Termination.

And also the following described tract:

A part of the SE¼ and a part of the SW¼ of Section 3 being a tract of land 20 feet of even width lying 10 feet on each side of the following described centerline: Commencing at the southeast corner of the SE¼ of Section 3; thence northerly 823.35 feet on the east line of said Section 3 to the Point of Beginning; thence S.83°-42'-11"W. 1750.39 feet; thence S.57°-36'-57"W. 1175.46 feet to the Point of Termination on the south line of Section 3.

And also the following described tract;

A part of the NE¼ of Section 3 being a tract of land 20 feet of even width lying 10 feet on each side of the following described centerline: Commencing at the northwest corner of the NE¼ of Section 3; thence easterly 868.84 feet on the north line of said Section 3 to the Point of Beginning; thence S.08°-40'-19"W. 489.73 feet to the Point of Termination.

Together with the following described tract:

Turbine 12 & Access Drive

A part of the NW¼ of Section 10 more particularly described as follows: Commencing at the southeast corner of the NW¼ of Section 10; thence northerly 1098.60 feet on the east line of the NW¼ of said Section 10; thence N.90°-00'-00"W. 72.93 feet to the Point of Beginning; thence continuing N.90°-00'-00"W. 100 feet; thence N.00°-00'-00"E. 100 feet; thence N.90°-00'-00"E. 100 feet; thence S.00°-00'-00"W. 100 feet to the Point of Beginning.

Also a tract of land 50 feet of even width lying 25 feet on each side of the following described centerline: Commencing at the northeast corner of the NW¼ of Section 10; thence westerly 25 feet on the north line of Section 10 to the Point of Beginning; thence southerly 1546.69 feet parallel with the east line of the NW¼ of said Section 10; thence N.90°-00'-00"W. 48.09 feet to the Point of Termination.

Together with the following described tract:

Turbine 129 & Access Drive

A part of the NW¼ of Section 10 more particularly described as follows: Commencing at the northwest corner of the NW¼ of Section 10; thence easterly 1688.84 feet on the north line of said Section 10; thence S.00°-00'-00"E. 470.65 feet to the Point of Beginning; thence N.90°-00'-00"E. 100 feet; thence S.00°-00'-00"E. 100 feet; thence S.90°-00'-00"W. 100 feet; thence N.00°-00'-00"W. 100 feet to the Point of Beginning.

Also a tract of land 50 feet of even width lying 25 feet on each side of the following described centerline: Commencing at the northwest corner of the NW¼ of Section 10; thence easterly 1738.71 feet on the north line of said Section 10 to

the Point of Beginning; thence S.00°-00'-00"W. 445.92 feet to the Point of Termination.

Also a tract of land 50 feet of even width lying 25 feet on each side of the following described centerline: Commencing at the northwest corner of NW¼ of Section 10; thence easterly 1738.71 feet on the north line of said Section 10 to the Point of Beginning; thence N.89°-41'-52"E. 883.60 feet parallel to the north line of said Section 10 to the Point of Termination.

Together with the following described tract:

Turbine 143 & Access Drive

A part of the NE¼ of Section 10 more particularly described as follows:

Commencing at the northwest corner of the NE¼ of Section 10; thence easterly 767.06 feet on the north line of said Section 10; thence S.00°-00'-00"E. 1453.02 feet to the Point of Beginning; thence N.90°-00'-00"E. 100 feet; thence S.00°-00'-00"E. 100 feet; thence S.90°-00'-00"W. 100 feet; thence N.00°-00'-00"E. 100 feet to the Point of Beginning.

Also a tract of land 50 feet of even width lying 25 feet on each side of the following described centerline: Commencing at the northwest corner of the NE¼ of Section 10; thence southerly 1506.69 feet on the west line of the NE¼ of said Section 10 to the Point of Beginning; thence S.90°-00'-00"E. 796.67 feet to the Point of Termination.

Together with the following described tract:

Energy Collection System Group

A part of the NW¼ and a part of the NE¼ of Section 10 being a tract of land 20 feet of even width lying 10 feet on each side of the following described centerline: Commencing at the northwest corner of the NW¼ of Section 10; thence easterly 764.89 feet on the north line of said Section 10 to the Point of Beginning; thence S.62°-05'-43"E. 1102.08 feet; thence S.37°-24'-17"E. 1285.45 feet; thence N.87°-34'-02"E. 945.73 feet to the Point of Termination.

And also the following described tract:

A part of the NW¼ of Section 10 being a tract of land 20 feet of even width lying 10 feet on each side of the following described centerline: Commencing at the northwest corner of the NW¼ of Section 10; thence easterly 764.89 feet on the north line of Section 10; thence S.62°-05'-43"E. 1102.08 feet to the Point of Beginning; thence N.06°-16'-43"E. 524.34 feet to the Point of Termination on the north line of the NW¼ of Section 10.

And also the following described tract:

A part of the NW¼ of Section 10 being a tract of land 20 feet of even width lying 10 feet on each side of the following described centerline: Commencing at the

northwest corner of the NW¼ of Section 10; thence easterly 764.89 feet on the north line of said Section 10; thence S.62°-05'-43"E. 1102.08 feet to the Point of Beginning; thence N.57°-36'-57"E. 980.75 feet to the Point of Termination on the north line of the NW¼ of Section 10.

Together with the following described tract:

Turbine 1 & Access Drive

A part of the SW¼ of Section 11 more particularly described as follows:

Commencing at the northwest corner of the SW¼ of Section 11; thence southerly 200.38 feet on the west line of said Section 11; thence N.90°-00'-00"E. 550.67 feet to the Point of Beginning; thence continuing N.90°-00'-00"E. 100 feet; thence S.00°-00'-00"W. 100 feet; thence N.90°-00'-00"W. 100 feet; thence N.00°-00'-00"E. 100 feet to the Point of Beginning.

Also a tract of land in the NW¼ and in the SW¼ of Section 11 being 50 feet of even width lying 25 feet on each side of the following described centerline: Beginning at the point of intersection of the southwesterly right of way line of U.S. Route 150 and a line lying 25 feet south of the north line of the SW¼ of Section 11; thence S.89°-48'-50"W. 615.90 feet parallel with the north line of the SW¼ of said Section 11; thence S.00°-00'-00"E. 173.52 feet to the Point of Termination.

Together with the following described tract:

Turbine 9 & Access Drive

A part of the NE¼ of Section 11 more particularly described as follows:

Commencing at the northwest corner of the NE¼ of Section 11; thence southerly 1798.52 feet on the west line of the NE¼ of said Section 11; thence N.90°-00'-00"E. 955.16 feet to the Point of Beginning; thence continuing N.90°-00'-00"E. 100 feet; thence S.00°-00'-00"E. 100 feet; thence N.90°-00'-00"W. 100 feet; thence N.00°-00'-00"E. 100 feet to the Point of Beginning.

Also a tract of land 50 feet of even width lying 25 feet on each side of the following described centerline: Commencing at the northwest corner of the NE¼ of Section 11; thence easterly 1320.86 feet on the north line of said Section 11 to the Point of Beginning lying 25 feet west of the east line of the W½ of said Section 11; thence southerly 1271.97 feet parallel with the east line of the W½ of the NE¼ of Section 11; thence S.52°-12'-33"W. 315.07 feet; thence S.09°-09'-40"W. 324.68 feet to the Point of Termination.

Together with the following described tract:

Turbine 10 & Access Drive

A part of the NW¼ of Section 11 more particularly described as follows:

Commencing at the northeast corner of the NW¼ of Section 11; thence southerly 2046.22 feet on the east line of the NW¼ of said Section 11; thence N.90°-00'-00"W. 745.12 feet to the Point of Beginning; thence continuing N.90°-00'-00"W. 100 feet; thence N.00°-00'-00"E. 100 feet; thence S.90°-00'-00"E. 100 feet; thence S.00°-00'-00"W. 100 feet to the Point of Beginning.

Also a tract of land 50 feet of even width lying 25 feet on each side of the following described centerline: Beginning on the northeasterly right of way line of U.S. Route 150 at a point lying 25 feet west of the east line of the W½ of the NW¼ of Section 11; thence N.00°-34'-58"W. 583.36 feet; thence N.90°-00'-00"E. 469.39 feet to the Point of Termination.

Together with the following described tract:

Turbine 11 & Access Drive

A part of the NW¼ of Section 11 more particularly described as follows: Commencing at the northwest corner of the NW¼ of Section 11; thence easterly 1094.78 feet on the north line of said Section 11; thence S.00°-00'-00"E. 1224.34 feet to the Point of Beginning; thence N.90°-00'-00"E. 100 feet; thence S.00°-00'-00"E. 100 feet; thence S.90°-00'-00"W. 100 feet; thence N.00°-00'-00"W. 100 feet to the Point of Beginning.

Also a tract of land 50 feet of even width lying 25 feet on each side of the following described centerline: Commencing at the northeasterly right of way line of U.S. Route 150 at a point lying 25 feet west of the east line of the W½ of the NW¼ of Section 11; thence N.00°-34'-58"W. 583.36 feet to the Point of Beginning; thence continuing N.00°-34'-58"W. 734.95 feet; thence N.90°-00'-00"W. 56.34 feet to the Point of Termination.

Together with the following described tract:

Turbine 144 & Access Drive

A part of the NE¼ of Section 11 more particularly described as follows: Commencing at the southwest corner of the NE¼ of Section 11; thence easterly 85.29 feet on the south line of the NE¼ of said Section 11; thence N.00°-00'-00"E. 738.92 feet to the Point of Beginning; thence continuing N.00°-00'-00"E. 100 feet; thence N.90°-00'-00"E. 100 feet; thence S.00°-00'-00"E. 100 feet; thence S.90°-00'-00"W. 100 feet to the Point of Beginning.

Also a tract of land 50 feet of even width lying 25 feet on each side of the following described centerline: Commencing at the southwest corner of the NE¼ of Section 11; thence easterly 85.29 feet on the south line of the NE¼ of said Section 11; thence N.00°-00'-00"E. 738.92 feet; thence S.90°-00'-00"E. 100 feet; thence N.00°-00'-00"E. 52.51 feet to the Point of Beginning; thence N.87°-07'-36"E. 750.68 feet to the Point of Termination.

Together with the following described tract:

Energy Collection System Group

A part of the SW¼, a part of the NW¼ and a part of the NE¼ of Section 11 being a tract of land 20 feet of even width lying 10 feet on each side of the following described centerline: Commencing at the northwest corner of the SW¼ of Section 11; thence southerly 200.38 feet on the west line of said Section 11; thence N.90°-00'-00"E. 650.67 feet to the Point of Beginning; thence N.52°-00'-

14"E. 1439.47 feet; thence N.83°-39'-36"E. 950.69 feet; thence N.87°-07'-36"E. 850.81 feet; thence S.80°-54'-46"E. 1624.87 feet to the Point of Termination on the east line of the NE¼ of Section 11.

And also the following described tract:

A part of the NW¼ of Section 11 being a tract of land 20 feet of even width lying 10 feet on each side of the following described centerline: Commencing at the northeast corner of the NW¼ of Section 11; thence westerly 1394.64 feet on the north line of Section 11 to the Point of Beginning; thence S.00°-35'-14"E. 1274.06 feet; thence S.40°-44'-53"E. 970.06 feet to the Point of Termination.

Together with the following described tract:

Turbine 148 & Access Drive

A part of the NW¼ of Section 12 more particularly described as follows: Commencing at the southwest corner of the NW¼ of Section 12; thence northerly 463.83 feet on the west line of said Section 12; thence N.90°-00'-00"E. 529.51 feet to the Point of Beginning; thence N.00°-00'-00"E. 100 feet; thence N.90°-00'-00"E. 100 feet; thence S.00°-00'-00"W. 100 feet; thence S.90°-00'-00"W. 100 feet to the Point of Beginning.

Also a tract of land 50 feet of even width lying 25 feet on each side of the following described centerline: Commencing at the southwest corner of the NW¼ of Section 12; thence northerly 513.83 feet on the west line of Section 12 to the Point of Beginning; thence S.90°-00'-00"E. 529.94 feet to the Point of Termination.

Together with the following described tract:

Turbine 149 & Access Drive

A part of the NW¼ of Section 12 more particularly described as follows: Commencing at the southwest corner of the NW¼ of Section 12; thence easterly 1453.15 feet on the south line of the NW¼ of said Section 11; thence N.00°-00'-00"E. 1255.82 feet to the Point of Beginning; thence S.90°-00'-00"W. 100 feet; thence N.00°-00'-00"E. 100 feet; thence S.90°-00'-00"E. 100 feet; thence S.00°-00'-00"W. 100 feet to the Point of Beginning.

Also a tract of land 50 feet of even width lying 25 feet on each side of the following described centerline: Beginning at the northeast corner of the NW¼ of Section 12; thence southerly 1372.55 feet on the east line of the NW¼ of said Section 12; thence N.90°-00'-00"W. 1151.51 feet to the Point of Termination.

Together with the following described tract:

Turbine 150 & Access Drive

A part of the NE¼ of Section 12 more particularly described as follows: Commencing at the southwest corner of the NE¼ of Section 12; thence easterly 770.64 feet on the south line of the NE¼ of said Section 12; thence N.00°-00'-

00"E. 1118.71 feet to the Point of Beginning; thence continuing N.00°-00'-00"E. 100 feet; thence S.90°-00'-00"E. 100 feet; thence S.00°-00'-00"W. 100 feet; thence N.90°-00'-00"W. 100 feet to the Point of Beginning.

Also a tract of land 50 feet of even width lying 25 feet on each side of the following described centerline: Commencing at the southwest corner of the NE¼ of Section 12; thence easterly 770.64 feet on the south line of the NE¼ of said Section 12; thence N.00°-00'-00"E. 1168.71 feet to the Point of Beginning; thence N.90°-00'-00"W. 778.19 feet to the Point of Termination on the west line of the NE¼ of Section 12.

Together with the following described tract:

Turbine 151 & Access Drive

A part of the NW¼ of Section 12 more particularly described as follows: Commencing at the southeast corner of the NW¼ of Section 12; thence westerly 405.84 feet on the south line of the NW¼ of said Section 12; thence N.00°-00'-00"E. 878.88 feet to the Point of Beginning; thence S.90°-00'-00"W. 100 feet; thence N.00°-00'-00"E. 100 feet; thence N.90°-00'-00"E. 100 feet; thence S.00°-00'-00"E. 100 feet to the Point of Beginning.

Also a tract of land 50 feet of even width lying 25 feet on each side of the following described centerline: Commencing at the northeast corner of the NW¼ of Section 12; thence southerly 1372.55 feet on the east line of the NW¼ of said Section 12 to the Point of Beginning; thence continuing southerly 390.43 feet on the east line of the NW¼ of said Section 12; thence N.90°-00'-00"W. 399.51 feet to the Point of Termination.

Together with the following described tract:

Energy Collection System Group

A part of the NW¼ and a part of the NE¼ of Section 12 being a tract of land 20 feet of even width lying 10 feet on each side of the following described centerline: Commencing at the southwest corner of the NW¼ of Section 12; thence northerly 606.57 feet on the west line of said Section 12 to the Point of Beginning; thence S.80°-54'-46"E. 587.94 feet; thence N.47°-10'-45"E. 1127.18 feet; thence S.62°-38'-36"E. 849.61 feet; thence N.80°-22'-14"E. 1294.48 feet to the Point of Termination.

And also the following described tract:

A part of the NW¼ of Section 12 being a tract of land 20 feet of even width lying 10 feet on each side of the following described centerline: Commencing at the northeast corner of the NW¼ of Section 12; thence westerly 1419.83 feet on the north line of Section 12 to the Point of Beginning; thence S.09°-17'-06"E. 1409.39 feet to the Point of Termination.

Said land area herein described in Dry Grove Township containing 108 acres,
more or less.

WHITE OAK TOWNSHIP ENTERPRISE ZONE ADDITIONS

Part of Sections 13, 14, 15, 22, 23, 24, 25, 26, 27, 28, 33, 34, 35, and 36 in Township 25 North, Range 1 East of the Third Principal Meridian, McLean County, Illinois, described as follows:

Public Road Area

The West 30 feet of the SW $\frac{1}{4}$ of Section 13; the East 30 feet of the SE $\frac{1}{4}$ of Section 14; the East 30 feet of Section 22 lying south of McLean County Highway No. 12; the West 30 feet of Section 23 lying south of McLean County Highway No. 12; the East 30 feet of Section 23; the West 30 feet of Section 24; the West 30 feet of Section 25; the public road 60 feet in width across the South 250 feet of Section 25; the East 30 feet of Section 26; the public road 60 feet in width across the South 200 feet of Section 26; the West 30 feet of Section 26; the East 30 feet of Section 27; the West 50 feet of the East 80 feet of the SE $\frac{1}{4}$ of Section 27; the public road 60 feet in width across the South 150 feet of Section 27; the South 30 feet of Section 34 lying east of the centerline of U.S. Route 150; the East 30 feet of Section 34; the West 30 feet of Section 35; the South 30 feet of Section 35; the East 30 feet of Section 35; the West 30 feet of Section 36; the South 30 feet of Section 36.

Together with the following described tract:

Turbine 158 & Access Road

A part of the SW $\frac{1}{4}$ of Section 13 more particularly described as follows: Commencing at the southeast corner of the SW $\frac{1}{4}$ of Section 13; thence northerly 445.84 feet on the east line of the SW $\frac{1}{4}$ of said Section 13; thence N.90°-00'-00"W. 428.13 feet to the Point of Beginning; thence continuing N.90°-00'-00"W. 100 feet; thence N.00°-00'-00"E. 100 feet; thence S.90°-00'-00"E. 100 feet; thence S.00°-00'-00"W. 100 feet to the Point of Beginning.

Also a tract of land 50 feet of even width lying 25 feet on each side of the following described centerline: Commencing at the southwest corner of the SW $\frac{1}{4}$ of Section 13; thence northerly 25 feet on the west line of said Section 13 to the Point of Beginning; thence easterly 2140.25 feet parallel with the south line of the SW $\frac{1}{4}$ of said Section 13; thence N.00°-00'-00"W. 428.96 feet to the Point of Termination.

Together with the following described tract:

Energy Collection System Group

A part of the SW¼ of Section 13 being a tract of land 20 feet of even width lying 10 feet lying on each side of the following described centerline: Commencing at the southwest corner of the SW¼ of Section 13; thence easterly 1271.10 feet on the south line of the SW¼ of said Section 13 to the Point of Beginning; thence N.59°-09'-55"E. 1012.05 feet to the Point of Termination.

Together with the following described tract:

Turbine 126 & Access Road

A part of the SE¼ of Section 14 more particularly described as follows:

Commencing at the southwest corner of the SE¼ of Section 14; thence easterly 201.71 feet on the south line of the SE¼ of Section 14; thence N.00°-00'-00"E. 1197.27 feet to the Point of Beginning; thence continuing N.00°-00'-00"E. 100 feet; thence S.90°-00'-00"E. 100 feet; thence S.00°-00'-00"W. 100 feet; thence S.90°-00'-00"W. 100 feet to the Point of Beginning.

Also a tract of land 50 feet of even width lying 25 feet on each side of the following described centerline: Commencing at the southeast corner of the SE¼ of Section 14; thence northerly 1308.40 feet on the east line of the SE¼ of said Section 14 to the Point of Beginning; thence N.89°-14'-35"W. 1321.52 feet; thence S.86°-55'-46"W. 1009.89 feet to the Point of Termination.

Together with the following described tract:

Turbine 146 & Access Road

A part of the SW¼ of Section 14 more particularly described as follows:

Commencing at the northeast corner of the SW¼ of Section 14; thence westerly 762.47 feet on the north line of the SW¼ of said Section 14; thence S.00°-00'-00"E. 680.71 feet to the Point of Beginning; thence continuing S.00°-00'-00"E. 100 feet; thence N.90°-00'-00"W. 100 feet; thence N.00°-00'-00"E. 100 feet; thence S.90°-00'-00"E. 100 feet to the Point of Beginning.

Also a tract of land in the SW¼ and SE¼ of Section 14 being 50 feet of even width lying 25 feet on each side of the following described centerline: Commencing at the northeast corner of the SW¼ of Section 14; thence westerly 762.47 feet on the north line of the SW¼ of said Section 14; thence S.00°-00'-00"E. 730.71 feet to the Point of Beginning; thence N.90°-00'-00"E. 788.93 feet to a point lying 25 feet east of the west line of the SE¼ of said Section 14; thence southerly 675.85 feet parallel with the west line of the SE¼ of said Section 14; thence N.90°-00'-00"E. 179.25 feet to the Point of Termination.

Together with the following described tract:

Turbine 159 & Access Drive

A part of the SW¼ of Section 14 more particularly described as follows:

Commencing at the southwest corner of the SW¼ of Section 14; thence easterly 732.86 feet on the south line of the SW¼ of said Section 14; thence N.00°-00'-

00°E. 922.90 feet to the Point of Beginning; thence continuing N.00°-00'-00"E. 100 feet; thence S.90°-00'-00"E. 100 feet; thence S.00°-00'-00"W. 100 feet; thence N.90°-00'-00"W. 100 feet to the Point of Beginning.

Also a tract of land 50 feet of even width lying 25 feet on each side of the following described centerline: Commencing at the southwest corner of the SW¼ of Section 14; thence northerly 966.44 feet on the west line of Section 14 to the Point of Beginning; thence N.90°-00'-00"E. 735.68 feet to the Point of Termination.

Together with the following described tract:

Energy Collection System Group

A part of the SW¼ and a part of the SE¼ of Section 14 being a tract of land 20 feet of even width lying 10 feet on each side of the following described centerline: Commencing at the southwest corner of the SW¼ of Section 14; thence northerly 728.35 feet on the west line of Section 14 to the Point of Beginning; thence N.73°-07'-33"E. 820.23 feet; thence N.47°-46'-52"E. 1386.61 feet; thence S.57°-42'-40"E. 1265.19 feet; thence S.39°-49'-02"E. 1636.46 feet to the Point of Termination on the south line of the SE¼ of Section 14.

Together with the following described tract:

Turbine 124 & Access Drive

A part of the SE¼ of Section 15 more particularly described as follows: Commencing at the southwest corner of the SE¼ of Section 15; thence northerly 132.50 feet on the west line of the SE¼ of said Section 15; thence N.90°-00'-00"E. 524.92 feet to the Point of Beginning; thence continuing N.90°-00'-00"E. 100 feet; thence S.00°-00'-00"E. 100 feet; thence S.90°-00'-00"W. 100 feet; thence N.00°-00'-00"E. 100 feet to the Point of Beginning.

Also a tract of land 50 feet of even width lying 25 feet on each side of the following described centerline: Commencing at the southeast corner of the SE¼ of Section 15; thence westerly 25 feet on the south line of said Section 15 to the Point of Beginning; thence northerly 25 feet parallel with the east line of said Section 15; thence westerly 2105.88 feet parallel with the south line of said Section 15; thence N.00°-00'-00"W. 14.76 feet to the Point of Termination.

Together with the following described tract:

Turbine 125 & Access Drive

A part of the SE¼ of Section 15 more particularly described as follows: Commencing at the southeast corner of the SE¼ of Section 15; thence westerly 151.43 feet on the south line of said Section 15; thence N.00°-00'-00"E. 615.95 feet to the Point of Beginning; thence S.90°-00'-00"W. 100 feet; thence N.00°-00'-00"W. 100 feet; thence N.90°-00'-00"E. 100 feet; thence S.00°-00'-00"W. 100 feet to the Point of Beginning.

Also a tract of land 50 feet of even width lying 25 feet on each side of the following described centerline: Commencing at the southeast corner of the SE¼ of Section 15; thence northerly 25 feet on the east line of the SE¼ of said Section 15; thence westerly 25 feet parallel with the south line of said Section 15 to the Point of Beginning; thence northerly 941.13 feet parallel with the east line of said Section 15; thence N.90°-00'-00"E. 25.00 feet to the Point of Termination on the east line of the SE¼ of said Section 15.

And also a tract of land 50 feet of even width lying 25 feet on each side of the following described centerline: Commencing at the southeast corner of the SE¼ of Section 15; thence westerly 151.43 feet on the south line of said Section 15; thence N.00°-00'-00"E. 665.95 feet to the Point of Beginning; thence S.90°-00'-00"E. 124.53 feet to the Point of Termination lying 25 feet west of the east line of Section 15.

Together with the following described tract:

Turbine 147 & Access Drive

A part of the SE¼ of Section 15 more particularly described as follows: Commencing at the southwest corner of the SE¼ of Section 15; thence northerly 440.90 feet on the west line of the SE¼ of said Section 15; thence N.90°-00'-00"E. 1471.30 feet to the Point of Beginning; thence continuing N.90°-00'-00"E. 100 feet; thence S.00°-00'-00"W. 100 feet; thence N.90°-00'-00"W. 100 feet; thence N.00°-00'-00"E. 100 feet to the Point of Beginning.

Also a tract of land 50 feet of even width lying 25 feet on each side of the following described centerline: Commencing at the southeast corner of the SE¼ of Section 15; thence northerly 25 feet on the east line of said Section 15; thence westerly 1185.93 feet parallel with the south line of said Section 15 to the Point of Beginning; thence N.00°-00'-00"E. 334.96 feet to the Point of Termination.

Also a tract of land 50 feet of even width lying 25 feet on each side of the following described centerline: Commencing at the southeast corner of SE¼ of Section 15; thence westerly 25 feet on the south line of SE¼ of said Section 15; thence northerly 991.13 feet parallel with the east line of the SE¼ of said Section 15 to the Point of Beginning; thence northerly 292.60 feet parallel with the east line of the SE¼ of said Section 15; thence S.87°-38'-49"W. 1304.59 feet; thence S.00°-13'-04"E. 805.37 feet; thence N.90°-00'-00"E. 93.63 feet to the Point of Termination.

Also a tract of land 50 feet of even width lying 25 feet on each side of the following described centerline: Commencing at the southwest corner of the SE¼ of Section 15; thence easterly 1377.00 feet on the south line of SE¼ of said Section 15; thence N.00°-00'-00"E. 50.00 feet to the Point of Beginning; thence N.00°-13'-04"W. 358.14 feet to the Point of Termination.

Together with the following described tract:

Energy Collection System Group

A part of the SE¼ of Section 15 being a tract of land 20 feet of even width lying 10 feet of even width on each side of the following described centerline:

Commencing at the southeast corner of the SE¼ of Section 15; thence northerly 728.35 feet on the east line of said Section 15 to the Point of Beginning; thence S.73°-07'-33"W. 208.30 feet; thence S.76°-08'-37"W. 1013.75 feet; thence S.71°-55'-29"W. 993.93 feet to the Point of Termination.

Together with the following described tract:

Turbine 98 & Access Drive

A part of the SE¼ of Section 22 more particularly described as follows:

Commencing at the southeast corner of the SE¼ of Section 22; thence westerly 1164.43 feet on the south line of said Section 22; thence N.00°-00'-00"E. 673.61 feet to the Point of Beginning; thence N.90°-00'-00"W. 100 feet; thence N.00°-00'-00"E. 100 feet; thence N.90°-00'-00"E. 100 feet; thence S.00°-00'-00"W. 100 feet to the Point of Beginning.

Also a tract of land 50 feet of even width lying 25 feet on each side of the following described centerline: Commencing at the southeast corner of the SE¼ of Section 22; thence westerly 2289.81 feet on the south line of said Section 22; thence N.00°-00'-00"E. 1109.10 feet to the Point of Beginning; thence S.90°-00'-00"E. 1075.33 feet; thence S.00°-00'-00"W. 346.98 feet to the Point of Termination.

Together with the following described tract:

Turbine 100 & Access Drive

A part of the S½ and a part of the N½ of Section 22 more particularly described as follows: Commencing at the southeast corner of the SE¼ of Section 22; thence westerly 2289.81 feet on the south line of said Section 22; thence N.00°-00'-00"E. 1059.10 feet to the Point of Beginning; thence S.90°-00'-00"W. 100 feet; thence N.00°-00'-00"E. 100 feet; thence N.90°-00'-00"E. 100 feet; thence S.00°-00'-00"W. 100 feet to the Point of Beginning.

Also a tract of land 50 feet of even width lying 25 feet on each side of the following described centerline: Commencing at the southeast corner of the SE¼ of Section 22; thence westerly 2289.81 feet on the south line of said Section 22; thence N.00°-00'-00"E. 1059.10 feet; thence S.90°-00'-00"W. 100 feet; thence N.00°-00'-00"E. 54.33 feet to the Point of Beginning; thence N.85°-09'-01"W. 195.48 feet; thence northerly 145.46 feet on a tangential curve concave to the northeast subtended by a chord of 130.13 feet bearing N.38°-51'-00"W. from the last described course; thence N.07°-27'-01"E. 324.77 feet; thence westerly 119.93 feet on a tangential curve concave to the southwest subtended by a chord of 103.63 feet bearing N.45°-24'-26"W. from the last described course; thence S.81°-44'-08"W. 12.35 feet; thence northwesterly 101.27 feet on a

tangential curve concave to the northeast subtended by a chord of 91.34 feet bearing N.53°-37'-45"W. from the last described course; thence N.08°-59'-38"W. 364.44 feet; thence N.01°-35'-42"W. 248.24 feet; thence northeasterly 93.06 feet on a tangential curve concave to the southeast subtended by a chord of 86.36 feet bearing N.36°-29'-29"E. from the last described course; thence N.74°-34'-40"E. 97.71 feet; thence northeasterly 84.88 feet on a tangential curve concave to the northwest subtended by a chord of 79.78 feet bearing N.39°-50'-24"E. from the last described course; thence N.05°-06'-08"E. 309.00 feet to the Point of Termination on the north line of a public road commonly known as McLean County Highway No. 12.

Together with the following described tract:

Turbine 117 & Access Drive

A part of the NE¼ of Section 22 more particularly described as follows:

Commencing at the northeast corner of the NE¼ of Section 22; thence southerly 964.42 feet on the east line of said Section 22; thence N.90°-00'-00"W. 215.16 feet to the Point of Beginning; thence continuing N.90°-00'-00"W. 100 feet; thence N.00°-00'-00"E. 100 feet; thence S.90°-00'-00"E. 100 feet; thence S.00°-00'-00"E. 100 feet to the Point of Beginning.

Also a tract of land 50 feet of even width lying 25 feet on each side of the following described centerline: Commencing at the northeast corner of the NE¼ of Section 22; thence westerly 25 feet on the north line of said Section 22 to the Point of Beginning; thence southerly 2650.00 feet parallel with the east line of the NE¼ of said Section 22 to the south line of a public road commonly known as McLean County Highway No. 12.

And also a tract of land 50 feet of even width lying 25 feet on each side of the following described centerline: Commencing at the northeast corner of the NE¼ of Section 22; thence westerly 25 feet on the north line of said Section 22; thence southerly 854.74 feet parallel with the east line of the NE¼ of said Section 22 to the Point of Beginning; thence N.90°-00'-00"W. 190.10 feet to the Point of Termination.

Together with the following described tract:

Energy Collection System Group

A part of the SE¼ of Section 22 being a tract of land 20 feet of even width lying 10 feet on each side of the following described centerline: Commencing at the southeast corner of the SE¼ of Section 22; thence northerly 1176.83 feet on the east line of the SE¼ to the Point of Beginning; thence S.70°-00'-45"W. 1290.85 feet; thence N.70°-34'-28"W. 1193.35 feet to the Point of Termination.

And also the following described tract:

A part of the SE¼ of Section 22 being a tract of land 20 feet of even width lying 10 feet on each side of the following described centerline: Commencing at the

southeast corner of the SE $\frac{1}{4}$ of Section 22; thence westerly 1618.98 feet on the south line of the SE $\frac{1}{4}$ of said Section 22 to the Point of Beginning; thence N.29°-22'-00"E. 825.09 feet to the Point of Termination.

And also the following described tract:

A part of the NE $\frac{1}{4}$ of Section 22 being a tract of land 20 feet of even width lying 10 feet on each side of the following described centerline: Commencing at the northeast corner of the NE $\frac{1}{4}$ of Section 22; thence westerly 228.67 feet on the north line of said Section 22 to the Point of Beginning; thence S.02°-20'-42"W. 858.05 feet to the Point of Termination.

Together with the following described tract:

Turbine 94 & Access Drive

A part of the SE $\frac{1}{4}$ of Section 23 more particularly described as follows: Commencing at the southeast corner of the SE $\frac{1}{4}$ of Section 23; thence westerly 769.36 feet on the south line of said Section 23; thence N.00°-00'-00"E. 1202.58 feet to the Point of Beginning; thence S.90°-00'-00"W. 100 feet; thence N.00°-00'-00"E. 100 feet; thence S.90°-00'-00"E. 100 feet; thence S.00°-00'-00"W. 100 feet to the Point of Beginning.

Also a tract of land 50 feet of even width lying 25 feet on each side of the following described centerline: Commencing at the southeast corner of the SE $\frac{1}{4}$ of Section 23; thence northerly 1259.45 feet on the east line of said Section 23 to the Point of Beginning; thence S.90°-00'-00"W. 770.72 feet to the Point of Termination.

Together with the following described tract:

Turbine 95 & Access Drive

A part of the SE $\frac{1}{4}$ of Section 23 more particularly described as follows: Commencing at the southeast corner of the SE $\frac{1}{4}$ of Section 23; thence westerly 2050.51 feet on the south line of the SE $\frac{1}{4}$ of said Section 23; thence N.00°-00'-00"W. 446.13 feet to the Point of Beginning; thence continuing N.00°-00'-00"W. 100 feet; thence S.90°-00'-00"E. 100 feet; thence S.00°-00'-00"W. 100 feet; thence N.90°-00'-00"W. 100 feet to the Point of Beginning.

Also a tract of land in the SE $\frac{1}{4}$ and in the SW $\frac{1}{4}$ of Section 23 being a tract of land 50 feet of even width lying 25 feet on each side of the following described centerline: Commencing at the southeast corner of the SW $\frac{1}{4}$ of Section 23; thence westerly 529.17 feet on the south line of the SW $\frac{1}{4}$ of said Section 23 to the Point of Beginning; thence N.00°-02'-12"E. 497.25 feet; thence S.89°-28'-08"E. 1104.16 feet to the Point of Termination.

Together with the following described tract:

Turbine 96 & Access Drive

A part of the SW¼ of Section 23 more particularly described as follows:

Commencing at the southwest corner of the SW¼ of Section 23; thence northerly 485.37 feet on the west line of said Section 23; thence N.90°-00'-00"E. 1856.14 feet to the Point of Beginning; thence N.00°-00'-00"E. 100 feet; thence S.90°-00'-00"E. 100 feet; thence S.00°-00'-00"W. 100 feet; thence S.90°-00'-00"W. 100 feet to the Point of Beginning.

Also a tract of land 50 feet of even width lying 25 feet on each side of the following described centerline: Commencing at the southeast corner of the SW¼ of Section 23; thence westerly 529.17 feet on the south line of the SW¼ of said Section 23; thence N.00°-02'-12"E. 554.79 feet to the Point of Beginning; thence N.90°-00'-00"W. 141.07 feet to the Point of Termination.

Together with the following described tract:

Turbine 109 & Access Drive

A part of the NE¼ of Section 23 more particularly described as follows:

Commencing at the southwest corner of the NE¼ of Section 23; thence northerly 683.41 feet on the west line of the NE¼ of said Section 23; thence N.90°-00'-00"E. 410.93 feet to the Point of Beginning; thence N.00°-00'-00"W. 100 feet; thence N.90°-00'-00"E. 100 feet; thence S.00°-00'-00"W. 100 feet; thence S.90°-00'-00"W. 100 feet to the Point of Beginning.

Also a tract of land 50 feet of even width lying 25 feet on each side of the following described centerline: Commencing at the southwest corner of the NE¼ of Section 23; thence easterly 459.56 feet on the south line of the NE¼ of said Section 23 to the Point of Beginning; thence N.00°-00'-00"E. 688.43 feet to the Point of Termination.

Together with the following described tract:

Turbine 116 & Access Drive

A part of the NE¼ of Section 23 more particularly described as follows:

Commencing at the northeast corner of the NE¼ of Section 23; thence westerly 999.09 feet on the north line of the NE¼ of said Section 23; thence S.00°-00'-00"E. 287.88 feet to the Point of Beginning; thence continuing S.00°-00'-00"E. 100 feet; thence S.90°-00'-00"W. 100 feet; thence N.00°-00'-00"E. 100 feet; thence S.90°-00'-00"E. 100 feet to the Point of Beginning.

Also a tract of land 50 feet of even width lying 25 feet on each side of the following described centerline: Commencing at the northeast corner of the NE¼ of Section 23; thence southerly 807.90 feet on the east line of the NE¼ of said Section 23 to the Point of Beginning; thence N.89°-26'-03"W. 1048.98 feet; thence N.00°-00'-00"W. 418.46 feet to the Point of Termination.

Together with the following described tract:

Turbine 165 & Access Drive

A part of the SW $\frac{1}{4}$ of Section 23 more particularly described as follows:

Commencing at the southwest corner of the SW $\frac{1}{4}$ of said Section 23; thence northerly 1582.74 feet on the west line of the SW $\frac{1}{4}$ of said Section 23; thence N.90°-00'-00"E. 928.70 feet to the Point of Beginning; thence continuing N.90°-00'-00"E. 100 feet; thence S.00°-00'-00"E. 100 feet; thence S.90°-00'-00"W. 100 feet; thence N.00°-00'-00"W. 100 feet to the Point of Beginning.

Also a tract of land 50 feet of even width lying 25 feet on each side of the following described centerline: Commencing at the southwest corner of the SW $\frac{1}{4}$ of Section 23; thence northerly 1305.16 feet on the west line of the SW $\frac{1}{4}$ of said Section 23 to the Point of Beginning; thence S.89°-27'-41"E. 2098.65 feet; thence S.00°-02'-12"W. 807.60 feet to the Point of Termination.

And also a tract of land 50 feet of even width lying 25 feet on each side of the following described centerline: Commencing at the southwest corner of the SW $\frac{1}{4}$ of Section 23; thence northerly 1305.16 feet on the west line of the SW $\frac{1}{4}$ of said Section 23; thence S.89°-27'-41"E. 978.57 feet to the Point of Beginning; thence N.00°-00'-00"E. 186.79 feet to the Point of Termination.

Together with the following described tract:

Energy Collection System Group

A part of the SW $\frac{1}{4}$, a part of the SE $\frac{1}{4}$ and a part of the NE $\frac{1}{4}$ of Section 23 being a tract of land 20 feet of even width lying 10 feet on each side of the following described centerline: Commencing at the southwest corner of the SW $\frac{1}{4}$ of Section 23; thence northerly 1176.83 feet on the west line of the SW $\frac{1}{4}$ of said Section 23 to the Point of Beginning; thence N.70°-00'-36"E. 1041.13 feet; thence S.42°-57'-04"E. 1362.65 feet; thence S.87°-04'-04"E. 1346.91 feet; thence N.57°-45'-58"E. 1396.29 feet; thence N.31°-53'-17"W. 2546.36 feet to the Point of Termination.

And also the following described tract:

A part of the SW $\frac{1}{4}$ of Section 23 being a tract of land 20 feet of even width lying 10 feet on each side of the following described centerline: Commencing at the southwest corner of the SW $\frac{1}{4}$ of Section 23; thence easterly 1973.69 feet on the south line of the SW $\frac{1}{4}$ of said Section 23 to the Point of Beginning; thence N.06°-59'-35"W. 557.80 feet to the Point of Termination.

And also the following described tract:

A part of the NE $\frac{1}{4}$ of Section 23 being a tract of land 20 feet of even width lying 10 feet on each side of the following described centerline: Commencing at the northeast corner of the NE $\frac{1}{4}$ of Section 23; thence southerly 273.01 feet on the east line of the NE $\frac{1}{4}$ of said Section 23 to the Point of Beginning; thence S.86°-

56'-26"W. 1050.51 feet; thence N.39°-49'-02"W. 443.72 feet to the Point of Termination on the north line of the NE¼ of Section 23.

Together with the following described tract:

Turbine 90 & Access Drive

A part of the SE¼ of Section 24 more particularly described as follows:

Commencing at the northeast corner of the SE¼ of Section 24; thence southerly 916.66 feet on the east line of the SE¼ of said Section 24; thence N.90°-00'-00"W. 492.18 feet to the Point of Beginning; thence S.00°-00'-00"E. 100 feet; thence N.90°-00'-00"W. 100 feet; thence N.00°-00'-00"E. 100 feet; thence S.90°-00'-00"E. 100 feet to the Point of Beginning.

Also a tract of land 50 feet of even width lying 25 feet on each side of the following described centerline: Commencing at the northeast corner of the SE¼ of Section 24; thence southerly 966.66 feet on the east line of the SE¼ of said Section 24 to the Point of Beginning; thence S.90°-00'-00"W. 492.11 feet to the Point of Termination.

Together with the following described tract:

Turbine 91 & Access Drive

A part of the SW¼ of Section 24 more particularly described as follows:

Commencing at the northeast corner of the SW¼ of Section 24; thence westerly 117.27 feet on the north line of the SW¼ of said Section 24; thence S.00°-00'-00"E. 1254.08 feet to the Point of Beginning; thence S.90°-00'-00"E. 100 feet; thence S.00°-00'-00"W. 100 feet; thence N.90°-00'-00"W. 100 feet; thence N.00°-00'-00"E. 100 feet to the Point of Beginning.

Also a part of the SW¼ of Section 24 being a tract of land 50 feet of even width lying 25 feet on each side of the following described centerline: Commencing at the northeast corner of the SW¼ of Section 24; thence westerly 25 feet on the north line of the SW¼ of said Section 24 to the Point of Beginning; thence S.00°-01'-44"E. 1255.26 feet parallel with the east line of the SW¼ of said Section 24 to the Point of Termination.

Together with the following described tract:

Turbine 93 & Access Drive

A part of the SW¼ of Section 24 more particularly described as follows:

Commencing at the northwest corner of the SW¼ of Section 24; thence southerly 1228.55 feet on the west line of the SW¼ of said Section 24; thence N.90°-00'-00"E. 1156.65 feet to the Point of Beginning; thence continuing N.90°-00'-00"E. 100 feet; thence S.00°-00'-00"E. 100 feet; thence S.90°-00'-00"W. 100 feet; thence N.00°-00'-00"E. 100 feet to the Point of Beginning.

Also a tract of land 50 feet of even width lying 25 feet on each side of the following described centerline: Commencing at the northeast corner of the SW¼ of Section 24; thence westerly 1333.95 feet on the north line of the SW¼ of said

Section 24 to the Point of Beginning; thence S.00°-00'-56"W. 1295.03 feet; thence S.90°-00'-00"W. 28.21 feet to the Point of Termination.

Together with the following described tract:

Turbine 111 & Access Drive

A part of the NE¼ of Section 24 more particularly described as follows:

Commencing at the southeast corner of the NE¼ of Section 24; thence westerly 718.01 feet on the south line of the NE¼ of said Section 24; thence N.00°-00'-00"E. 752.97 feet to the Point of Beginning; thence continuing N.00°-00'-00"E. 100 feet; thence S.90°-00'-00"E. 100 feet; thence S.00°-00'-00"W. 100 feet; thence N.90°-00'-00"W. 100 feet to the Point of Beginning.

Also a tract of land 50 feet of even width lying 25 feet on each side of the following described centerline: Commencing at the southeast corner of the NE¼ of Section 24; thence northerly 795.15 feet on the east line of the NE¼ of said Section 24 to the Point of Beginning; thence N.90°-00'-00"W. 617.57 feet to the Point of Termination.

Together with the following described tract:

Turbine 114 & Access Drive

A part of the NE¼ of Section 24 more particularly described as follows:

Commencing at the northeast corner of the NE¼ of Section 24; thence southerly 473.07 feet on the east line of the NE¼ of said Section 24; thence N.90°-00'-00"W. 438.00 feet to the Point of Beginning; thence S.00°-00'-00"E. 100 feet; thence S.90°-00'-00"W. 100 feet; thence N.00°-00'-00"E. 100 feet; thence S.90°-00'-00"E. 100 feet to the Point of Beginning.

Also a tract of land 50 feet of even width lying 25 feet on each side of the following described centerline: Commencing at the northeast corner of the NE¼ of Section 24; thence southerly 523.07 feet on the east line of the NE¼ of said Section 24 to the Point of Beginning; thence N.90°-00'-00"W. 438.03 feet to the Point of Termination.

Together with the following described tract:

Turbine 115 & Access Drive

A part of the NW¼ of Section 24 more particularly described as follows:

Commencing at the northwest corner of the NW¼ of Section 24; thence southerly 177.37 feet on the west line of the NW¼ of said Section 24; thence S.90°-00'-00"E. 803.86 feet to the Point of Beginning; thence continuing S.90°-00'-00"E. 100 feet; thence S.00°-00'-00"W. 100 feet; thence N.90°-00'-00"W. 100 feet; thence N.00°-00'-00"E. 100 feet to the Point of Beginning.

Also a tract of land 50 feet of even width lying 25 feet on each side of the following described centerline: Commencing at the northwest corner of the NW¼ of Section 24; thence easterly 835.95 feet on the north line of the NW¼ of said

Section 24 to the Point of Beginning; thence S.00°-00'-00"E. 191.89 feet to the Point of Termination.

Together with the following described tract:

Energy Collection System Group

A part of the SE¼ and a part of the NE¼ of Section 24 being a tract of land 20 feet of even width lying 10 feet on each side of the following described centerline: Commencing at the southeast corner of the SE¼ of Section 24; thence northerly 1705.28 feet on the east line of the SE¼ of said Section 24 to the Point of Beginning; thence N.88°-11'-26"W. 542.62 feet; thence N.04°-02'-52"W. 1766.21 feet; thence N.07°-25'-49"E. 1383.00 feet to the Point of Termination.

And also the following described tract:

A part of the SE¼, a part of the SW¼ and a part of the NW¼ of Section 24 being a tract of land 20 feet of even width lying 10 feet of even width on each side of the following described centerline: Commencing at the southeast corner of the SE¼ of Section 24; thence westerly 2386.89 feet on the south line of the SE¼ of said Section 24 to the Point of Beginning; thence N.12°-08'-58"W. 1403.53 feet; thence S.89°-43'-14"W. 1345.16 feet; thence N.00°-02'-40"E. 3052.40 feet; thence N.28°-06'-50"W. 750.00 feet to the Point of Termination.

And also the following described tract:

A part of the NW¼ of Section 24 being a tract of land 20 feet of even width lying 10 feet on each side of the following described centerline: Commencing at the northwest corner of the NW¼ of Section 24; thence southerly 273.01 feet on the west line of the NW¼ of said Section 24 to the Point of Beginning; thence N.86°-56'-26"E. 855.09 feet; thence N.59°-09'-55"E. 485.75 feet to the Point of Termination on the north line of the NW¼ of Section 24.

Together with the following described tract:

Turbine 69 & Access Drive

A part of the SW¼ of Section 25 more particularly described as follows: Commencing at the southwest corner of the SW¼ of Section 25; thence northerly 1206.42 feet on the west line of the SW¼ of said Section 25; thence N.90°-00'-00"E. 983.26 feet to the Point of Beginning; thence continuing N.90°-00'-00"E. 100 feet; thence S.00°-00'-00"W. 100 feet; thence N.90°-00'-00"W. 100 feet; thence N.00°-00'-00"E. 100 feet to the Point of Beginning.

Also a tract of land 50 feet of even width lying 25 feet on each side of the following described centerline: Commencing at the southwest corner of the SW¼ of Section 25; thence northerly 1206.42 feet on the west line of the SW¼ of said Section 25; thence N.90°-00'-00"E. 983.26 feet; thence S.00°-00'-00"W. 100 feet to the Point of Beginning; thence S.45°-15'-21"W. 519.76 feet to the Point of Termination.

Together with the following described tract:

Turbine 70 & Access Drive

A part of the SE¼ of Section 25 more particularly described as follows:

Commencing at the southeast corner of the SE¼ of Section 25; thence westerly 437.37 feet on the south line of the SE¼ of said Section 25; thence N.00°-00'-00"E. 934.75 feet; thence S.90°-00'-00"W. 100 feet; thence N.00°-00'-00"E. 100 feet; thence S.90°-00'-00"E. 100 feet; thence S.00°-00'-00"W. 100 feet to the Point of Beginning.

Also a tract of land 50 feet of even width lying 25 feet on each side of the following described centerline: Commencing at the southeast corner of the SE¼ of Section 25; thence northerly 986.24 feet on the east line of the SE¼ of said Section 25 to the Point of Beginning; thence N.90°-00'-00"W. 439.55 feet to the Point of Termination.

Together with the following described tract:

Turbine 75 & Access Drive

A part of the SE¼ of Section 25 more particularly described as follows:

Commencing at the northwest corner of the SE¼ of Section 25; thence southerly 626.98 feet on the west line of the SE¼ of said Section 25; thence N.90°-00'-00"E. 508.34 feet to the Point of Beginning; thence N.00°-00'-00"W. 100 feet; thence S.90°-00'-00"E. 100 feet; thence S.00°-00'-00"W. 100 feet; thence N.90°-00'-00"W. 100 feet to the Point of Beginning.

Also a tract of land 50 feet of even width lying 25 feet on each side of the following described centerline: Commencing at the northwest corner of the SE¼ of Section 25; thence southerly 25 feet on the west line of the SE¼ of said Section 25 to the Point of Beginning; thence easterly 559.62 feet parallel with the north line of the SE¼ of said Section 25; thence S.00°-00'-00"E. 502.90 feet to the Point of Termination.

Together with the following described tract:

Turbine 76 & Access Drive

A part of the SW¼ of Section 25 more particularly described as follows:

Commencing at the northwest corner of the SW¼ of Section 25; thence southerly 500.51 feet on the west line of the SW¼ of said Section 25; thence N.90°-00'-00"E. 1460.96 feet to the Point of Beginning; thence N.00°-00'-00"E. 100 feet; thence S.90°-00'-00"E. 100 feet; thence S.00°-00'-00"W. 100 feet; thence S.90°-00'-00"W. 100 feet to the Point of Beginning.

Also a tract of land 50 feet of even width lying 25 feet on each side of the following described centerline: Commencing at the northwest corner of SW¼ of Section 25; thence southerly 25 feet on the west line of the SW¼ of Section 25 to the Point of Beginning; thence easterly 2607.46 feet parallel with the north line of

the SW¼ of said Section 25 to the Point of Termination on the east line of the SW¼ of said Section 25.

And also a tract of land 50 feet of even width lying 25 feet on each side of the following described centerline: Commencing at the northwest corner of the SW¼ of Section 25; thence southerly 25 feet on the west line of the SW¼ of said Section 25; thence easterly 1510.26 feet parallel with the north line of the SW¼ of said Section 25 to the Point of Beginning; thence S.00°-00'-00"W. 376.55 feet to the Point of Termination.

Together with the following described tract:

Turbine 131 & Access Drive

A part of the NE¼ of Section 25 more particularly described as follows: Commencing at the southeast corner of the NE¼ of Section 25; thence northerly 1519.15 feet on the east line of the NE¼ of said Section 25; thence N.90°-00'-00"W. 2075.74 feet to the Point of Beginning; thence S.00°-00'-00"E. 100 feet; thence N.90°-00'-00"W. 100 feet; thence N.00°-00'-00"E. 100 feet; thence S.90°-00'-00"E. 100 feet to the Point of Beginning.

Also a tract of land 50 feet of even width lying 25 feet on each side of the following described centerline: Commencing at the southwest corner of the NE¼ of Section 25; thence easterly 25 feet on the south line of the NE¼ of said Section 25 to the Point of Beginning; thence N.00°-22'-56"E. 1473.54 feet parallel with the west line of the NE¼ of said Section 25; thence N.90°-00'-00"E. 418.85 feet to the Point of Termination.

Together with the following described tract:

Turbine 160 & Access Drive

A part of the SW¼ of Section 25 more particularly described as follows: Commencing at the southwest corner of the SW¼ of Section 25; thence northerly 640.54 feet on the west line of the SW¼ of said Section 25; thence N.90°-00'-00"E. 514.87 feet to the Point of Beginning; thence N.00°-00'-00"E. 100 feet; thence S.90°-00'-00"E. 100 feet; thence S.00°-00'-00"W. 100 feet; thence S.90°-00'-00"W. 100 feet to the Point of Beginning.

Also a tract of land 50 feet of even width lying 25 feet on each side of the following described centerline: Commencing at the southwest corner of the SW¼ of Section 25; thence northerly 690.54 feet on the west line of the SW¼ of said Section 25 to the Point of Beginning; thence S.90°-00'-00"E. 514.80 feet to the Point of Termination.

Together with the following described tract:

Energy Collection System Group

A part of the SE¼ of Section 25 being a tract of land 20 feet of even width lying 10 feet on each side of the following described centerline: Commencing at the southeast corner of the SE¼ of Section 25; thence northerly 171.52 feet on the

east line of the SE $\frac{1}{4}$ of said Section 25 to the centerline of a public road; thence westerly 725.53 feet on said public road centerline to the Point of Beginning; thence N.16°-01'-06"E. 849.90 feet; thence N.50°-15'-43"E. 637.80 feet to the Point of Termination on the east line of the SE $\frac{1}{4}$ of Section 25.

And also the following described tract:

A part of the SE $\frac{1}{4}$ and a part of the NE $\frac{1}{4}$ of Section 25 being a tract of land 20 feet of even width lying 10 feet on each side of the following described centerline: Commencing at the southeast corner of the SE $\frac{1}{4}$ of Section 25; thence northerly 171.52 feet on the east line of the SE $\frac{1}{4}$ of said Section 25 to the centerline of a public road; thence westerly 1592.37 feet on said public road centerline to the Point of Beginning; thence N.00°-39'-47"E. 1958.53 feet; thence N.15°-09'-48"W. 2107.06 feet; thence N.12°-08'-58"W. 1230.93 feet to the Point of Termination on the north line of the NE $\frac{1}{4}$ of Section 25.

And also the following described tract:

A part of the SE $\frac{1}{4}$ and a part of the SW $\frac{1}{4}$ of Section 25 being a tract of land 20 feet of even width lying 10 feet on each side of the following described centerline: Commencing at the southeast corner of the SE $\frac{1}{4}$ of Section 25; thence northerly 171.52 feet on the east line of the SE $\frac{1}{4}$ of said Section 25 to the centerline of a public road; thence westerly 1709.25 feet on said public road centerline to the Point of Beginning; thence N.10°-22'-54"W. 1974.25 feet; thence N.85°-41'-48"W. 1661.51 feet; thence N.84°-38'-09"W. 1517.34 feet to the Point of Termination on the west line of the SW $\frac{1}{4}$ of Section 25.

And also the following described tract:

A part of the SW $\frac{1}{4}$ and a part of the SE $\frac{1}{4}$ of Section 25 being a tract of land 20 feet of even width lying 10 feet on each side of the following described centerline: Commencing at the southwest corner of the SW $\frac{1}{4}$ of Section 25; thence northerly 1001.40 feet on the west line of the SW $\frac{1}{4}$ of said Section 25 to the Point of Beginning; thence S.61°-09'-15"E. 644.33 feet; thence S.72°-10'-29"E. 2290.30 feet to the south line of SE $\frac{1}{4}$ of Section 25.

Together with the following described tract:

Turbine 66 & Access Drive

A part of the SW $\frac{1}{4}$ of Section 26 more particularly described as follows: Commencing at the southwest corner of the SW $\frac{1}{4}$ of Section 26; thence northerly 1451.67 feet on the west line of the SW $\frac{1}{4}$ of said Section 26; thence N.90°-00'-00"E. 1488.91 feet to the Point of Beginning; thence N.00°-00'-00"E. 100 feet; thence S.90°-00'-00"E. 100 feet; thence S.00°-00'-00"W. 100 feet; thence N.90°-00'-00"W. 100 feet to the Point of Beginning.

Also a tract of land 50 feet of even width lying 25 feet on each side of the following described centerline: Commencing at the southwest corner of the SW¼ of Section 26; thence easterly 896.33 feet on the south line of the SW¼ of said Section 26; thence N.00°-00'-00"E. 64.20 feet to the Point of Beginning at the centerline of a public road; thence N.02°-29'-23"E. 185.22 feet; thence N.19°-01'-32"E. 249.04 feet; thence N.24°-26'-38"E. 196.19 feet; thence N.35°-32'-16"E. 209.51 feet; thence N.43°-36'-10"E. 235.44 feet; thence N.48°-21'-59"E. 195.52 feet; thence N.45°-00'-00"E. 57.72 feet; thence N.00°-00'-00"E. 285.80 feet to the Point of Termination.

Together with the following described tract:

Turbine 68 & Access Drive

A part of the SE¼ of Section 26 more particularly described as follows: Commencing at the southeast corner of the SE¼ of Section 26; thence northerly 1541.07 feet on the east line of the SE¼ of said Section 26; thence N.90°-00'-00"W. 839.77 feet to the Point of Beginning; thence S.00°-00'-00"E. 100 feet; thence N.90°-00'-00"W. 100 feet; thence N.00°-00'-00"E. 100 feet; thence S.90°-00'-00"E. 100 feet to the Point of Beginning.

Also a tract of land 50 feet of even width lying 25 feet on each side of the following described centerline: Commencing at the southwest corner of the SE¼ of Section 26; thence northerly 1456.12 feet on the west line of the SE¼ of said Section 26; thence N.90°-00'-00"E. 25 feet to the Point of Beginning; thence continuing N.90°-00'-00"E. 1707.46 feet to the Point of Termination.

Together with the following described tract:

Turbine 139 & Access Drive

A part of the NW¼ of Section 26 more particularly described as follows: Commencing at the northeast corner of the NW¼ of Section 26; thence southerly 942.15 feet on the east line of the NW¼ of said Section 26; thence N.90°-00'-00"W. 479.17 feet to the Point of Beginning; thence S.00°-00'-00"E. 100 feet; thence S.90°-00'-00"W. 100 feet; thence N.00°-00'-00"E. 100 feet; thence S.90°-00'-00"E. 100 feet to the Point of Beginning.

Also a tract of land 50 feet of even width lying 25 feet on each side of the following described centerline: Commencing at the northeast corner of the NW¼ of Section 26; thence westerly 529.17 feet on the north line of the NW¼ of said Section 26 to the Point of Beginning; thence S.00°-01'-28"W. 947.05 feet to the Point of Termination.

Together with the following described tract:

Turbine 152 & Access Drive

A part of the SE¼ of Section 26 more particularly described as follows: Commencing at the northwest corner of the SE¼ of Section 26; thence southerly 681.81 feet on the west line of the SE¼ of said Section 26; thence N.90°-00'-00"E. 386.33 feet to the Point of Beginning; thence continuing N.90°-00'-00"E.

100 feet; thence S.00°-00'-00"W. 100 feet; thence N.90°-00'-00"W. 100 feet; thence N.00°-00'-00"E. 100 feet to the Point of Beginning.

Also a tract of land 50 feet of even width lying 25 feet on each side of the following described centerline: Commencing at the southwest corner of the SE¼ of Section 26; thence easterly 25 feet on the south line of the SE¼ of said Section 26; thence northerly 87.91 feet parallel with the west line of the SE¼ of said Section 26 to the Point of Beginning at the centerline of a public road; thence continuing northerly 1834.43 feet parallel with the west line of the SE¼ of said Section 26; thence S.90°-00'-00"E. 411.35 feet to the Point of Termination.

Together with the following described tract:

Energy Collection System Group

A part of the SW¼ and a part of the SE¼ of Section 26 being a tract of land 20 feet of even width lying 10 feet on each side of the following described centerline: Commencing at the northwest corner of the SW¼ of Section 26; thence southerly 943.50 feet on the west line of the SW¼ of said Section 26 to the Point of Beginning; thence S.82°-16'-36"E. 1553.19 feet; thence S.88°-31'-52"E. 2815.88 feet; thence S.61°-09'-16"E. 1014.96 feet to the Point of Termination on the east line of the SE¼ of Section 26.

And also the following described tract:

A part of the NW¼, a part of the SW¼ and a part of the SE¼ of Section 26 being a tract of land 20 feet of even width lying 10 feet on each side of the following described centerline: Commencing at the northeast corner of the NW¼ of Section 26; thence westerly 651.98 feet on the north line of the NW¼ of said Section 26 to the Point of Beginning; thence S.06°-59'-23"E. 1005.66 feet; thence S.13°-31'-59"E. 1797.30 feet; thence S.39°-44'-45"E. 850.80 feet; thence S.70°-13'-39"E. 1377.12 feet to the Point of Termination.

And also the following described tract:

A part of the SE¼ and a part of the SW¼ of Section 26 being a tract of land 20 feet of even width lying 10 feet on each side of the following described centerline: Commencing at the northeast corner of the SE¼ of Section 26; thence southerly 308.66 feet on the east line of the SE¼ of said Section 26 to the Point of Beginning; thence N.84°-38'-09"W. 2742.80 feet to the Point of Termination.

Together with the following described tract:

Turbine 64 & Access Drive

A part of the SW¼ of Section 27 more particularly described as follows: Commencing at the southwest corner of the SW¼ of Section 27; thence easterly 1079.68 feet on the south line of the SW¼ of said Section 27; thence N.00°-00'-00"E. 1459.14 feet to the Point of Beginning; thence continuing N.00°-00'-00"E.

100 feet; thence S.90°-00'-00"E. 100 feet; thence S.00°-00'-00"W. 100 feet; thence N.90°-00'-00"W. 100 feet to the Point of Beginning.

Also a tract of land in the SW¼ of Section 27 being 50 feet of even width lying 25 feet on each side of the following described centerline: Commencing at the southwest corner of the SW¼ of Section 27; thence easterly 1318.88 feet on the south line of the SW¼ of said Section 27; thence N.00°-33'-32"W. 33.00 feet to the Point of Beginning on the centerline of a public road; thence N.00°-33'-31"W. 1480.64 feet; thence N.90°-00'-00"W. 174.41 feet to the Point of Termination.

Together with the following described tract:

Turbine 65 & Access Drive

A part of the SE¼ of Section 27 more particularly described as follows:

Commencing at the northwest corner of the SE¼ of Section 27; thence easterly 1137.40 feet on the north line of the SE¼ of said Section 27; thence S.00°-00'-00"W. 717.90 feet to the Point of Beginning; thence N.90°-00'-00"E. 100 feet; thence S.00°-00'-00"W. 100 feet; thence S.90°-00'-00"W. 100 feet; thence N.00°-00'-00"E. 100 feet to the Point of Beginning.

Also a tract of land 50 feet of even width lying 25 feet on each side of the following described centerline: Commencing at the southeast corner of the SE¼ of Section 27; thence westerly 1343.10 feet on the south line of the SE¼ of said Section 27; thence N.00°-00'-00"E. 60.79 feet to the Point of Beginning on the centerline of a public road; thence N.00°-10'-16"W. 1822.73 feet; thence N.90°-00'-00"W. 113.54 feet to the Point of Termination.

Together with the following described tract:

Turbine 77 & Access Drive

A part of the SW¼ and a part of the NW¼ of Section 27 more particularly described as follows: Commencing at the northeast corner of the SW¼ of Section 27; thence southerly 14.62 feet on the east line of the SW¼ of said Section 27; thence N.90°-00'-00"W. 559.68 feet to the Point of Beginning; thence continuing N.90°-00'-00"W. 100 feet; thence N.00°-00'-00"E. 100 feet; thence S.90°-00'-00"E. 100 feet; thence S.00°-00'-00"W. 100 feet to the Point of Beginning.

Also a tract of land 50 feet of even width lying 25 feet on each side of the following described centerline: Commencing at the northeast corner of the SW¼ of Section 27; thence southerly 14.62 feet on the east line of the SW¼ of said Section 27; thence N.90°-00'-00"W. 659.68 feet; thence N.00°-00'-00"W. 50 feet to the Point of Beginning; thence N.89°-25'-32"W. 716.07 feet; thence S.00°-33'-31"E. 1144.74 feet to the Point of Termination.

Together with the following described tract:

Turbine 86 & Access Drive

A part of the NW¼ of Section 27 more particularly described as follows:

Commencing at the northwest corner of the NW¼ of Section 27; thence easterly 595.96 feet on the north line of the NW¼ of said Section 27; thence S.00°-00'-00"E. 1500.25 feet to the Point of Beginning; thence N.90°-00'-00"E. 100 feet; thence S.00°-00'-00"W. 100 feet; thence S.90°-00'-00"W. 100 feet; thence N.00°-00'-00"W. 100 feet to the Point of Beginning.

Also a tract of land 50 feet of even width lying 25 feet on each side of the following described centerline: Commencing at the northwest corner of the NW¼ of Section 27; thence southerly 1581.40 feet on the west line of the NW¼ of said Section 27 to the Point of Beginning; thence N.90°-00'-00"E. 581.14 feet to the Point of Termination.

Together with the following described tract:

Turbine 99 & Access Drive

A part of the NE¼ of Section 27 more particularly described as follows:

Commencing at the northeast corner of the NE¼ of Section 27; thence southerly 754.78 feet on the east line of the NE¼ of said Section 27; thence N.90°-00'-00"W. 1975.22 feet to the Point of Beginning; thence continuing N.90°-00'-00"W. 100 feet; thence N.00°-00'-00"E. 100 feet; thence S.90°-00'-00"E. 100 feet; thence S.00°-00'-00"W. 100 feet to the Point of Beginning.

Also a tract of land 50 feet of even width lying 25 feet on each side of the following described centerline: Commencing at the northeast corner of the NE¼ of Section 27; thence southerly 639.87 feet on the east line of the NE¼ of said Section 27 to the Point of Beginning; thence N.89°-20'-54"W. 1353.21 feet; thence S.00°-10'-01"E. 80.31 feet; thence S.90°-00'-00"W. 622.27 feet to the Point of Termination.

Together with the following described tract:

Energy Collection System Group

A part of the NW¼ and a part of the NE¼ of Section 27 being a tract of land 20 feet of even width lying 10 feet on each side of the following described centerline: Commencing at the northwest corner of the NW¼ of Section 27; thence southerly 1532.78 feet on the west line of the NW¼ of said Section 27 to the Point of Beginning; thence S.87°-51'-35"E. 632.03 feet; thence N.73°-14'-32"E. 2765.06 feet; thence N.29°-21'-15"E. 827.64 feet to the Point of Termination on the north line of the NE¼ of Section 27.

And also the following described tract:

A part of the NW¼, a part of the SW¼ and a part of the SE¼ of Section 27 being a tract of land 20 feet of even width lying 10 feet on each side of the following described centerline: Commencing at the northwest corner of the NW¼ of

Section 27; thence southerly 1532.78 feet on the west line of the NW¼ of said Section 27; thence S.87°-51'-35"E. 632.03 feet to the Point of Beginning; thence S.52°-37'-27"E. 1783.53 feet; thence S.37°-42'-13"W. 1443.06 feet; thence N.83°-09'-28"E. 2698.72 feet; thence S.82°-16'-36"E. 1473.89 feet to the Point of Termination on the east line of the SE¼ of Section 27.

Together with the following described tract:

Turbine 85 & Access Drive

A part of the NE¼ of Section 28 more particularly described as follows:

Commencing at the northeast corner of the NE¼ of Section 28; thence westerly 708.29 feet on the north line of the NE¼ of said Section 27; thence S.00°-00'-00"W. 1448.37 feet to the Point of Beginning; thence continuing S.00°-00'-00"W. 100 feet; thence N.90°-00'-00"W. 100 feet; thence N.00°-00'-00"E. 100 feet; thence S.90°-00'-00"E. 100 feet to the Point of Beginning.

Also a part of the SW¼ of Section 27 and a part of the SE¼ of Section 28 being a tract of land 50 feet of even width lying 25 feet on each side of the following described line: Commencing at the southwest corner of the SW¼ of Section 27; thence easterly 8.50 feet on the south line of the SW¼ of Section 27 to the Point of Beginning on the centerline of a public road; thence northerly 1324.95 feet parallel with the west line of the SW¼ of said Section 27; thence S.89°-34'-24"W. 8.50 feet to the Point of Termination.

And also a part of the NE¼ and a part of the SE¼ of Section 28 being a tract of land 50 feet of even width lying 25 feet on each side of the following described centerline: Commencing at the southeast corner of the SE¼ of Section 28; thence northerly 1324.73 feet on the east line of the SE¼ of said Section 28 to the Point of Beginning; thence S.89°-34'-24"W. 25 feet; thence northerly 2364.20 feet parallel with the east line of said Section 28; thence N.90°-00'-00"E. 25.00 feet to the Point of Termination.

And also a tract of land 50 feet of even width lying 25 feet on each side of the following described centerline: Commencing at the northeast corner of NE¼ of Section 28; thence westerly 708.29 feet on the north line of the NE¼ of said Section 28; thence S.00°-00'-00"W. 1548.37 feet; thence N.90°-00'-00"W. 50 feet to the Point of Beginning; thence S.00°-00'-00"W. 259.78 feet; thence N.56°-07'-57"E. 201.48 feet; thence northeasterly 246.41 feet on a tangential curve concave to the southeast subtended by a chord of 243.35 feet bearing N.71°-28'-28"E. from the last described course; thence N.87°-09'-42"E. 350.98 feet to the Point of Termination.

And also a part of the NE¼ of Section 28 being a tract of land 50 feet of even width lying 25 feet on each side of the following described centerline: Commencing at the northeast corner of the NE¼ of Section 28; thence westerly 708.29 feet; thence S.00°-00'-00"W. 1521.56 feet to the Point of Beginning;

thence S.65°-02'-18"E. 299.60 feet; thence S.87°-09'-42"E. 126.38 feet to the Point of Termination.

Together with the following described tract:

Energy Collection System Group

A part of the NE¼ of Section 28 being a tract of land 20 feet of even width lying 10 feet on each side of the following described centerline: Commencing at the northeast corner of the NE¼ of Section 28; thence southerly 1532.78 feet on the east line of the NE¼ of said Section 28 to the Point of Beginning; thence N.87°-51'-35"W. 773.14 feet to the Point of Termination.

Together with the following described tract:

Turbine 37 & Access Drive

A part of the SE¼ of Section 33 more particularly described as follows: Commencing at the southwest corner of the SE¼ of Section 33; thence easterly 989.72 feet on the south line of the SE¼ of said Section 33; thence N.00°-00'-00"E. 435.39 feet to the Point of Beginning; thence continuing N.00°-00'-00"E. 100 feet; thence S.90°-00'-00"E. 100 feet; thence S.00°-00'-00"W. 100 feet; thence N.90°-00'-00"W. 100 feet to the Point of Beginning.

Also a tract of land 50 feet of even width lying 25 feet on each side of the following described centerline: Commencing at the southwest corner of the SE¼ of Section 33; thence easterly 1311.33 feet on the south line of the SE¼ of said Section 33 to the Point of Beginning; thence N.00°-21'-48"W. 483.00 feet; thence N.90°-00'-00"W. 218.54 feet to the Point of Termination.

Together with the following described tract:

Turbine 38 & Access Drive

A part of the SE¼ of Section 33 more particularly described as follows: Commencing at the southwest corner of the SE¼ of Section 33; thence northerly 1250.67 feet on the west line of the SE¼ of said Section 33; thence N.90°-00'-00"E. 62.92 feet to the Point of Beginning; thence N.00°-00'-00"W. 100 feet; thence S.90°-00'-00"E. 100 feet; thence S.00°-00'-00"W. 100 feet; thence S.90°-00'-00"W. 100 feet to the Point of Beginning.

Also a tract of land 50 feet of even width lying 25 feet on each side of the following described centerline: Commencing at the southwest corner of the SE¼ of Section 33; thence easterly 1311.33 feet on the south line of the SE¼ of said Section 33; thence N.00°-21'-48"W. 483.00 feet to the Point of Beginning; thence continuing N.00°-21'-48"W. 811.21 feet; thence S.90°-00'-00"W. 1148.43 feet to the Point of Termination.

Together with the following described tract:

Turbine 141 & Access Drive

A part of the SE¼ of Section 33 more particularly described as follows: Commencing at the southeast corner of the SE¼ of Section 33; thence northerly

413.95 feet on the east line of the SE $\frac{1}{4}$ of said Section 33; thence N.90°-00'-00"W. 125.81 feet to the Point of Beginning; thence continuing N.90°-00'-00"W. 100 feet; thence N.00°-00'-00"E. 100 feet; thence S.90°-00'-00"E. 100 feet; thence S.00°-00'-00"W. 100 feet to the Point of Beginning.

Also a tract of land 50 feet of even width lying 25 feet on each side of the following described centerline: Commencing at the southwest corner of the SE $\frac{1}{4}$ of Section 33; thence easterly 1311.33 feet on the south line of the SE $\frac{1}{4}$ of said Section 33; thence N.00°-21'-48"W. 25 feet to the Point of Beginning; thence easterly 1364.44 feet parallel with the south line of the SE $\frac{1}{4}$ of Section 33 to the Point of Termination on the east line of the SE $\frac{1}{4}$ of Section 33.

And also a tract of land 50 feet of even width lying 25 feet on each side of the following described centerline: Commencing at the southeast corner of the SE $\frac{1}{4}$ of Section 33; thence northerly 25 feet on the east line of the SE $\frac{1}{4}$ of said Section 33; thence westerly 178.91 feet parallel with the south line of the SE $\frac{1}{4}$ of said Section 33 to the Point of Beginning; thence N.00°-00'-00"W. 388.87 feet to the Point of Termination.

And also a tract of land in the SW $\frac{1}{4}$ of Section 34 being the South 50 feet of the SW $\frac{1}{4}$ of Section 34 lying west of the southwesterly right of way line of U.S. Route 150.

Together with the following described tract:

Energy Collection System Group

A part of the SE $\frac{1}{4}$ of Section 33 being a tract of land 20 feet of even width lying 10 feet on each side of the following described centerline: Commencing at the southeast corner of the SE $\frac{1}{4}$ of Section 33; thence northerly 1254.02 feet on the east line of the SE $\frac{1}{4}$ of Section 33 to the Point of Beginning on the northeasterly right of way line of U.S. Route 150; thence S.75°-30'-51"W. 205.11 feet; thence S.02°-16'-24"E. 742.89 feet; thence N.89°-30'-59"W. 1457.43 feet; thence N.49°-03'-48"W. 1236.50 feet to the Point of Termination.

Together with the following described tract:

Turbine 36 & Access Drive

A part of the SW $\frac{1}{4}$ of Section 34 more particularly described as follows: Commencing at the northwest corner of the SW $\frac{1}{4}$ of Section 34; thence southerly 1027.28 feet on the west line of the SW $\frac{1}{4}$ of said Section 34; thence N.90°-00'-00"E. 1598.66 feet to the Point of Beginning; thence N.00°-00'-00"E. 100 feet; thence S.90°-00'-00"E. 100 feet; thence S.00°-00'-00"W. 100 feet; thence S.90°-00'-00"W. 100 feet to the Point of Beginning.

Also a tract of land 50 feet of even width lying 25 feet on each side of the following described centerline: Commencing at the northwest corner of the SW $\frac{1}{4}$ of Section 34; thence southerly 1476.59 feet on the west line of the SW $\frac{1}{4}$ of said Section 34; thence S.89°-12'-38"E. 54.33 feet to the Point of Beginning on the

northeasterly right of way line of U.S. Route 150; thence continuing S.89°-12'-58"E. 1590.90 feet; thence N.00°-00'-00"E. 521.88 feet to the Point of Termination.

And also a tract of land 50 feet of even width lying 25 feet on each side of the following described centerline: Commencing at the northwest corner of the SW¼ of Section 34; thence southerly 1476.59 feet on the west line of the SW¼ of said Section 34; thence S.89°-12'-58"E. 1645.23 feet to the Point of Beginning; thence continuing S.89°-12'-58"E. 948.80 feet to a point 25 feet west of the east line of the SW¼ of said Section 34; thence northerly 163.66 feet parallel with the east line of the SW¼ of said Section 34; thence S.89°-09'-36"E. 25 feet to the Point of Termination on the east line of the SW¼ of Section 34.

Together with the following described tract:

Turbine 39 & Access Drive

A part of the SE¼ of Section 34 more particularly described as follows: Commencing at the southeast corner of the SE¼ of Section 34; thence westerly 1542.36 feet on the south line of the SE¼ of said Section 34; thence N.00°-00'-00"E. 957.08 feet to the Point of Beginning; thence N.90°-00'-00"W. 100 feet; thence N.00°-00'-00"E. 100 feet; thence S.90°-00'-00"E. 100 feet; thence S.00°-00'-00"W. 100 feet to the Point of Beginning.

Also a tract of land 50 feet of even width lying 25 feet on each side of the following described centerline: Commencing at the southeast corner of the SE¼ of Section 34; thence northerly 1299.69 feet on the east line of the SE¼ of said Section 34 to the Point of Beginning; thence N.89°-09'-36"W. 1593.33 feet; thence S.00°-00'-00"E. 293.15 feet to the Point of Termination.

Together with the following described tract:

Turbine 58 & Access Drive

A part of the NE¼ of Section 34 more particularly described as follows: Commencing at the northeast corner of the NE¼ of Section 34; thence southerly 1404.05 feet on the east line of the NE¼ of said Section 34; thence N.90°-00'-00"W. 468.49 feet to the Point of Beginning; thence S.00°-00'-00"E. 100 feet; thence S.90°-00'-00"W. 100 feet; thence N.00°-00'-00"E. 100 feet; thence S.90°-00'-00"E. 100 feet to the Point of Beginning.

Also a tract of land 50 feet of even width lying 25 feet on each side of the following described centerline: Commencing at the northeast corner of the NE¼ of Section 34; thence southerly 1454.05 feet on the east line of the NE¼ of said Section 34 to the Point of Beginning; thence S.90°-00'-00"W. 468.51 feet to the Point of Termination.

Together with the following described tract:

Turbine 59 & Access Drive

A part of the NE¼ of Section 34 more particularly described as follows:

Commencing at the southwest corner of the NE¼ of Section 34; thence easterly 457.87 feet on the south line of the NE¼ of said Section 34; thence N.00°-00'-00"E. 1152.03 feet to the Point of Beginning; thence continuing N.00°-00'-00"E. 100 feet; thence S.90°-00'-00"E. 100 feet; thence S.00°-00'-00"W. 100 feet; thence S.90°-00'-00"W. 100 feet to the Point of Beginning.

Also a tract of land in the NW¼ and in the NE¼ of Section 34 and in the SW¼ and in the SE¼ of Section 27 being 50 feet of even width lying 25 feet on each side of the following described centerline: Beginning 25 feet east of the intersection of the west line of the SE¼ of Section 27 with the centerline of the public road lying 53 feet north of the northwest corner of the NE¼ of Section 34; thence southerly 53 feet to the north line of the NE¼ of said Section 34; thence southerly 1328.21 feet parallel with the west line of the NE¼ of said Section 34; thence N.89°-10'-58"W. 33.52 feet; thence S.00°-13'-26"E. 137.23 feet parallel with the west line of the NE¼ of said Section 34; thence N.90°-00'-00"E. 537.49 feet to the Point of Termination.

Together with the following described tract:

Turbine 60 & Access Drive

A part of the NW¼ of Section 34 more particularly described as follows:

Commencing at the northwest corner of the NW¼ of Section 34; thence southerly 1935.30 feet on the west line of the NW¼ of said Section 34; thence N.90°-00'-00"E. 1293.87 feet to the Point of Beginning; thence continuing N.90°-00'-00"E. 100 feet; thence S.00°-00'-00"E. 100 feet; thence S.90°-00'-00"W. 100 feet; thence N.00°-00'-00"E. 100 feet to the Point of Beginning.

Also a tract of land 50 feet of even width lying 25 feet on each side of the following described centerline: Commencing at the northeast corner of the NW¼ of Section 34; thence southerly 1303.31 feet on the east line of the NW¼ of said Section 34; thence westerly 8.50 feet on the south line of the NE¼ of the NW¼ of said Section 34; thence S.00°-13'-25"E. 162.23 feet parallel with the west line of the NE¼ of said Section 34 to the Point of Beginning; thence continuing S.00°-13'-25"E. 471.06 feet parallel with the west line of the NE¼ of Section 34; thence N.90°-00'-00"W. 1275.37 feet to the Point of Termination.

Together with the following described tract:

Turbine 47 & Access Drive

A part of the SW¼ of Section 34 more particularly described as follows:

Commencing at the northeast corner of the SW¼ of Section 34; thence westerly 122.91 feet on the north line of the SW¼ of said Section 34; thence S.00°-00'-00"E. 77.72 feet to the Point of Beginning; thence N.90°-00'-00"E. 100 feet; thence S.00°-00'-00"W. 100 feet; thence N.90°-00'-00"W. 100 feet; thence N.00°-00'-00"W. 100 feet to the Point of Beginning.

Also a tract of land in the NW¼ and in the SW¼ of Section 34 being 50 feet of even width lying 25 feet on each side of the following described centerline: Commencing at the northeast corner of the NW¼ of Section 34; thence southerly 1303.31 feet on the east line of the NW¼ of said Section 34; thence westerly 8.50 feet on the south line of the NE¼ of the NW¼ of said Section 34; thence S.00°-13'-25"E. 633.29 feet parallel with the east line of the NW¼ of said Section 34 to the Point of Beginning; thence continuing S.00°-13'-25"E. 720.67 feet parallel with the east line of the NW¼ of said Section 34; thence S.16°-52'-50"W. 141.86 feet to the Point of Termination.

Together with the following described tract:

Turbine 154 & Access Drive

A part of the SE¼ of Section 34 more particularly described as follows: Commencing at the northeast corner of the SE¼ of Section 34; thence easterly 87.10 feet on the north line of the SE¼ of said Section 34; thence S.00°-00'-00"E. 930.45 feet to the Point of Beginning; thence N.90°-00'-00"E. 100 feet; thence S.00°-00'-00"W. 100 feet; thence S.90°-00'-00"W. 100 feet; thence N.00°-00'-00"W. 100 feet to the Point of Beginning.

Also a tract of land 50 feet of even width lying 25 feet on each side of the following described centerline: Commencing at the northwest corner of the SE¼ of Section 34; thence southerly 1299.24 feet on the west line of the SE¼ of said Section 34 to the Point of Beginning; thence S.89°-09'-36"E. 173.54 feet; thence N.00°-00'-00"W. 319.66 feet to the Point of Termination.

Together with the following described tract:

Energy Collection System Group

A part of the SW¼ and a part of the SE¼ of Section 34 being a tract of land 20 feet of even width lying 10 feet on each side of the following described centerline: Commencing at the southwest corner of the SW¼ of Section 34; thence northerly 1254.02 feet on the west line of the SW¼ of said Section 34 to the Point of Beginning on the northeasterly right of way line of U.S. Route 150; thence N.75°-30'-51"E. 1699.67 feet; thence S.87°-14'-24"E. 1122.89 feet; thence S.52°-26'-19"E. 1108.40 feet; thence S.84°-19'-56"E. 1660.69 feet to the Point of Termination on the east line of the SE¼ of Section 34.

And also the following described tract:

A part of the SE¼ of Section 34 being a tract of land 20 feet of even width lying 10 feet on each side of the following described centerline: Commencing at the southeast corner of the SE¼ of Section 34; thence westerly 1745.52 feet on the south line of the SE¼ of said Section 34 to the Point of Beginning; thence N.08°-40'-19"E. 1015.69 feet to the Point of Termination.

And also the following described tract:

A part of the SW $\frac{1}{4}$, a part of the NW $\frac{1}{4}$ and a part of the NE $\frac{1}{4}$ of Section 34 being a tract of land 20 feet of even width lying 10 feet on each side of the following described centerline: Commencing at the southwest corner of the SW $\frac{1}{4}$ of Section 34; thence northerly 1254.02 feet on the west line of the SW $\frac{1}{4}$ of said Section 34 to the northeasterly right of way line of U.S. Route 150; thence N.75°-30'-51"E. 1699.67 feet to the Point of Beginning; thence N.10°-55'-10"W. 1682.43 feet; thence N.75°-25'-13"E. 1871.28 feet; thence S.88°-38'-12"E. 1583.37 feet; thence S.89°-51'-36"E. 518.52 feet to the Point of Termination on the east line of NE $\frac{1}{4}$ of said Section 34.

Together with the following described tract:

Turbine 41 & Access Drive

A part of the SW $\frac{1}{4}$ and a part of the SE $\frac{1}{4}$ of Section 35 more particularly described as follows: Commencing at the southeast corner of the SE $\frac{1}{4}$ of Section 35; thence westerly 2704.29 feet on the south line of the SE $\frac{1}{4}$ of said Section 35; thence N.00°-00'-00"E. 616.24 feet to the Point of Beginning; thence N.90°-00'-00"W. 100 feet; thence N.00°-00'-00"W. 100 feet; thence S.90°-00'-00"E. 100 feet; thence S.00°-00'-00"W. 100 feet to the Point of Beginning.

Also a tract of land 50 feet of even width lying 25 feet on each side of the following described centerline: Commencing at the southeast corner of the SE $\frac{1}{4}$ of Section 35; thence westerly 2641.34 feet on the south line of said Section 35 to the Point of Beginning; thence N.00°-01'-02"E. 667.24 feet; thence N.90°-00'-00"W. 113.14 feet to the Point of Termination.

Together with the following described tract:

Turbine 45 & Access Drive

A part of the SE $\frac{1}{4}$ of Section 35 more particularly described as follows: Commencing at the southeast corner of the SE $\frac{1}{4}$ of Section 35; thence northerly 2170.94 feet on the east line of the SE $\frac{1}{4}$ of said Section 35; thence N.90°-00'-00"W. 432.57 feet to the Point of Beginning; thence continuing N.90°-00'-00"W. 100 feet; thence N.00°-00'-00"E. 100 feet; thence S.90°-00'-00"E. 100 feet; thence S.00°-00'-00"W. 100 feet to the Point of Beginning.

Also a tract of land 50 feet of even width lying 25 feet on each side of the following described centerline: Commencing at the northeast corner of the SE $\frac{1}{4}$ of Section 35; thence southerly 25 feet on the east line of the SE $\frac{1}{4}$ of said Section 35 to the Point of Beginning; thence westerly 1334.87 feet parallel with the north line of the SE $\frac{1}{4}$ of said Section 35 to the Point of Termination.

And also a tract of land 50 feet of even width lying 25 feet on each side of the following described centerline: Commencing at the northeast corner of the SE $\frac{1}{4}$ of Section 35; thence southerly 25 feet on the east line of the SE $\frac{1}{4}$ of said Section 35; thence westerly 483.41 feet parallel with the north line of the SE $\frac{1}{4}$ of

said Section 35 to the Point of Beginning; thence S.00°-00'-00"E. 371.25 feet to the Point of Termination.

Together with the following described tract:

Turbine 46 & Access Drive

A part of the SW¼ of Section 35 more particularly described as follows: Commencing at the northeast corner of the SW¼ of Section 35; thence westerly 733.22 feet on the north line of the SW¼ of said Section 35; thence S.00°-00'-00"E. 316.17 feet to the Point of Beginning; thence continuing S.00°-00'-00"E. 100 feet; thence S.90°-00'-00"W. 100 feet; thence N.00°-00'-00"E. 100 feet; thence N.90°-00'-00"E. 100 feet to the Point of Beginning.

Also a tract of land in the SW¼, in the SE¼ and in the NE¼ of Section 35 being a tract of land 50 feet of even width lying 25 feet on each side of the following described centerline: Commencing at the northeast corner of the SW¼ of Section 35; thence westerly 733.22 feet on the north line of the SW¼ of said Section 35; thence S.00°-00'-00"E. 352.21 feet to the Point of Beginning; thence N.74°-25'-18"E. 1602.57 feet to the Point of Termination.

Together with the following described tract:

Turbine 49 & Access Drive

A part of the NE¼ of Section 35 more particularly described as follows: Commencing at the southwest corner of the NE¼ of Section 35; thence easterly 810.62 feet on the south line of the NE¼ of said Section 35; thence N.00°-00'-00"E. 64.42 feet to the Point of Beginning; thence continuing N.00°-00'-00"E. 100 feet; thence N.90°-00'-00"E. 100 feet; thence S.00°-00'-00"W. 100 feet; thence S.90°-00'-00"W. 100 feet to the Point of Beginning.

Also a tract of land in the NE¼ of Section 35 and in the SE¼ of Section 35 being a tract of land 50 feet of even width lying 25 feet on each side of the following described centerline: Commencing at the southeast corner of the NE¼ of Section 35; thence southerly 25 feet on the east line of SE¼ of said Section 35; thence westerly 1334.87 feet parallel with the south line of the NE¼ of said Section 35 to the Point of Beginning; thence N.00°-13'-14"W. 146.59 feet; thence N.90°-00'-00"W. 373.85 feet to the Point of Termination.

Together with the following described tract:

Turbine 57 & Access Drive

A part of the NW¼ of Section 35 more particularly described as follows: Commencing at the northeast corner of the NW¼ of Section 35; thence westerly 280.72 feet on the north line of the NW¼ of said Section 35; thence S.00°-00'-00"E. 1387.15 feet to the Point of Beginning; thence continuing S.00°-00'-00"E. 100 feet; thence S.90°-00'-00"W. 100 feet; thence N.00°-00'-00"W. 100 feet; thence N.90°-00'-00"E. 100 feet to the Point of Beginning.

Also a tract of land in the SW¼ of Section 26 and in the NW¼ of Section 35 being 50 feet of even width lying 25 feet on each side of the following described centerline: Commencing at the southeast corner of the SW¼ of Section 26; thence northerly 87.91 feet on the east line of the SW¼ of said Section 26 to the centerline of a public road; thence westerly 25 feet on the centerline of said public road to the Point of Beginning; thence southerly 1521.66 feet parallel with said east line of the SW¼ of Section 26 and the east line of the NW¼ of said Section 35; thence N.90°-00'-00"W. 253.78 feet to the Point of Termination.

Together with the following described tract:

Turbine 157 & Access Drive

A part of the SW¼ of Section 35 more particularly described as follows: Commencing at the northeast corner of the SW¼ of Section 35; thence westerly 1215.54 feet on the north line of the SW¼ of said Section 35; thence S.00°-00'-00"E. 1148.88 feet to the Point of Beginning; thence continuing S.00°-00'-00"E. 100 feet; thence S.90°-00'-00"W. 100 feet; thence N.00°-00'-00"E. 100 feet; thence S.90°-00'-00"E. 100 feet to the Point of Beginning.

Also a tract of land 50 feet of even width lying 25 feet on each side of the following described centerline: Commencing at the southwest corner of the SW¼ of Section 35; thence northerly 1349.69 feet on the west line of the SW¼ of said Section 35 to the Point of Beginning; thence S.89°-11'-27"E. 1350.47 feet; thence N.00°-00'-00"W. 52.59 feet to the Point of Termination.

Together with the following described tract:

Energy Collection System Group

A part of the SW¼ and a part of the SE¼ of Section 35 being a tract of land 20 feet of even width lying 10 feet on each side of the following described centerline: Commencing at the southwest corner of the SW¼ of Section 35; thence northerly 871.82 feet on the west line of the SW¼ of said Section 35 to the Point of Beginning; thence S.84°-20'-17"E. 2489.54 feet; thence N.58°-29'-29"E. 3234.95 feet to the Point of Termination on the east line of the SE¼ of Section 35.

And also the following described tract:

A part of the SW¼ and a part of the SE¼ of Section 35 being a tract of land 20 feet of even width lying 10 feet on each side of the following described centerline: Commencing at the southwest corner of the SW¼ of Section 35; thence easterly 2191.65 feet on the south line of the SW¼ of said Section 35 to the Point of Beginning; thence N.23°-27'-04"E. 720.41 feet; thence N.54°-23'-07"W. 1385.96 feet to the Point of Termination.

And also the following described tract:

A part of the SE¼, a part of the NE¼ and a part of the NW¼ of Section 35 being a tract of land 20 feet of even width lying 10 feet on each side of the following

described centerline: Commencing at the northeast corner of the SE¼ of Section 35; thence southerly 173.77 feet on the east line of the SE¼ of said Section 35 to the Point of Beginning; thence S.61°-14'-16"W. 551.10 feet; thence N.65°-31'-33"W. 1401.72 feet; thence N.46°-42'-38"W. 1631.63 feet; thence N.89°-51'-36"W. 2288.32 feet to the Point of Termination on the west line of the NW¼ of said Section 35.

Together with the following described tract:

Turbine 42 & Access Drive

A part of the SE¼ of Section 36 more particularly described as follows: Commencing at the southeast corner of the SE¼ of Section 36; thence northerly 1064.66 feet on the east line of the SE¼ of said Section 36; thence N.90°-00'-00"W. 2068.74 feet to the Point of Beginning; thence continuing N.90°-00'-00"W. 100 feet; thence N.00°-00'-00"E. 100 feet; thence S.90°-00'-00"E. 100 feet; thence S.00°-00'-00"W. 100 feet to the Point of Beginning.

Also a tract of land 50 feet of even width lying 25 feet on each side of the following described centerline: Commencing at the southeast corner of the SE¼ of Section 36; thence westerly 2117.80 feet on the south line of the SE¼ of said Section 36 to the Point of Beginning; thence N.00°-00'-00"W. 1031.63 feet to the Point of Termination.

Together with the following described tract:

Turbine 44 & Access Drive

A part of the SW¼ of Section 36 more particularly described as follows: Commencing at the northeast corner of the SW¼ of Section 36; thence westerly 221.60 feet on the north line of the SW¼ of said Section 36; thence S.00°-00'-00"E. 831.60 feet to the Point of Beginning; thence continuing S.00°-00'-00"E. 100 feet; thence S.90°-00'-00"W. 100 feet; thence N.00°-00'-00"E. 100 feet; thence S.90°-00'-00"E. 100 feet to the Point of Beginning.

Also a tract of land 50 feet of even width lying 25 feet on each side of the following described centerline: Commencing at the northeast corner of the SW¼ of Section 36; thence westerly 25 feet on the north line of the SW¼ of said Section 36 to the Point of Beginning; thence southerly 904.45 feet parallel with the east line of the SW¼ of Section 36; thence N.90°-00'-00"W. 195.35 feet to the Point of Termination.

Together with the following described tract:

Turbine 50 & Access Drive

A part of the NW¼ of Section 36 more particularly described as follows: Commencing at the southwest corner of the NW¼ of Section 36; thence northerly 216.43 feet on the west line of the NW¼ of said Section 36; thence N.90°-00'-00"E. 1221.96 feet to the Point of Beginning; thence N.00°-00'-00"E. 100 feet; thence S.90°-00'-00"E. 100 feet; thence S.00°-00'-00"W. 100 feet; thence S.90°-00'-00"W. 100 feet to the Point of Beginning.

Also a tract of land 50 feet of even width lying 25 feet on each side of the following described centerline: Commencing at the southwest corner of the NW¼ of Section 36; thence northerly 25 feet on the west line of the NW¼ of said Section 36 to the Point of Beginning; thence easterly 2616.66 feet parallel with the south line of the NW¼ of said Section 36 to the Point of Termination on the east line of the NW¼ of Section 36.

And also a tract of land 50 feet of even width lying 25 feet on each side of the following described centerline: Commencing at the southwest corner of the NW¼ of Section 36; thence northerly 25 feet on the west line of the NW¼ of said Section 36; thence easterly 1272.33 feet parallel with the south line of the NW¼ of said Section 36 to the Point of Beginning; thence N.00°-00'-00"W. 203.89 feet to the Point of Termination.

Together with the following described tract:

Turbine 54 & Access Drive

A part of the NE¼ of Section 36 more particularly described as follows: Commencing at the northeast corner of the NE¼ of Section 36; thence southerly 886.33 feet on the east line of the NE¼ of said Section 36; thence N.90°-00'-00"W. 439.15 feet to the Point of Beginning; thence S.00°-00'-00"E. 100 feet; thence N.90°-00'-00"W. 100 feet; thence N.00°-00'-00"E. 100 feet; thence S.90°-00'-00"E. 100 feet to the Point of Beginning.

Also a tract of land being a part of the SE¼ of Section 25 and a part of the NE¼ of Section 36 being 50 feet of even width lying 25 feet on each side of the following described centerline: Commencing at the northeast corner of the NE¼ of Section 36; thence northerly 171.52 feet on the east line of the SE¼ of said Section 25 to the centerline of a public road; thence westerly 493.81 feet on said public road centerline to the Point of Beginning; thence S.00°-00'-00"E. 168.15 feet to the north line of the NE¼ of said Section 36; thence continuing S.00°-00'-00"E. 888.21 feet to the Point of Termination.

Together with the following described tract:

Turbine 55 & Access Drive

A part of the NE¼ of Section 36 more particularly described as follows: Commencing at the southwest corner of the NE¼ of Section 36; thence northerly 950.47 feet on the west line of the NE¼ of said Section 36; thence N.90°-00'-00"E. 303.70 feet to the Point of Beginning; thence N.00°-00'-00"E. 100 feet; thence S.90°-00'-00"E. 100 feet; thence S.00°-00'-00"W. 100 feet; thence S.90°-00'-00"W. 100 feet to the Point of Beginning.

Also a tract of land 50 feet of even width lying 25 feet on each side of the following described centerline: Commencing at the southwest corner of the NE¼ of Section 36; thence northerly 25 feet on the west line of the NE¼ of said Section 36 to the Point of Beginning; thence easterly 380.03 feet parallel with the

south line of the NE¼ of said Section 36; thence N.00°-00'-00"E. 929.03 feet to the Point of Termination.

Together with the following described tract:

Energy Collection System Group

A part of the NE¼ of Section 36 being a tract of land 20 feet of even width lying 10 feet on each side of the following described centerline: Commencing at the northeast corner of the NE¼ of Section 36; thence southerly 462.15 feet on the east line of the NE¼ of said Section 36 to the Point of Beginning; thence N.82°-41'-07"W. 708.82 feet; thence S.22°-00'-16"E. 599.34 feet; thence S.45°-53'-02"E. 680.50 feet to the Point of Termination on the east line of the NE¼ of Section 36.

And also the following described tract:

A part of the SE¼ and a part of the NE¼ of Section 36 being a tract of land 20 feet of even width lying 10 feet on each side of the following described centerline: Commencing at the southeast corner of the SE¼ of Section 36; thence westerly 2089.09 feet on the south line of the SE¼ of said Section 36 to the Point of Beginning; thence N.01°-31'-11"W. 1082.46 feet; thence N.11°-41'-02"E. 3966.07 feet to the Point of Termination.

And also the following described tract:

A part of the SW¼ and a part of the NW¼ of Section 36 being a tract of land 20 feet of even width lying 10 feet on each side of the following described centerline: Commencing at the northwest corner of the SW¼ of Section 36; thence southerly 260.73 feet on the west line of the SW¼ of Section 36 to the Point of Beginning; thence N.58°-29'-29"E. 551.85 feet; thence N.73°-25'-38"E. 837.05 feet; thence S.42°-29'-19"E. 1588.34 feet to the Point of Termination.

And also the following described tract:

A part of the NW¼ and a part of the NE¼ of Section 36 being a tract of land 20 feet of even width lying 10 feet on each side of the following described centerline: Commencing at the northwest corner of the SW¼ of Section 36; thence southerly 260.73 feet on the west line of the SW¼ of said Section 36; thence N.58°-29'-29"E. 551.85 feet; thence N.73°-25'-38"E. 837.05 feet to the Point of Beginning; thence N.67°-21'-52"E. 1841.31 feet; thence N.27°-46'-55"E. 1448.33 feet to the Point of Termination.

And also the following described tract:

A part of the SW¼, a part of the NW¼ and a part of the NE¼ of Section 36 being a tract of land 20 feet of even width lying 10 feet on each side of the following described centerline: Commencing at the northwest corner of the SW¼ of

Section 36; thence southerly 173.77 feet on the west line of the SW¼ of said Section 36 to the Point of Beginning; thence N.61°-14'-16"E. 3152.75 feet; thence N.36°-35'-11"E. 1136.53 feet to the Point of Termination.

And also the following described tract:

A part of the NW¼ and a part of the NE¼ of Section 36 being a tract of land 20 feet of even width lying 10 feet on each side of the following described centerline: Commencing at the northwest corner of the NW¼ of Section 36; thence easterly 2746.12 feet on the north line of said Section 36 to the Point of Beginning; thence S.72°-10'-29"E. 127.71 feet; thence S.84°-58'-28"E. 562.34 feet to the Point of Termination.

Together with the following described tract:

Energy Collection Substation

A part of the NE¼ of Section 36 and a part of the SE¼ of Section 25 more particularly described as follows: Commencing at the southeast corner of the SE¼ of Section 25; thence northerly 171.52 feet on the east line of the SE¼ of said Section 25 to the centerline of a public road; thence westerly 725.53 feet on the centerline of said public road to the Point of Beginning; thence S.00°-07'-42"E. 550.00 feet; thence S.89°-49'-36"W. 1100.00 feet; thence N.00°-07'-42"W. 550.00 feet to the centerline of a public road; thence easterly 1100.00 feet on said public road centerline to the Point of Beginning.

Together with the following described tract:

Construction Staging Area

The South 59 feet of the East 700 feet of the SE¼ of Section 27 and the North 641 feet of the East 700 feet of the NE¼ of Section 34, EXCEPT the East 150 feet of the North 320 feet thereof.

Said land area herein described in White Oak Township containing 250 acres, more or less.

WHITE OAK WIND ENERGY CENTER ENTERPRISE ZONE MAP EXHIBIT

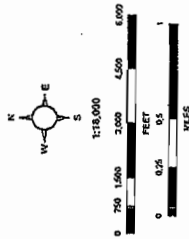

- LEGEND**
- TURBINE LOCATION
 - HIGH VOLTAGE LINE
 - CURRENT MCLEAN COUNTY ENTERPRISE ZONE BOUNDARY LIMITS
 - WHITE OAK WIND ENERGY CENTER ENTERPRISE ZONE ADDITION
 - CORPORATION LIMITS
 - COUNTY BOUNDARY

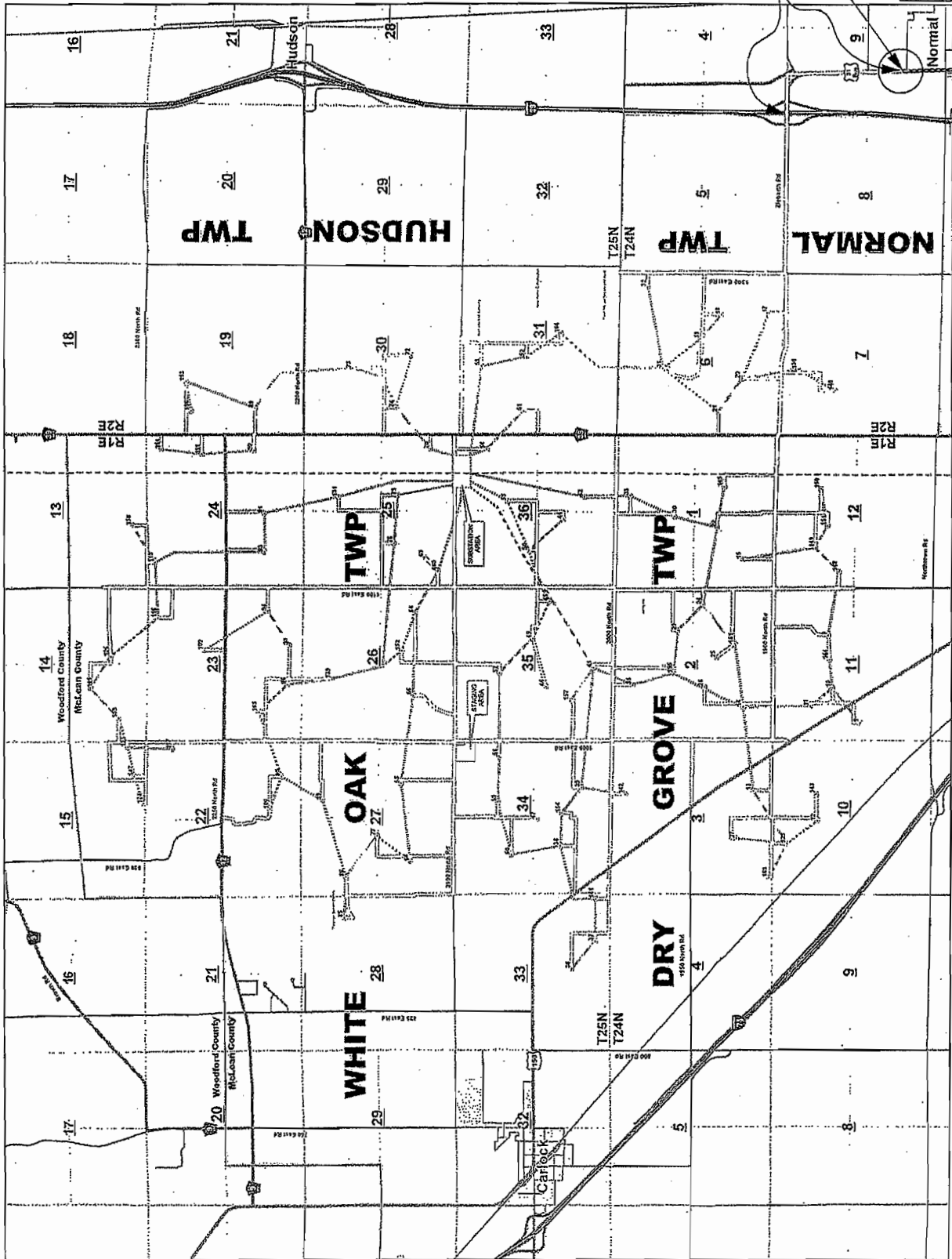

01/29/2009
Lewis, Yockey & Brown, Inc.
 Consulting Engineers & Land Surveyors
 1000 E. Main Street, Suite 200
 Normal, IL 61761
 P: 309.252.2200
 F: 309.252.2201
 E: info@lyb.com

An EMERGENCY APPROPRIATION Ordinance
Amending the McLean County Fiscal Year 2008
Combined Annual Appropriation and Budget Ordinance

WHEREAS, the McLean County Board, on November 20, 2007, adopted the Combined Annual Appropriation and Budget Ordinance, which sets forth the revenues and expenditures deemed necessary to meet and defray all legal liabilities and expenditures to be incurred by and against the County of McLean for the 2008 Fiscal Year beginning January 1, 2008 and ending December 31, 2008; and.

WHEREAS, the Combined Annual Appropriation and Budget Ordinance includes the operating budget for the McLean County General Fund 0001 and,

WHEREAS, the Finance Committee at its regular meeting on March 3, 2009, approved and recommended to the County Board an Emergency Appropriation Ordinance; now, therefore,

BE IT ORDAINED by the McLean County Board as follows:

1. That the County Auditor is directed to add to the appropriation budget of the County General Fund 0001 the following appropriation:

	<u>ADOPTED</u>	<u>ADD</u>	<u>AMENDED</u>
County Information Services			
Unapprop Fund Balance 0001-0043-0047 0400-0000	\$0	\$8,322	\$8,322
Purchase / Computer Equip. 0001-0043-0047 0833-0002	\$220,386	\$8,322	\$228,708
County Recorder			
Unapprop Fund Balance 0001-0006-0008 0400-0000	\$0	\$1,676	\$1,676
Purchase / Computer Equip. 0001-0006-0008 0832-0001	\$24,538	\$1,676	\$26,214

2. That the County Clerk shall provide a Certified Copy of this Ordinance to the County Administrator, County Auditor, and County Treasurer.

ADOPTED by the McLean County Board the 17th day of March 2009.

ATTEST:

APPROVED:

Peggy Ann Milton, Clerk of the County Board
McLean County, Illinois

Matt Sorensen, Chairman
McLean County Board

An EMERGENCY APPROPRIATION Ordinance
Amending the McLean County Fiscal Year 2009
Combined Annual Appropriation and Budget Ordinance

WHEREAS, the McLean County Board, on November 18, 2008, adopted the Combined Annual Appropriation and Budget Ordinance, which sets forth the revenues and expenditures deemed necessary to meet and defray all legal liabilities and expenditures to be incurred by and against the County of McLean for the 2009 Fiscal Year beginning January 1, 2009 and ending December 31, 2009; and.

WHEREAS, the Combined Annual Appropriation and Budget Ordinance includes the operating budget for the McLean County General Fund 0001 and,

WHEREAS, the Finance Committee at its regular meeting on March 3, 2009, approved and recommended to the County Board an Emergency Appropriation Ordinance; now, therefore,

BE IT ORDAINED by the McLean County Board as follows:

1. That the County Auditor is directed to add to the appropriation budget of the County General Fund 0001 the following appropriation:

	<u>ADOPTED</u>	<u>SUBTRACT</u>	<u>AMENDED</u>
County Information Services			
Unapprop Fund Balance			
0001-0043-0047 0400-0000	\$0	(\$8,322)	(\$8,322)
Purchase / Computer Equip.			
0001-0043-0047 0833-0002	\$112,455	(\$8,322)	\$104,133
County Recorder			
Unapprop Fund Balance			
0001-0006-0008 0400-0000	\$0	(\$1,676)	(\$1,676)
Purchase / Computer Equip.			
0001-0006-0008 0832-0001	\$6,016	(\$1,676)	\$4,340

2. That the County Clerk shall provide a Certified Copy of this Ordinance to the County Administrator, County Auditor, and County Treasurer.

ADOPTED by the McLean County Board the 17th day of March 2009.

ATTEST:

APPROVED:

Peggy Ann Milton, Clerk of the County Board
McLean County, Illinois

Matt Sorensen, Chairman
McLean County Board

**An EMERGENCY APPROPRIATION Ordinance
Amending the McLean County Fiscal Year 2009
Combined Annual Appropriation and Budget Ordinance
General Fund 0001
Sheriff's Department 0029**

WHEREAS, the McLean County Board, on November 18, 2008 adopted the Combined Annual Appropriation and Budget Ordinance, which sets forth the revenues and expenditures deemed necessary to meet and defray all legal liabilities and expenditures to be incurred by and against the County of McLean for the 2009 Fiscal Year beginning January 1, 2009 and ending December 31, 2009; and,

WHEREAS, the Combined Annual Appropriation and Budget Ordinance includes the operating budget for the Sheriff's Department 0029; and,

WHEREAS, during the 2008 Fiscal Year, the Sheriff's Department received a State Criminal Alien Assistance Program (SCAAP) grant from the Bureau of Justice Assistance, U.S. Department of Justice; and,

WHEREAS, pursuant to the U.S. Department of Justice Reauthorization Act of 2005 (Pub. L. 109-162, Title XI), SCAAP grant funds must be used for correctional purposes only, including technology involving offender management and inter-agency information sharing; and,

WHEREAS, the Sheriff's Department used the SCAAP grant funds to install a new data line between the Inmate Visiting System in the Adult Detention Facility and the Public Defender's Office and the Court Services Department; and,

WHEREAS, the purpose of this project is to permit the Public Defender's Office to consult with their clients being held in the Adult Detention Facility to prepare for trial and to expedite court proceedings; and,

WHEREAS, the purpose of this project is to permit the Court Services Department to consult with adjudicated offenders who are being held in the Adult Detention Facility while awaiting sentencing to expedite the preparation of the Pre-Trial Sentence Investigation Report, thereby reducing the time between conviction and sentencing; and,

WHEREAS, the Sheriff's Department was not able to complete this grant funded project during the 2008 Fiscal Year and now seeks approval to amend the 2009 Fiscal Year Combined Annual Appropriation and Budget Ordinance in order to appropriate the 2008 SCAAP grant funds and recognize the expenditure incurred in the 2009 Fiscal Year; and,

WHEREAS, since the 2008 SCAAP grant funds were not expended during the 2008 Fiscal Year, the 2008 SCAAP Funds, as of December 31, 2008, have been added to fund balance in the General Fund; and,

WHEREAS, the Justice Committee, at its regular meeting on Tuesday, March 3, 2009, approved and recommended to the County Board an Emergency Appropriation Ordinance to recognize the receipt and expenditure of the 2008 SCAAP grant funds; now therefore,

BE IT ORDAINED by the McLean County Board as follows:

1. That the County Auditor is directed to add to the appropriated budget of the General Fund 0001, Sheriff's Department 0029 the following revenue:

Unappropriated Fund Balance	
0001-0029-0029-0400.0000	<u>\$ 5,997.00</u>

2. That the County Auditor is directed to add to the appropriated budget of the General Fund 0001, Sheriff's Department 0029 the following expenditure:

Purchase of Computer Equipment	
0001-0029-0029-0833.0002	<u>\$ 5,997.00</u>

3. That the County Clerk shall provide a certified copy of this ordinance to the Sheriff and Chief Deputy Sheriff, County Administrator, County Auditor, and the County Treasurer.

ADOPTED by the County Board of McLean County this 17th day of March, 2009.

ATTEST:

APPROVED:

Peggy Ann Milton, Clerk of the County Board,
McLean County, Illinois

Matt Sorensen, Chairman
McLean County Board

EA_SHER_SCAAPFUNDS02232009.JUS

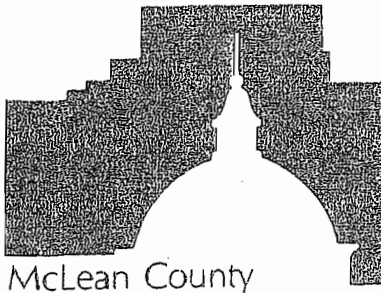

McLEAN COUNTY SHERIFF'S DEPARTMENT
MIKE EMERY, SHERIFF
"Peace Through Integrity"
Administration Office
(309) 888-5034
104 W. Front Law & Justice Center Room 105
P.O. Box 2400 Bloomington, Illinois 61702-2400

Detective Commander (309) 888-5051
Patrol Commander (309) 888-5859
Patrol Duty Sergeant (309) 888-5019
Jail Division (309) 888-5065
Process Division (309) 888-5040
Records Division (309) 888-5055
Domestic Violence Division (309) 888-4940
FAX (309) 888-5072

February 23, 2009

TO: Mr. Tari Renner, Chairman Justice Committee
FROM: Sheriff Mike Emery
RE: March 3, 2009 Justice Committee Meeting

I would respectfully request that the following items be placed on the March 3, 2009, Justice Committee Agenda for Action and Information.

ACTION

- 1) **Request approval of an amendment of the 2009 fiscal year budget.** Respectfully request to transfer \$5,996.06 from FY 2008 line 0001-0029-0031-0404-0202 into FY 2009 line 0001-0029-0031-0404-0202 to cover the expense of services provided by W. Masters Electrical. Funds in this account are received from Bureau of Justice Assistance, Bureau of Immigration and Customs Enforcement, State Criminal Alien Assistance Program (SCAAP).

The expenditure of funds is regulated by the Bureau of Justice Assistance and must be utilized towards Correctional programs and expenses. This expenditure was for the purpose of enhancing attorney/client conferences between the Public Defender's Office and their clients being detained in the Adult Detention Facility in relation to conferences for trial preparation.

INFORMATION

- 1) **McLean County Detention Facility Report:** (Please see attached.)
- 2) **National Institute of Corrections Technical Assistance report on McLean County Adult Detention Facility Population:** (Please see attached.)

Mr. Tari Renner, Chairman
Justice Committee
January 6, 2008
Page 2.

In August of 2008 the Adult Detention Facility Population Management Team was formed in order to discuss the inmate over-population of the Adult Detention Facility. The Management Team consisted of Eleventh Judicial Circuit Court Chief Judge Elizabeth Robb, McLean County State's Attorney William Yoder, McLean County Board Chairman Matt Sorenson, Justice Committee Chairman Tari Renner, Court Services Director Lori McCormick, McLean County Public Defender Ms. Amy Davis, Trial Court Administrator William Scanlon, Adult Detention Facility Superintendant Mr. Greg Allen, Judge Kevin Fitzgerald, Judge Robert Freitag, McLean County Administrator Mr. John Zeunik, Assistant Administrator Mr. Walter Lindberg, Deputy Director's of Court Services Ms. Chris Bailey and Mr. Mike Donovan, and Sheriff Mike Emery.

At the October, 2008, meeting, information was distributed indicating that the National Institute of Corrections (NIC) would provide grant funded technical assistance/assessment to McLean County at no cost. The Management Team unanimously approved this opportunity and contact was made with the NIC.

On January 6, 2009, the Technical Assistance Team, Mr. Mark Cunniff and Mr. Bob Cushman, arrived to start the assessment. On January 8, 2009, a public forum was conducted in the County Board Room of the Government Center. Upon conclusion of the Public Forum, the Assessment Team has prepared and submitted to McLean County their final report.

This evening that final report is being submitted to Justice for review. At this time the report is submitted as information. The report is quite lengthy and in respect to the Members of the Justice Committee and McLean County Board, I will again submit this item on my April Justice Committee Agenda for discussion as an item for action.

If you have any questions prior to the meeting, please feel free to contact me.

Sincerely,

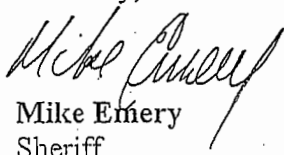
Mike Emery
Sheriff

McLEAN COUNTY – GRANT INFORMATION FORM

General Grant Information

<u>Requesting Agency or Department:</u> McLean County Court Services-in collaboration with the Judiciary, Sheriff's Department, SAO, mental health facilities	<u>This request is for:</u> <input checked="" type="checkbox"/> A New Grant <input type="checkbox"/> Renewal/Extension of Existing Grant
<u>Grantor:</u> US Dept. of Justice	<u>Grant Type:</u> <input checked="" type="checkbox"/> Federal, CFDA #: <input type="checkbox"/> State <input type="checkbox"/> Other
<u>Anticipated Grant Amount:</u> \$50,000	<u>Grant Funding Method:</u> <input type="checkbox"/> Reimbursement <input checked="" type="checkbox"/> Pre-Funded <u>Expected Initial Receipt Date:</u>
<u>Anticipated Match Amount (if applicable):</u> \$10,000 (20%)	<u>Source of Matching Funds (if applicable):</u>

Personnel and Information

<u>New personnel will be hired:</u> <input type="checkbox"/> Yes (complete chart below) <input checked="" type="checkbox"/> No	<u>A new hire will be responsible for financial reporting:</u> <input type="checkbox"/> Yes <input type="checkbox"/> No		
<u>New Personnel Expense Chart</u>	Current FY	Current FY+1	Current FY+2
Number of Employees:			
Personnel Cost	\$	\$	\$
Fringe Benefit Cost	\$	\$	\$
Total Cost	\$	\$	\$

Additional Costs and Requirements (if applicable)

<u>Description of equipment to be purchased:</u>	<u>Description of subcontracting costs:</u>		
<u>Additional Costs Chart</u>	Current FY	Current FY+1	Current FY+2
Subcontractors	\$	\$	\$
Equipment	\$	\$	\$
Other	\$	\$	\$
Total Cost	\$	\$	\$

Other requirements or obligations: (increased workload, continuation of program after grant period, etc)

This is a planning grant only that will enable a county wide collaboration to expand and become more formalized. Crisis Intervention Training (CIT) for police officers could be funded as well as training for attorneys working in the State's Attorney's office and Public Defender office and Probation officers to better identify persons with mental illness or co-occurring disorders and divert them to appropriate service providers in our community.

Responsible Personnel for Grant Reporting and Oversight:

Department Head Signature _____

Date _____

Grant Administrator Signature (if different) _____

Date _____



COURT SERVICES

104 W. Front Street, P.O. Box 2400 Law & Justice Center, 7th Floor Bloomington, IL 61702

Adult Division
Room 700
Ph: 309-888-5360
Fax: 309-888-5434

Juvenile Division
Room 701
Ph: 309-888-5370
Fax: 309-888-5831

Extended Day
Room 703
Ph: 309-888-5370
Fax: 309-888-5831

To: Honorable Members of the Justice Committee

From: Lori McCormick

CC: Judge Elizabeth Robb

Date: February 19, 2009

Re: Grant Proposal

I am writing to request the authorization to apply for a \$50,000.00 grant through the US Department of Justice for a mental health court planning grant. There is a 20% match.

For the past two years community and agency leaders have been meeting regularly to discuss and develop a more comprehensive and cohesive system to address the needs of criminal justice involved persons with mental illness and co-occurring disorders. From a group of fewer than 10 persons to a community collaboration of more than 30 organizations, the McLean County Mental Health Court Initiative has been working diligently to improve the current delivery system of mental health services in McLean County to persons involved in the criminal justice system. Members of the McLean County Mental Health Court Initiative are also participating in Illinois' Mental Health and Criminal Justice Statewide Transformation Initiative. The goal is to develop and adopt the Sequential Intercept Model in order to divert persons from the criminal justice system whenever appropriate. This model envisions a series of points of interception at which an intervention can be made to prevent individuals from entering or penetrating deeper into the criminal justice system. Ideally, most people will be intercepted at early points, such as law enforcement, emergency services and or initial detention and court hearings with decreasing numbers at each subsequent point that could include jail, court, and probation.

A planning grant will enable this collaboration to expand and become more formalized. Crisis Intervention Training (CIT) for police officers could be funded as well as training for attorneys working in the State's Attorney's office and Public Defender office and Probation Officers to better identify persons with mental illness or co-occurring disorders and divert them to appropriate service providers in our community.

This proposal is a collaborative effort including the Judiciary, States Attorney's Office, Public Defender's Office, Sheriff's Department, as well as the Normal Police Department, Bloomington Police Department, ISU Police Department, Center for Human Services and Chestnut Health Systems.

I will be present at the Justice committee meeting to discuss this issue with you in detail.

RESOLUTION of the McLEAN COUNTY BOARD
IN MEMORY AND RECOGNITION OF
THE LATE JOHN W. ENGLISH

WHEREAS, John W. English faithfully served the McLean County Community through his leadership and dedicated service as a member of the McLean County Board, having been first elected to the County Board in 1974 and then re-elected in 1978 to serve the citizens of McLean County; and,

WHEREAS, John W. English served the McLean County Community through his leadership and dedicated service to the Unit 5 School Board, the Parkland's Foundation Board, the McLean County League of Women Voters, and the McLean County Soil and Water Conservation District Board; and,

WHEREAS, John W. English served the McLean County Board and the McLean County Community through his leadership skills, love of the outdoors and horticulture knowledge allowing him to be active in the planning and development of COMLARA County Park; and,

WHEREAS, John W. English served the McLean County Community by enhancing the quality of life for citizens by planting many trees and prairies at COMLARA County Park; and,

WHEREAS, John W. English generously offered his many talents and his time in the service of McLean County and the McLean County Board and, in so doing, John W. English improved the quality of life for all the citizens of McLean County; and,

WHEREAS, it is fitting and appropriate for the McLean County Board to recognize the accomplishments, dedicated service, and contributions of the late John W. English to the McLean County Community; and,

WHEREAS, it is fitting and appropriate for the McLean County Board and the McLean County Department of Parks and Recreation to establish the John W. English Memorial Trail and the John W. English Prairie at COMLARA County Park now, therefore,

BE IT RESOLVED by the McLean County Board, now meeting in regular session on this the 17th day of March, 2009, that the McLean County Board expresses its sincere appreciation for contributions to issues of community interest in memory of the late John W. English.

ADOPTED by the McLean County Board this 17th day of March, 2009.

ATTEST:

APPROVED:

Peggy Ann Milton, Clerk of the County Board
McLean County, Illinois

Matt Sorensen, Chairman
McLean County Board

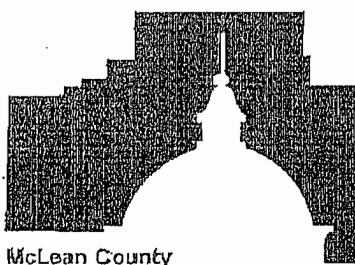

McLean County

DEPARTMENT OF PARKS AND RECREATION
(309)726-2022 FAX (309)726-2025 www.mcleancountyl.gov
13001 Recreation Area Dr. Hudson, IL 61748-7594

TO: Honorable Chairman and Members, Property Committee

FROM: Michael J. Steffa, Director of Parks and Recreation

DATE: February 24, 2009

RE: John English Memorial Nature Trail & Prairie Resolution

The Parks Department was saddened to hear that former County Board Member John English passed away on January 6, 2009. Mr. English was a County Board member from 1974 to 1982. His love of the outdoors and horticulture knowledge allowed him to be an active volunteer in the planning and development of COMLARA County Park. He personally was responsible for the planting of many of the trees and prairies that are at the Park today. In addition to the County Board, Mr. English served on the Unit 5 School Board, the Parkland's Foundation Board, the McLean County League of Women Voters, and the McLean County Soil and Water Conservation District Board. He was also involved in many other community programs, and was the very first recipient of the WJBC Spirit of McLean County Award in 1977.

Under McLean County Ordinance 5.19 the Parks Department would like to propose a resolution renaming the Deer Island Access Trail at COMLARA County Park as John English Memorial Trail. This trail was chosen because it receives more foot traffic than any other trail in the park. It starts next to the Visitor Center and runs south along Evergreen Lake to Six Mile Creek Prairie near Six Mile Creek Bridge. It is approximately 1.5 miles in length. We would also like to name this 7-acre prairie, which was planted with Member English's personal volunteer assistance the John English Prairie.

We would like to have a formal dedication for the trail and the prairie on Saturday, May 16, 2009. The Parks Department would change signs at both ends of the trails and at the prairie to recognize the memory of Mr. English.

5.19 POLICY AND GUIDELINES ON RECOGNIZING, NAMING AND DEDICATING COUNTY FACILITIES, ROADS AND HIGHWAYS.

5.19-1 The following process of approval shall be established to recognize, name and dedicate County facilities, roads and highways:

(A) The request shall be presented to the appropriate Oversight Committee of the County Board for the Committee's review and approval.

(B) The recommendation of the Oversight Committee shall be presented to the Executive Committee for review and approval.

(C) Upon approval of the Executive Committee, the recommendation to recognize, name and dedicate County facilities, roads and highways shall be presented to the County Board for review and approval.

McLEAN COUNTY – GRANT INFORMATION FORM

General Grant Information

Requesting Agency or Department: McLean County Highway Department		This request is for: <input checked="" type="checkbox"/> A New Grant <input type="checkbox"/> Renewal/Extension of Existing Grant	
Granting Agency: Illinois Department of Transportation		Grant Type: <input type="checkbox"/> Federal, CFDA #: <input type="checkbox"/> State <input type="checkbox"/> Other	Grant Date: Start: End:
Grant Title: Highway Safety Improvement Program			
Grant Amount: \$180,000		Grant Funding Method: <input checked="" type="checkbox"/> Reimbursement, Receiving Cash Advance <input type="checkbox"/> <input type="checkbox"/> Pre-Funded	
Match Amount (if applicable): Required Match :\$20,000 Overmatch: \$		Expected Initial Receipt Date:	
Grant Total Amount: \$200,000		Source of Matching Funds (if applicable): Highway(0120)	
Will it be likely to obtain this grant again next FY? <input type="checkbox"/> Yes <input checked="" type="checkbox"/> No		Equipment Pass Through? <input type="checkbox"/> Yes <input checked="" type="checkbox"/> No Monetary Pass Through? <input type="checkbox"/> Yes <input checked="" type="checkbox"/> No	

Grant Costs Information

Will personnel be supported with this grant: <input type="checkbox"/> Yes (complete personnel portion below) <input checked="" type="checkbox"/> No		A new hire will be responsible for financial reporting: <input type="checkbox"/> Yes <input checked="" type="checkbox"/> No																							
<table border="1"> <caption align="center">Grant Expense Chart</caption> <thead> <tr> <th>Personnel Expenses</th> <th>Costs</th> </tr> </thead> <tbody> <tr> <td>Number of Employees:</td> <td></td> </tr> <tr> <td>Personnel Cost</td> <td>\$6000</td> </tr> <tr> <td>Fringe Benefit Cost</td> <td>\$</td> </tr> <tr> <td>Total Personnel Cost</td> <td>\$6,000</td> </tr> <tr> <td>Additional Expenses</td> <td></td> </tr> <tr> <td>Subcontractors</td> <td>\$175,000</td> </tr> <tr> <td>Equipment</td> <td>\$</td> </tr> <tr> <td>Other</td> <td>\$19,000</td> </tr> <tr> <td>Total Additional Expenses</td> <td>\$194,000</td> </tr> <tr> <td>GRANT TOTAL</td> <td>\$200,000</td> </tr> </tbody> </table>		Personnel Expenses	Costs	Number of Employees:		Personnel Cost	\$6000	Fringe Benefit Cost	\$	Total Personnel Cost	\$6,000	Additional Expenses		Subcontractors	\$175,000	Equipment	\$	Other	\$19,000	Total Additional Expenses	\$194,000	GRANT TOTAL	\$200,000	Description of equipment to be purchased: Description of subcontracting costs: Other requirements or obligations: 	
Personnel Expenses	Costs																								
Number of Employees:																									
Personnel Cost	\$6000																								
Fringe Benefit Cost	\$																								
Total Personnel Cost	\$6,000																								
Additional Expenses																									
Subcontractors	\$175,000																								
Equipment	\$																								
Other	\$19,000																								
Total Additional Expenses	\$194,000																								
GRANT TOTAL	\$200,000																								

Grant Total must match "Grant Total Amount" from General Grant Information

Responsible Personnel for Grant Reporting and Oversight:

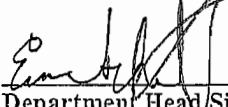
Department Head Signature

3/2/2009
Date

Grant Administrator/Coordinator Signature (if different)

Date

OVERSIGHT COMMITTEE APPROVAL

Chairman

Date

Form Date: 4/21/06



HIGHWAY DEPARTMENT
Eric S. Schmitt, County Engineer
Jerry Stokes, Assistant County Engineer
102 S. Towanda Barnes Road
Bloomington, IL 61705
(309) 663-9445 FAX (309) 662-8038
highway@mcleancountyll.gov.

February 27, 2009

Illinois Department of Transportation
Division of Highways / Region 3 / District 5
Mr. Joseph B. Crowe
Attn: Darla Latham
13473 IL Highway 133
P.O. Box 610
Paris, IL 61944

RE: 2010 Comprehensive Highway Safety Plan
McLean County
C.H. 39 Ropp Road at Evergreen Lake

Dear Ms. Latham:

Evergreen Lake was built in the early 1970's on the northwest side of McLean County. C.H. 39 was a due north-south road that intersected C.H. 8 before the lake was built. Once the lake was built, C.H. 39 was terminated approximately one quarter mile before C.H. 8 at the lake. In the late 1970's, a boat ramp was constructed to provide access to the lake and C.H. 39 was reconstructed as a bituminous road to the boat ramp.

This project is a good candidate to receive federal funding to reduce fatalities because it affects the two highest Illinois Comprehensive Highway Safety Plan's areas of emphasis of 1) alcohol and other impaired driving and 2) driver behavior and awareness. The fatalities and injuries that have occurred at this location have involved drivers that were impaired and unfamiliar with the road ending in the lake.

There have been numerous safety measures taken to warn drivers of the roadway ending such as speed reduction zones, rumble strips, double stop signs and other warning signs. These safety improvements were in place at the time of the accidents used in this study.

A Roadway Safety Assessment (RSA) was conducted on January 7, 2009 and January 8, 2009 by members from the Illinois Department of Transportation, Federal Highway Administration, and Illinois State Police to provide observations and identify other safety measures that could be implemented to prevent vehicles from entering the lake. The main observation from the RSA was that there was no warning to the motorists that the roadway was ending at Evergreen Lake or a park setting was being entered.

A proposed countermeasure included in the safety plan is to install warning signs well advance of Evergreen Lake. The warning signs will be placed at the intersection of C.H. 8 and C.H. 39 which is approximately $\frac{3}{4}$ of mile south of the hazard. Additional signs will also be added approximately halfway from the intersection to the hazard to notify drivers that a park area is being entered.

Another countermeasure is to realign the roadway segment by providing an offset intersection approximately 1000 feet from the lake which would help reduce the crashes at the boat ramp. The drivers will be forced to stop, make a left hand turn and then a right turn before connecting back into the existing road. This improvement would allow for a deliberate change of the roadway alignment and force drivers to execute driving maneuvers to break up the monotony of a 55 mph straight road.

Additional lighting would also be installed at the new intersection where new stop signs will be placed.

The approximate total cost of the project would be \$200,000 that includes work to be contracted, work performed by the McLean County Highway Department's day labor and the engineering associated with the design and construction of the project.

Alcohol, illegal substances and unaware drivers played a major factor in contributing to the accidents at this location. This project would be a good candidate for federal funding to eliminate fatal crashes by providing warning signs to notify the drivers of the road ending at the lake and that a park setting is being entered. Also, realigning the roadway segment would allow the motorists to make a driving maneuver before entering the park/lake area.

Sincerely,

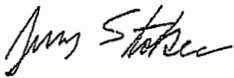

Jerry Stokes, PE
Assistant County Engineer
McLean County Highway Department

