

TRANSPORTATION COMMITTEE AGENDA
Room 404, Government Center
115 E. Washington Street, Bloomington, IL
Tuesday, May 2, 2006
8:00 A.M.

1. **Roll Call**
2. **Approval of Minutes from April 4, 2006 Meeting**
3. **Recommend Payment of Bills to County Board**
4. **Appearance by Members of the Public and County Employees**
5. **Items to be Presented for Action**
 - A. Field Trip – Danvers – West Street (Meet in Government Center Parking Lot @ 8:00 a.m.)
 - B. West Street – Village of Danvers Memo & Maps 1 – 31
 - C. Bentown Holder Road – CH 25 32 – 36
 1. State Truck Access Route Program (TARP) Agreement 37
 2. 80,000 Pound Weight Limit Resolution 38
 3. 80,000 Pound Weight Limit Agreement – Streutker Dairy 39
 4. 80,000 Pound Weight Limit Agreement – Evergreen FS
 - D. Emergency Revenue & Appropriation Ordinance County Highway Funds – Wind Farm 40
6. **Items to be Presented for Information**
 - A. Project Summary
 1. Ellsworth Wind Farm Box Culverts – Sec 06-00134-05-BR & 06-00134-06-BR – CH 17 41
 2. Horizon Wind Farm Resurfacings – Sec 06-00044-10-SM, 06-00134-07-SM & 06-00140-03-SM 42
 - B. East Side Highway Study 43
 - C. United Rentals Highway Technology Explanation 44 – 45
 - D. Other
7. **Adjournment**



HIGHWAY DEPARTMENT

John E. Mitchell, County Engineer
Eric S. Schmitt, Assistant County Engineer
102 S. Towanda-Barnes Rd, Bloomington, IL 61704
(309) 663-9445 FAX (309) 662-8038
highway@mcleancountyil.gov

DATE: April 21, 2006

TO: Chairman Duffy Bass & Members of the McLean County Transportation Committee

FROM: John E. Mitchell, McLean County Engineer *JEM*

RE: West Street in Danvers

Information you requested for your consideration of the Village of Danvers' request for McLean County to assume the jurisdiction of West Street in Danvers from North Street to Illinois State Route 9 is as follows:

1. Maps of all Villages and Towns (excluding Bloomington & Normal) in McLean County are enclosed. Colored in orange are Hot Mix County Highways, and blue are Seal Coat County Highways. Also enclosed is a copy of the current McLean County Map with the same color symbols. Each entity is unique. The majority of the municipalities have one (1) County Highway passing through them; some have two (2). This is mainly a function of their location relative to other towns and State Highways.
2. Also enclosed is a copy of Section 605 ILCS 5/5-102 of the Illinois Statutes, which says, "Highways added to the County Highway System shall be as nearly as possible highways connecting the principal municipalities and trading points in each County with each other, and also with the principal municipalities and trading points in other Counties.
3. The current traffic count on West Street is 1,665 cars per day at the south end and 1,326 at the north end.
4. The Illinois Department of Transportation (IDOT) has to approve all jurisdictional transfers and require that both parties fully agree to the transfer.

5. Our Cost Estimate to Improve the three (3) blocks (946') of West Street from North Street to Main Street with two inches (2") of Bituminous Hot Mix is \$55,000. This will provide an 80,000-pound truck design.
6. Our Cost Estimate to Improve the rest of West Street (3,351') from Main Street to Illinois State Route 9 with two inches (2") of Bituminous Hot Mix is \$145,000. This is already designated an 80,000 Pound Truck Route.
7. We have been notified that we will receive \$317,040 of State Truck Access Route Program (TARP) Funds for the Danvers Carlock Road.
8. Today I met with the Village of Danvers' Mayor Ron Roth and proposed a compromise that we would pave the north three (3) blocks of West Street within five (5) years. This will be done when we resurface County Highway 55 (CH 55) west of Danvers, if the Village will designate these three (3) blocks as an 80,000 Pound Truck Route now and keep the jurisdiction of West Street. This of course would need your concurrence and the full County Board approval as well as the Danvers Village Board approval. Mayor Roth said he would think about it. Mayor Roth does plan to meet us at approximately 8:30 on West Street in Danvers on May 2, 2006 during our field trip.
9. As far as setting a precedent goes, the only similar situation I am aware of that has been discussed is at Hudson where the Township and Village asked of me if the County would take over Broadway Street, which is the continuation of Linden Street, for three (3) miles to the Lake Spur. This road has similar traffic as is in Danvers. I told the Highway Commissioner that the County has just improved two (2) roads into Hudson and I thought their request should be postponed. I am sure they will be making this request again shortly and sooner if we do take West Street in Danvers.

ANCHOR

2004 CENSUS POPULATION: 169

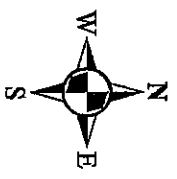
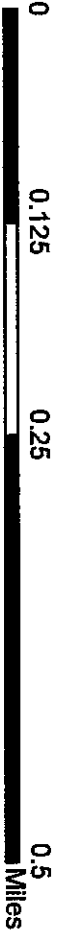
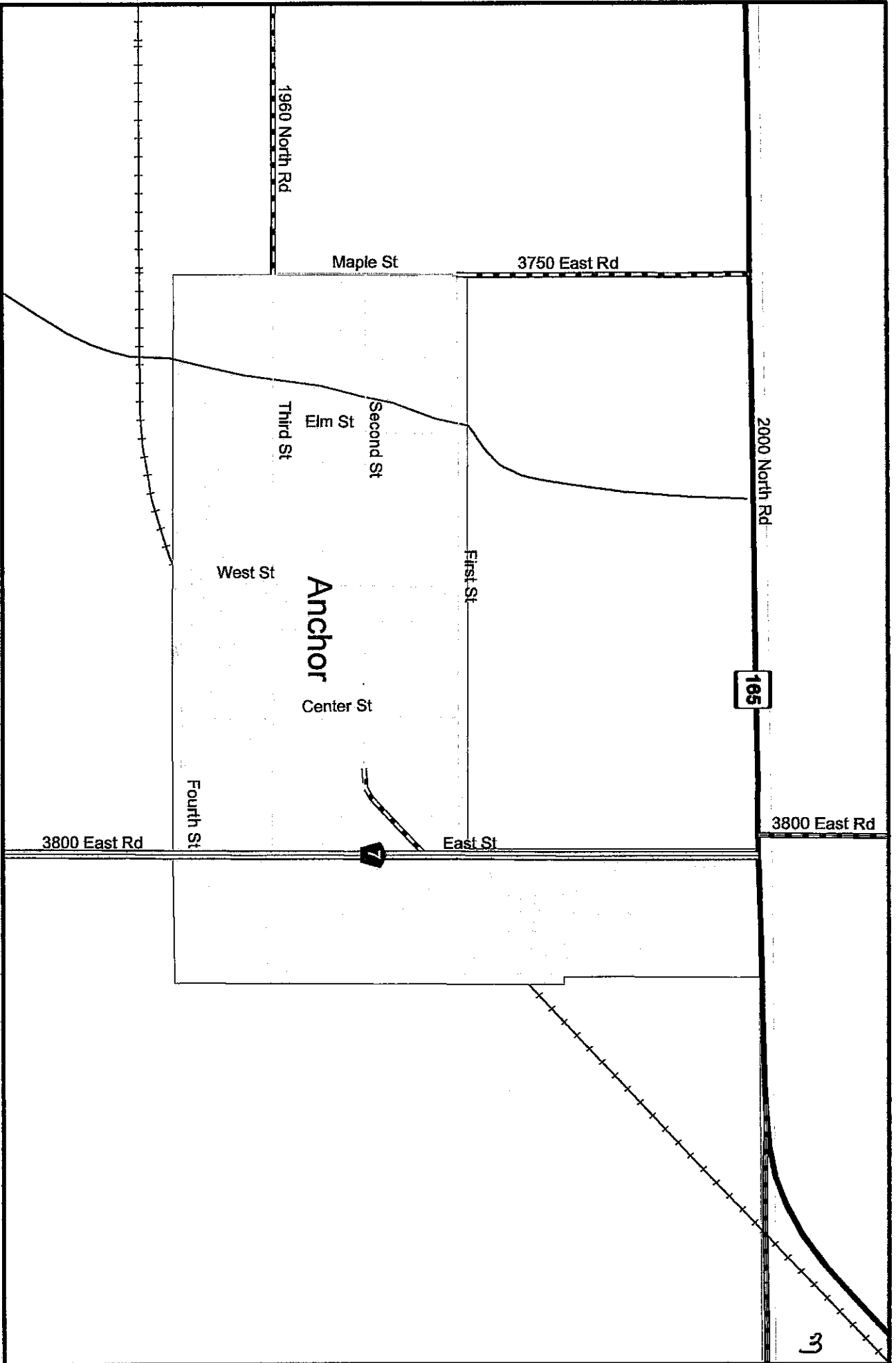

Legend

County Highways

Surface_Type

Hotmix

Oil Chip

ARROWSMITH

2004 CENSUS POPULATION: 286

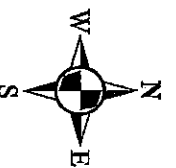

Legend

County Highways

Surface_Type

- Hotmix
- Oil chip

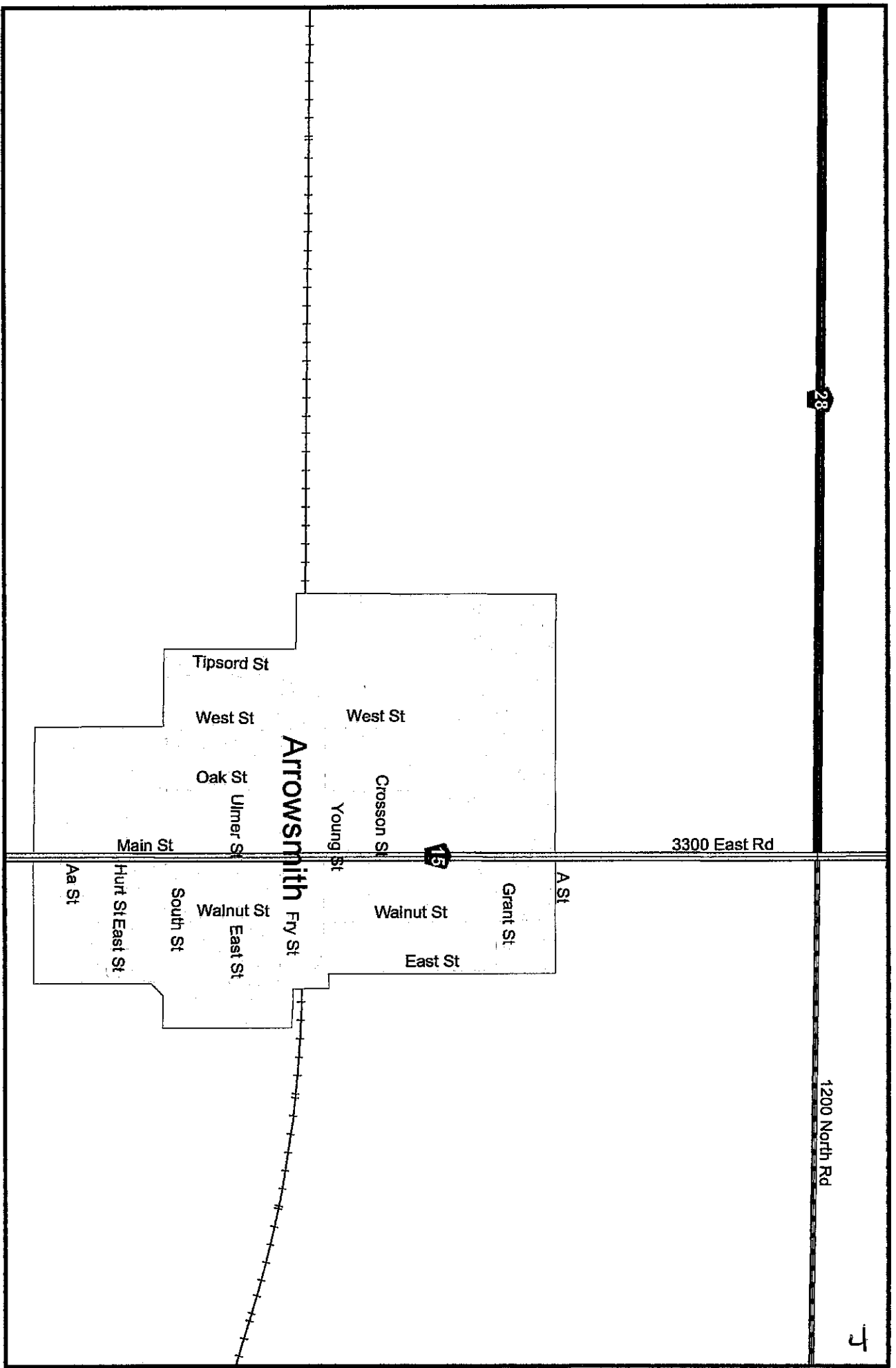

BELFLOWER

2004 CENSUS POPULATION: 388

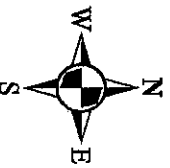
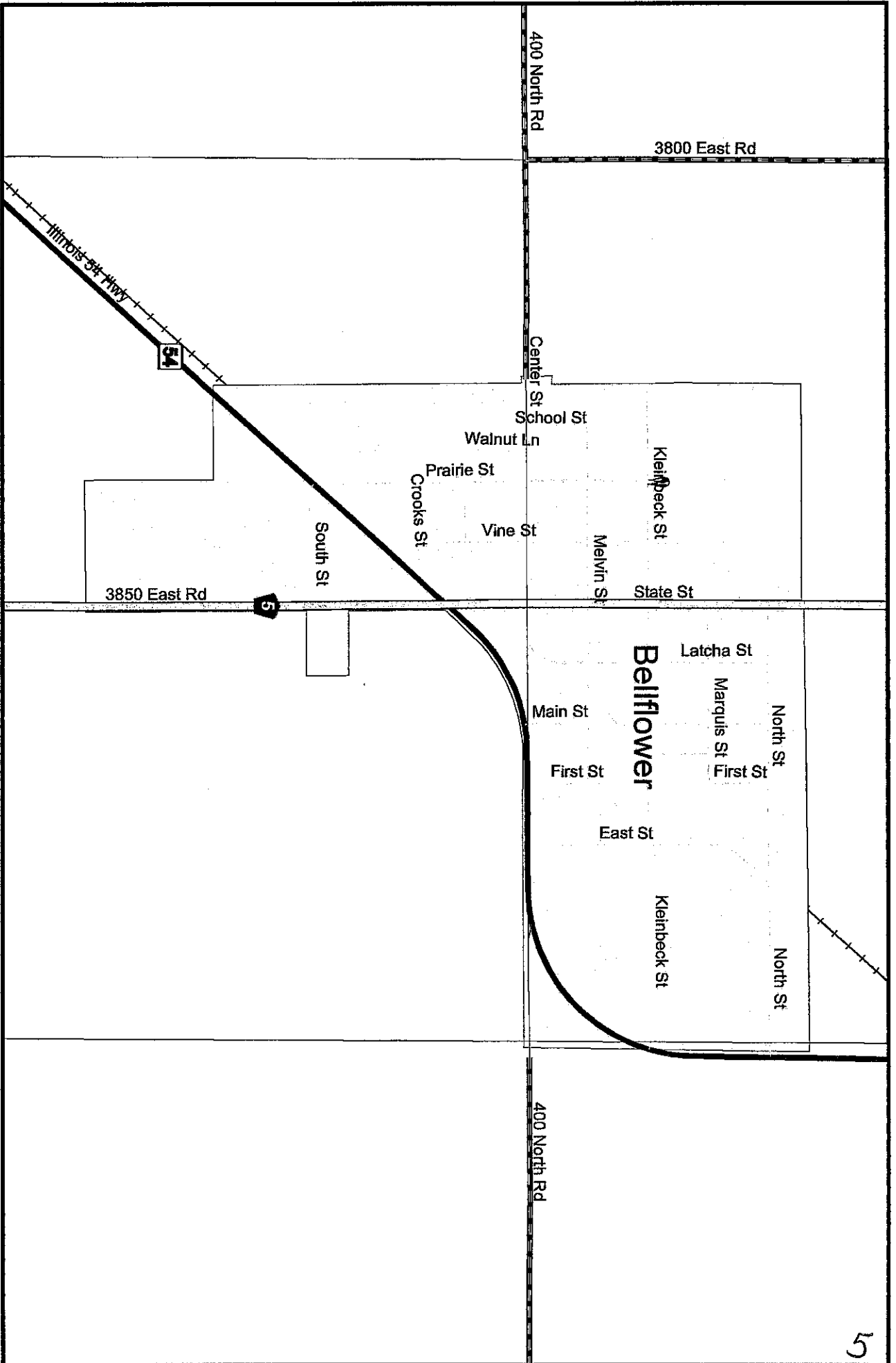

- Legend**
- County Highways**
- Hotmix
 - Oil Chip

CHENOA

2004 CENSUS POPULATION: 1,811

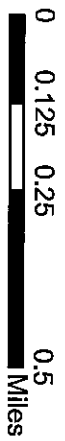
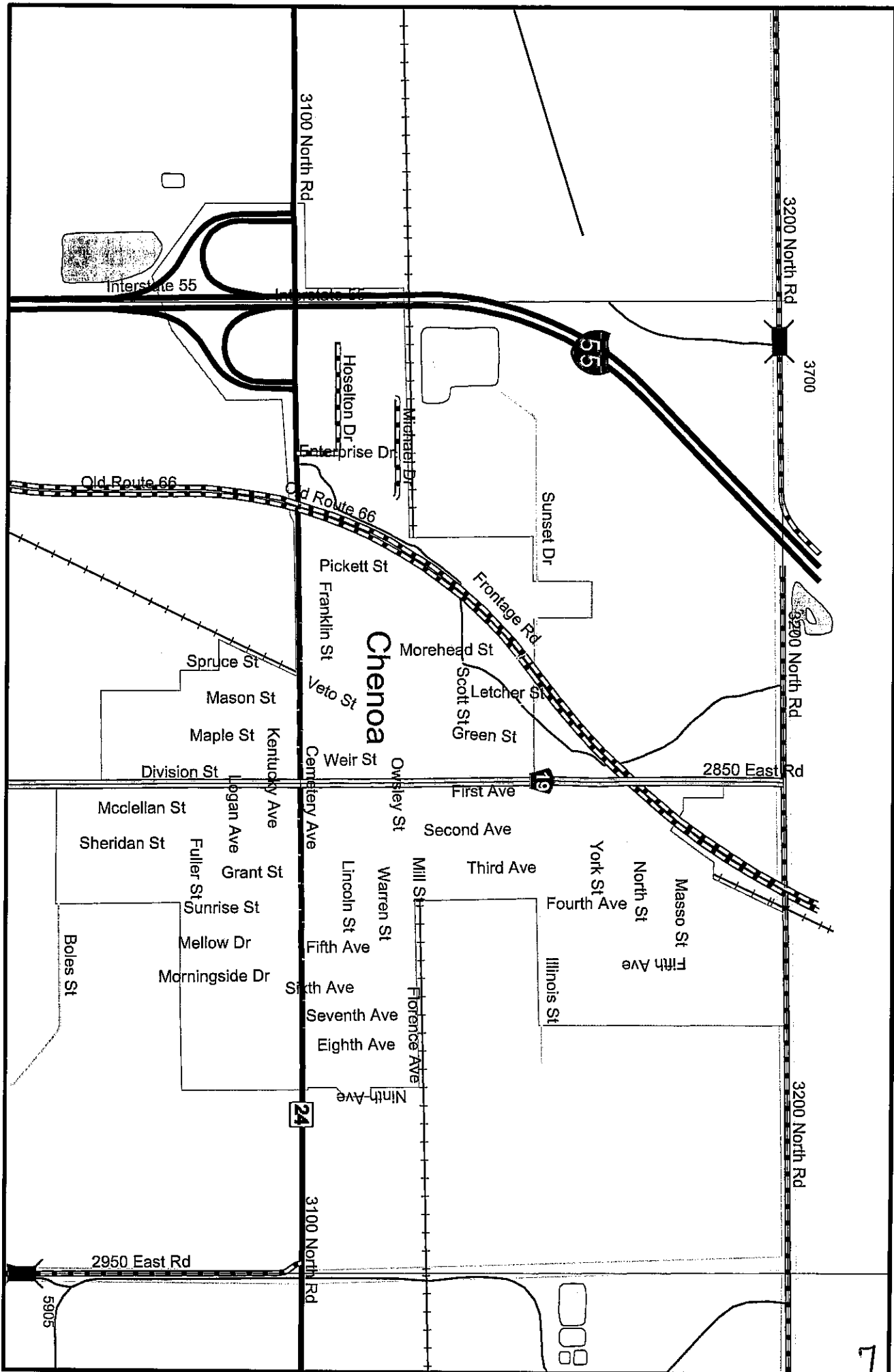

Legend

County Highways

Surface_Type

- Holmix
- Oil Chip

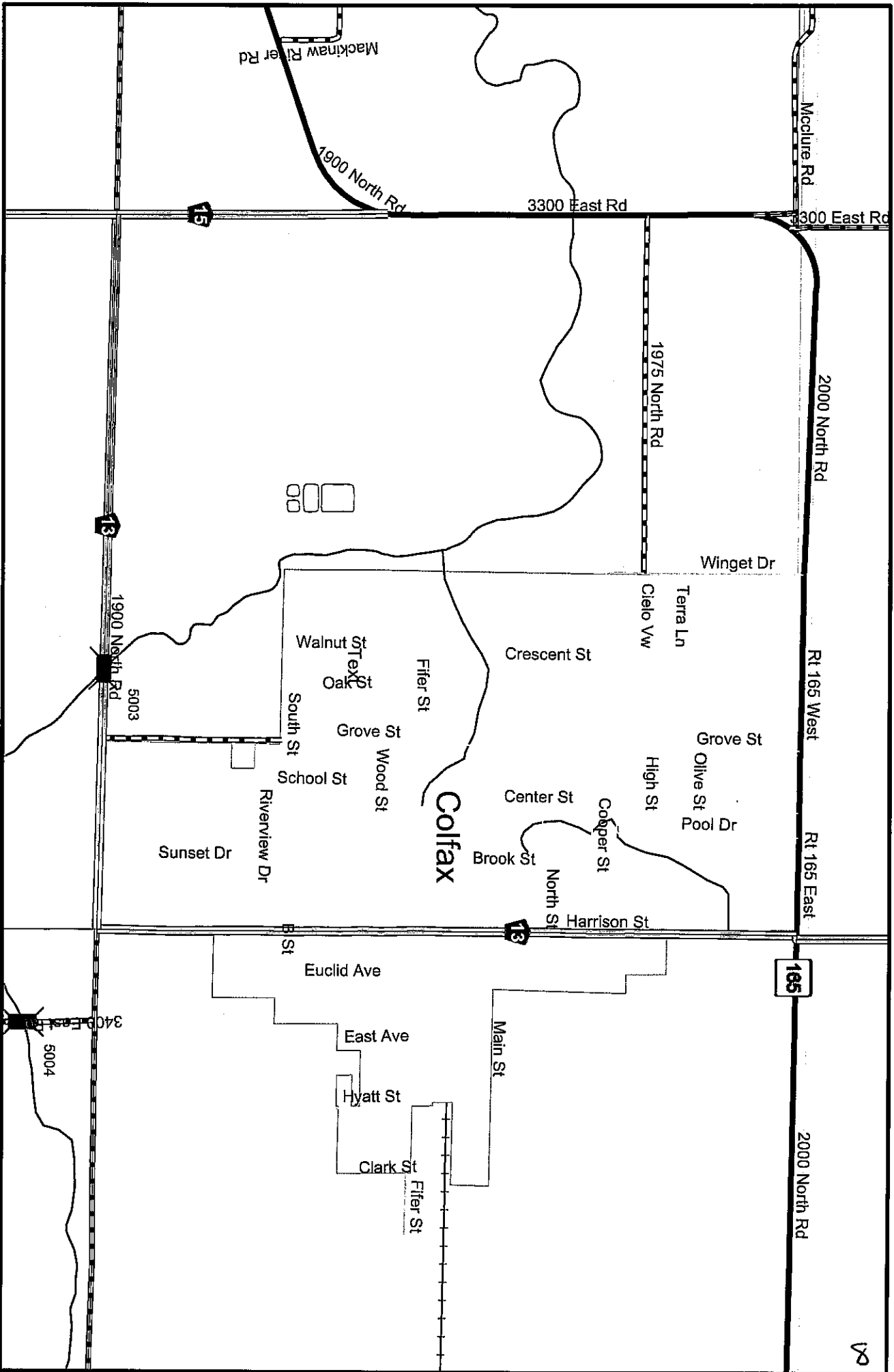

COLFAX

2004 CENSUS POPULATION: 991



Legend

- County Highways**
- Surface_Type**
- Hotmix
- Oil Chip

COOKSVILLE

2004 CENSUS POPULATION: 203

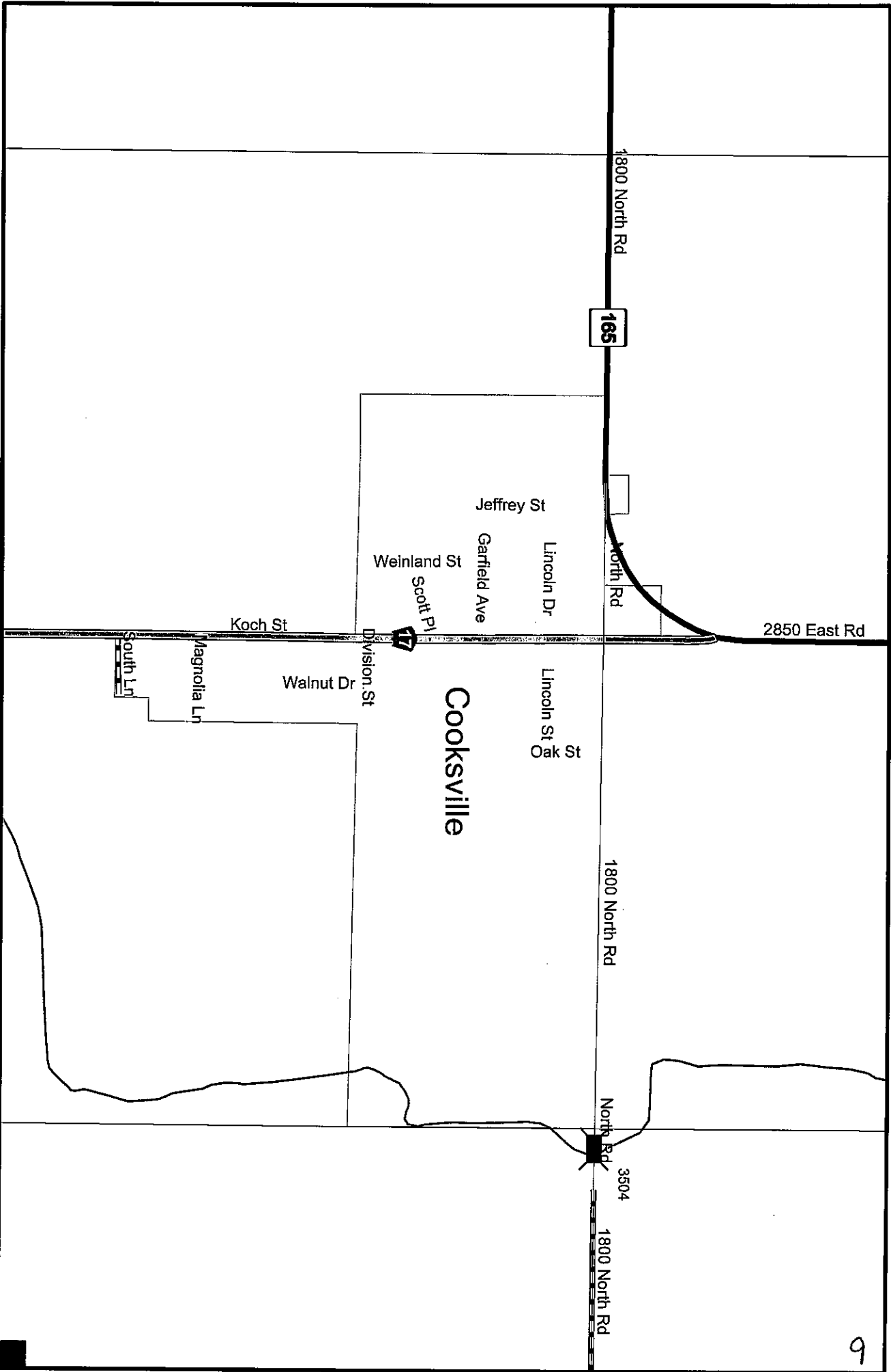

Legend

County Highways

Surface_Type

- Hotmix
- Oil Chip

DANVERS

2004 CENSUS POPULATION: 1142

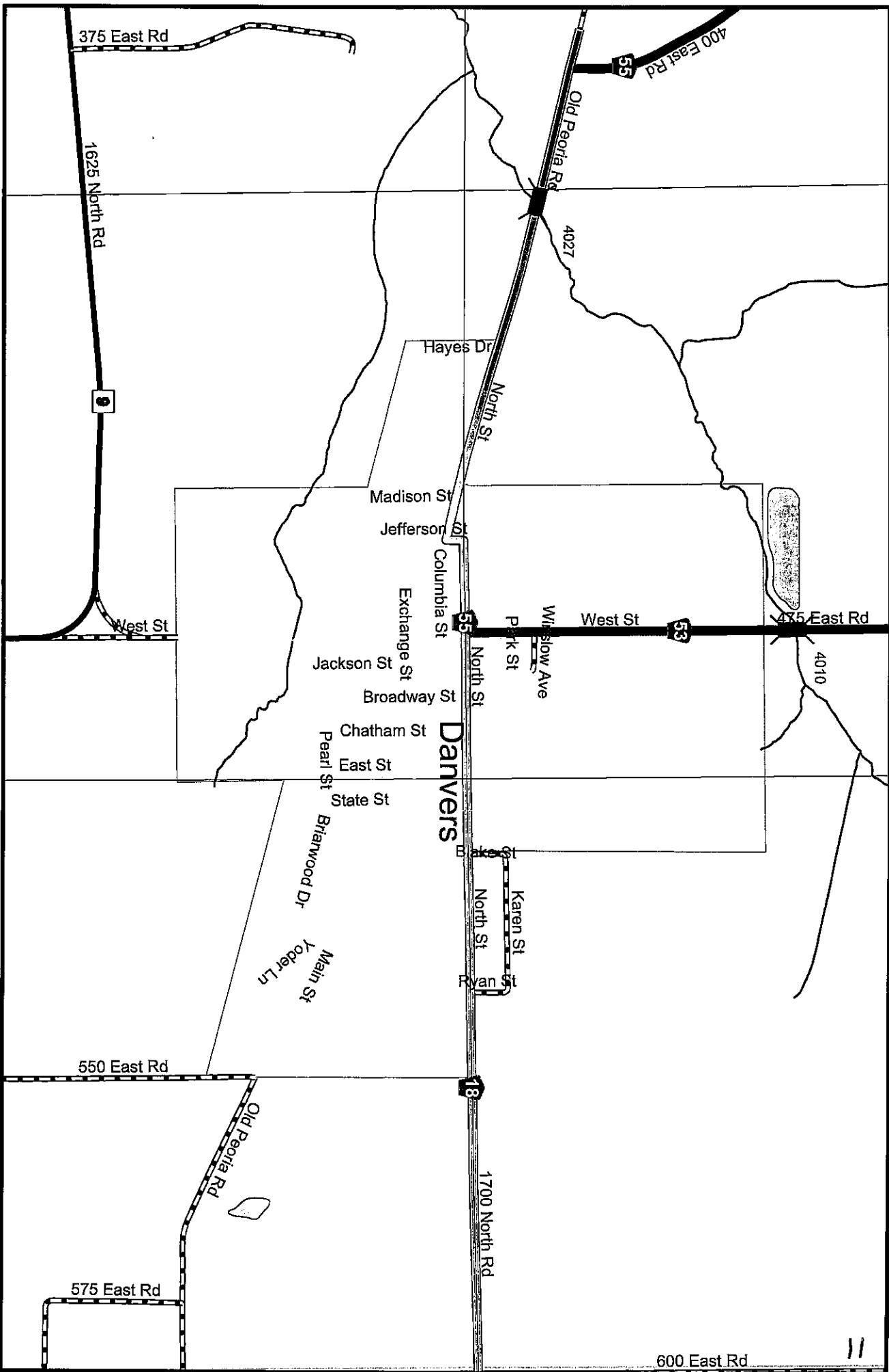

- Legend**
- County Highways**
- Surface_Type
 - Hotmix
 - Oil Chip

DOWNS

2004 CENSUS POPULATION: 751

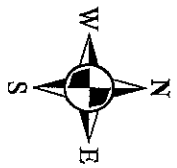
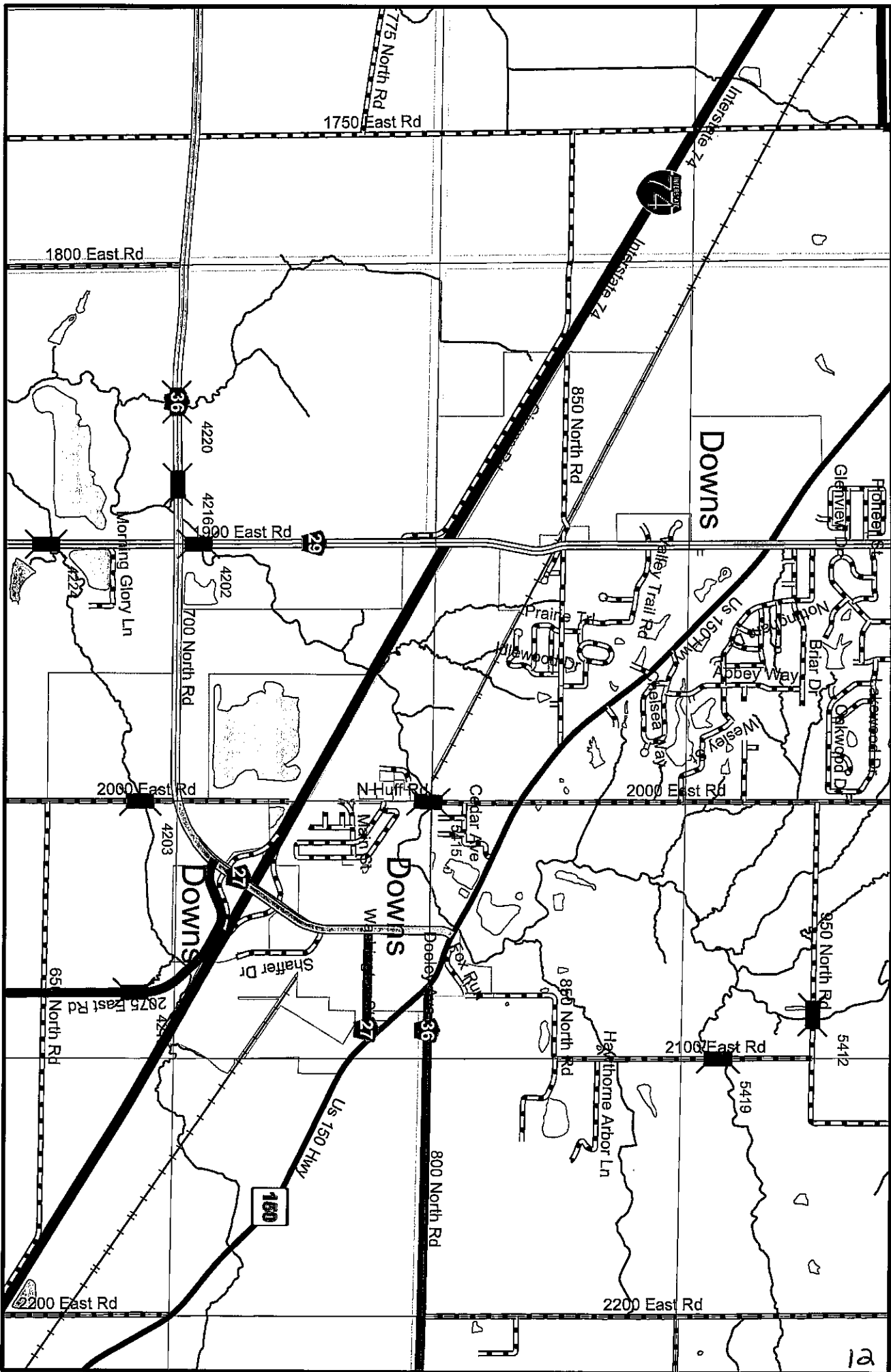

Legend

- County Highways
- Surface_Type
- Hotmix
- Oil Chip

EL PASO

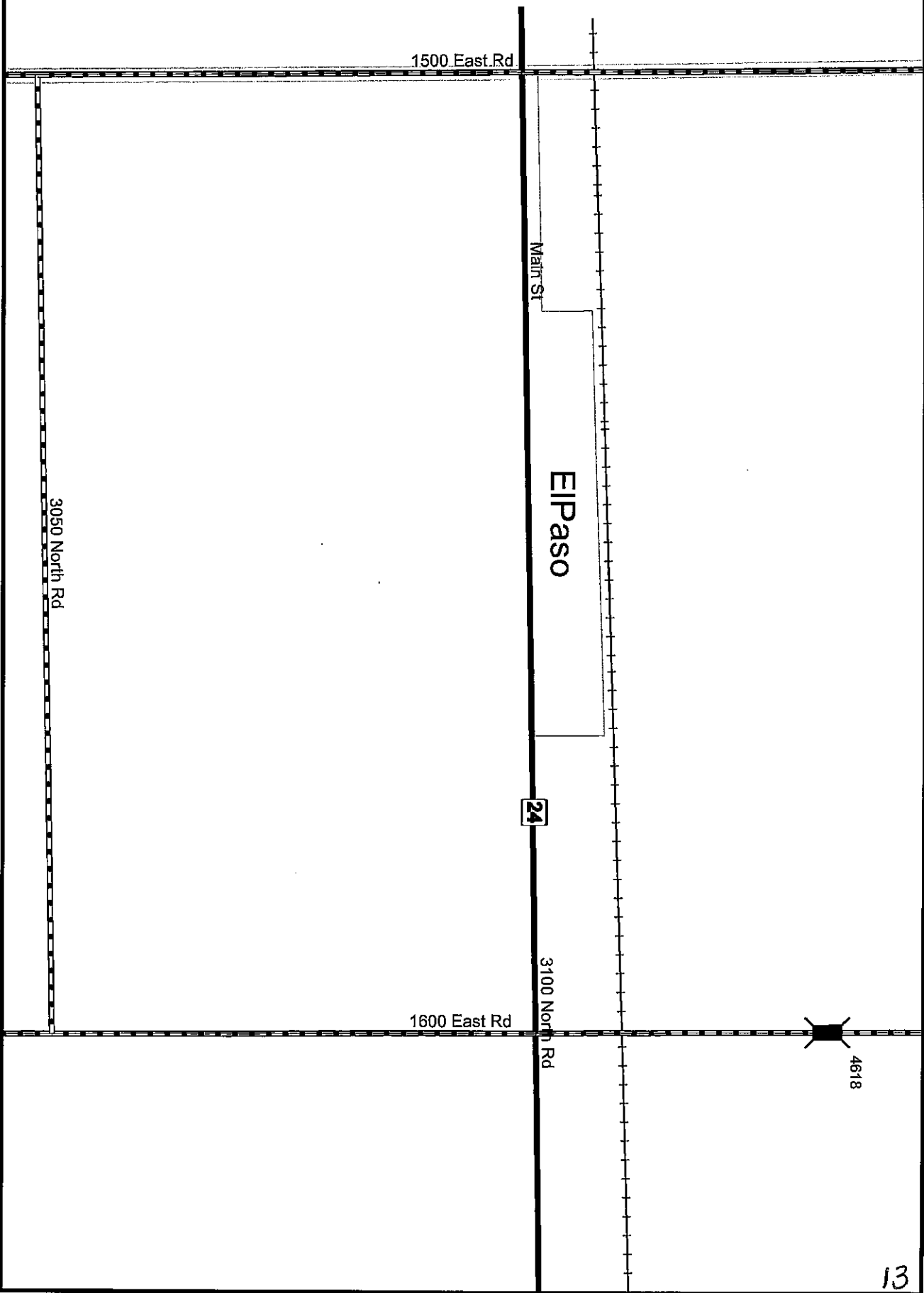

Legend

County Highways

Surface_Type

- Hotmix
- Oil Chip

ELLSWORTH

2004 CENSUS POPULATION: 261

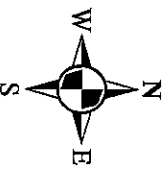
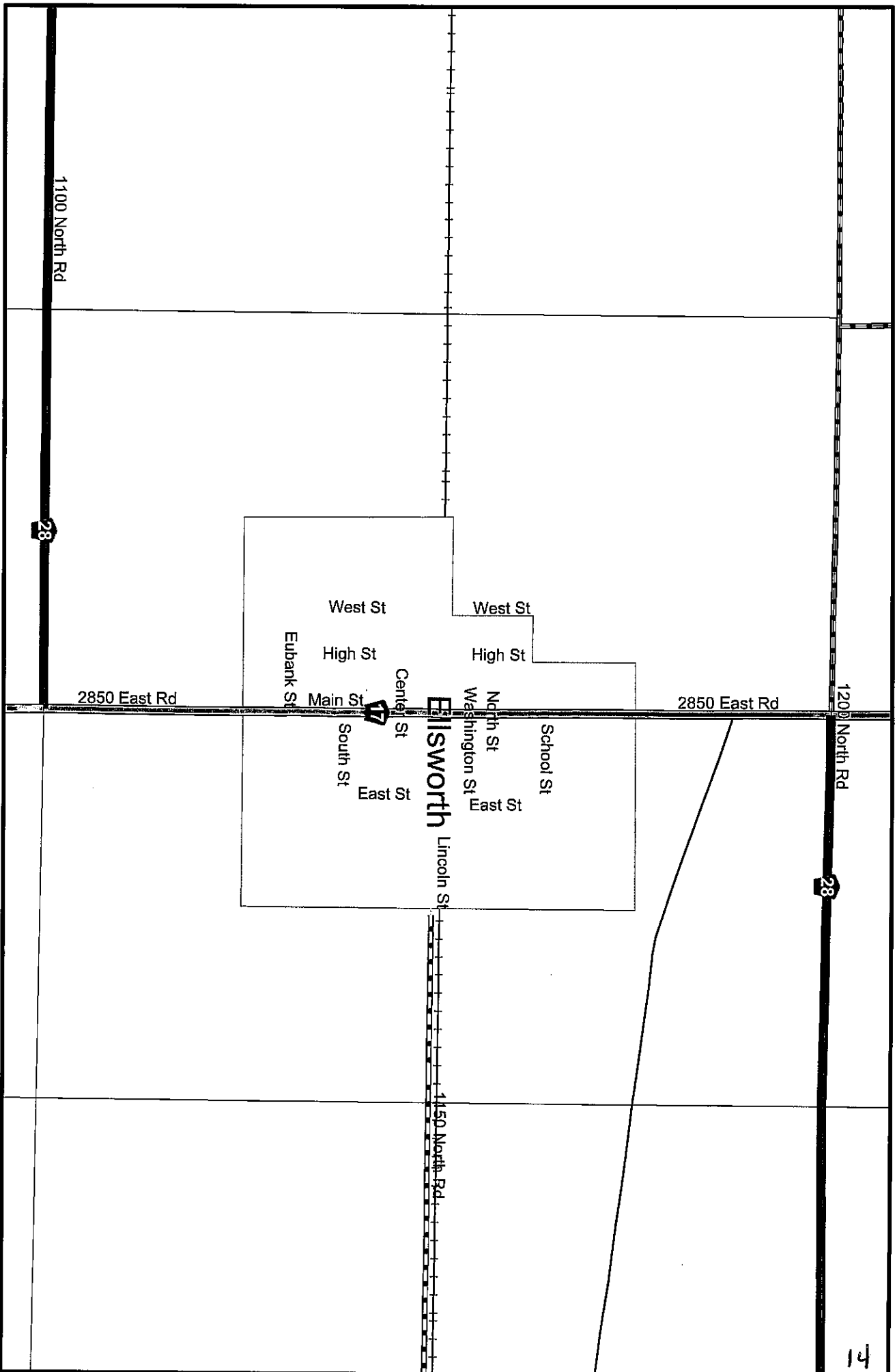

Legend

County Highways

Surface_Type

Hotmix

Oil Chip

FUNKS GROVE

2004 CENSUS POPULATION: N/A (UNINCORPORATED)

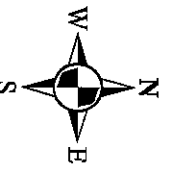
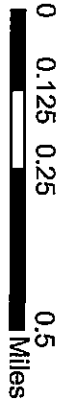
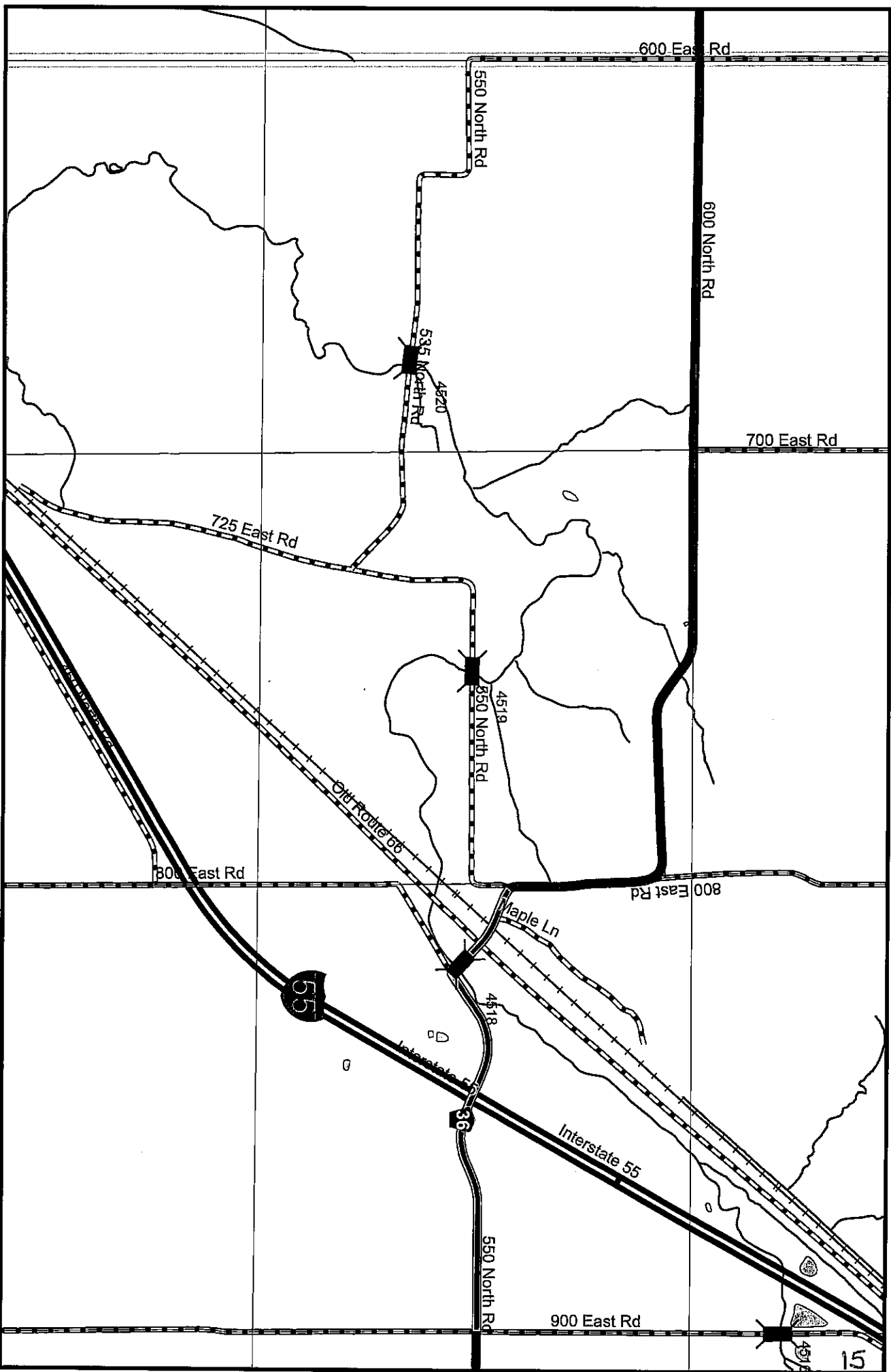

- Legend**
- County Highways**
- Hotmix
 - Oil Chip
- Surface_Type**

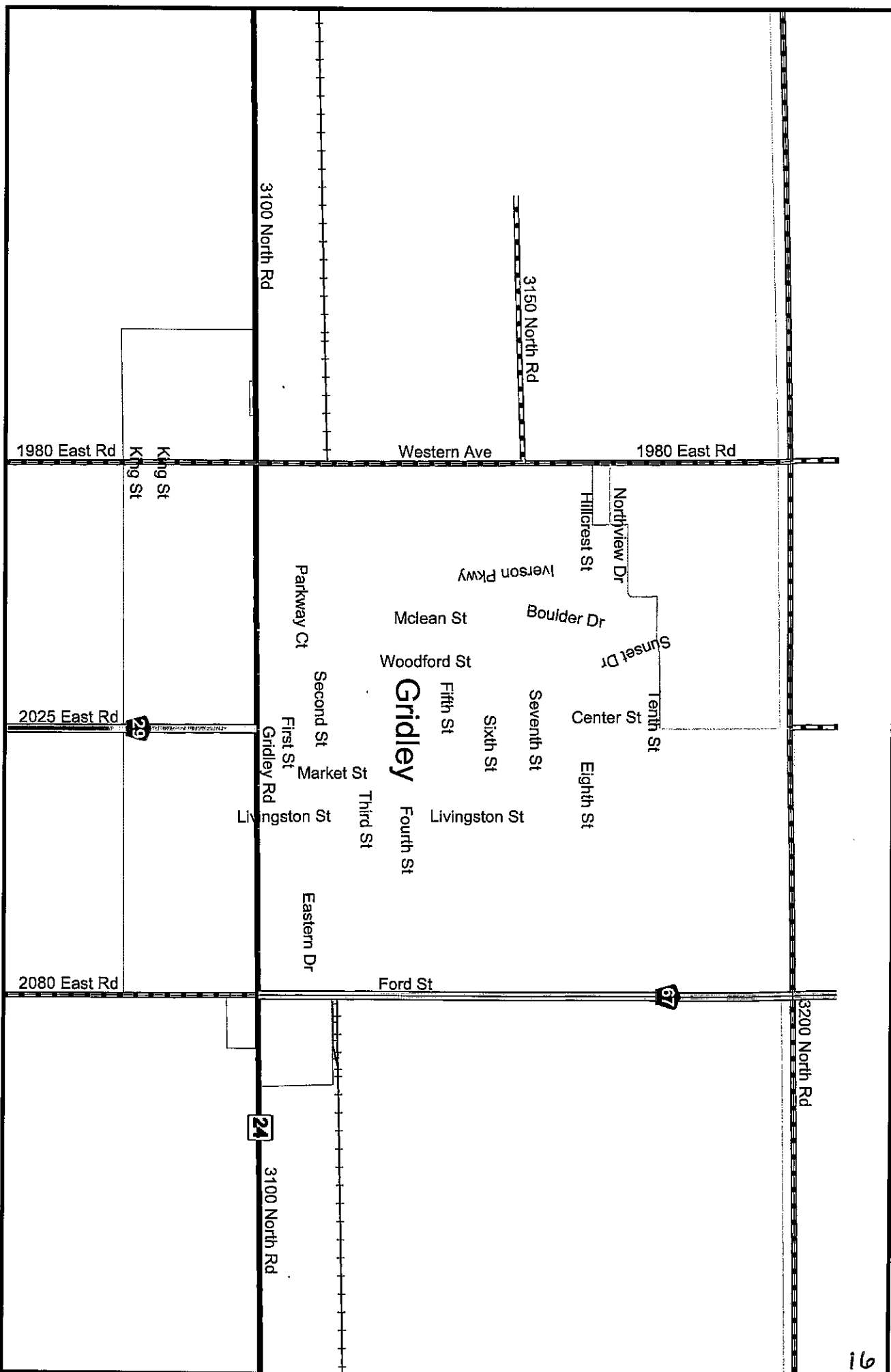

GRIDLEY

2004 CENSUS POPULATION: 1396

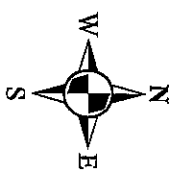
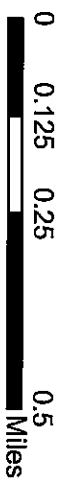

Legend

County Highways

Surface_Type

- Hotmix
- Oil Chip

HEYWORTH

2004 CENSUS POPULATION: 2477

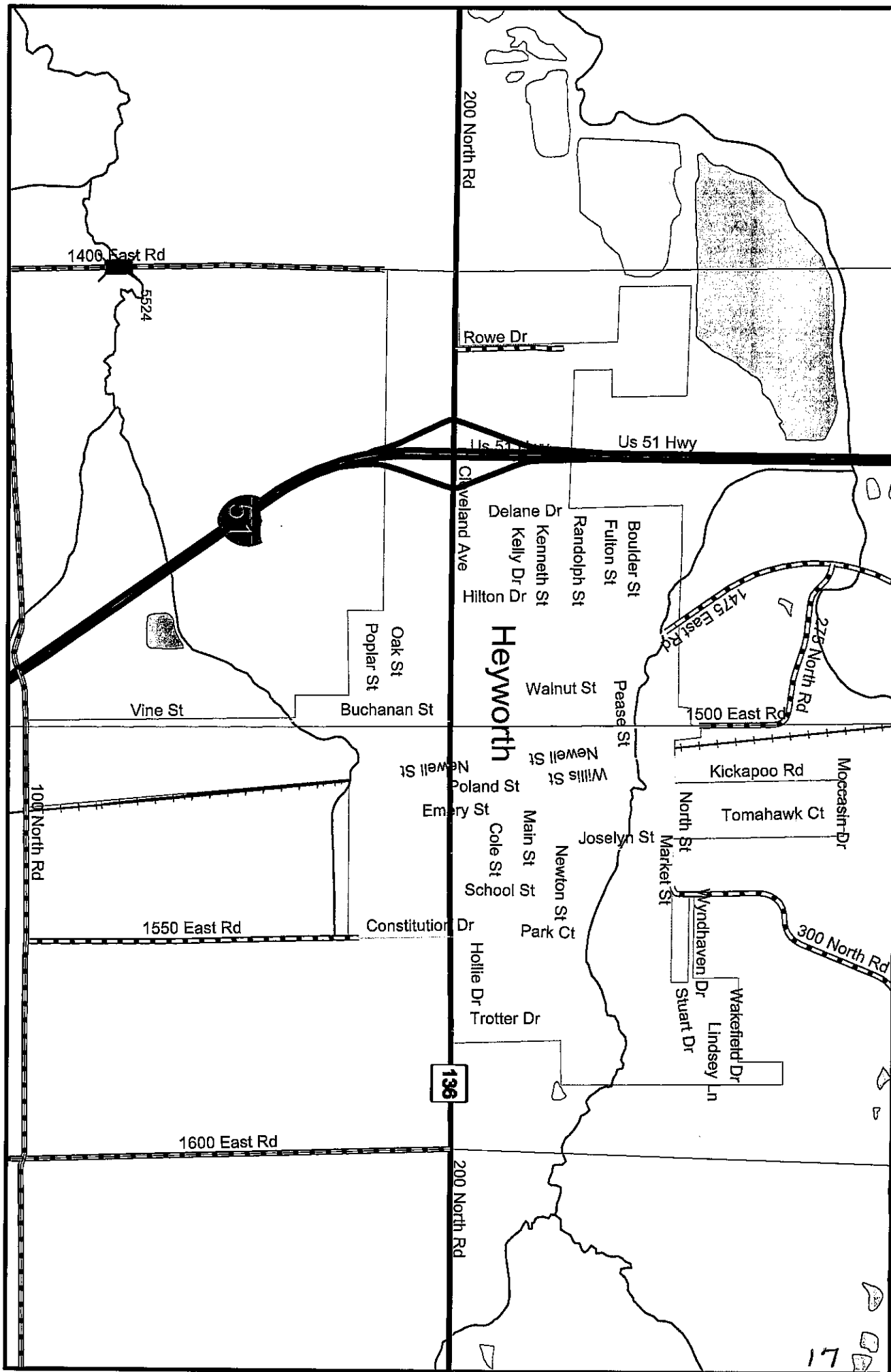

Legend

County Highways

Surface Type

- Hotmix
- Oil Chip

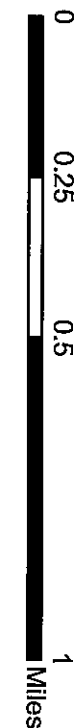

28 1200 North Rd

1200 North Rd

10

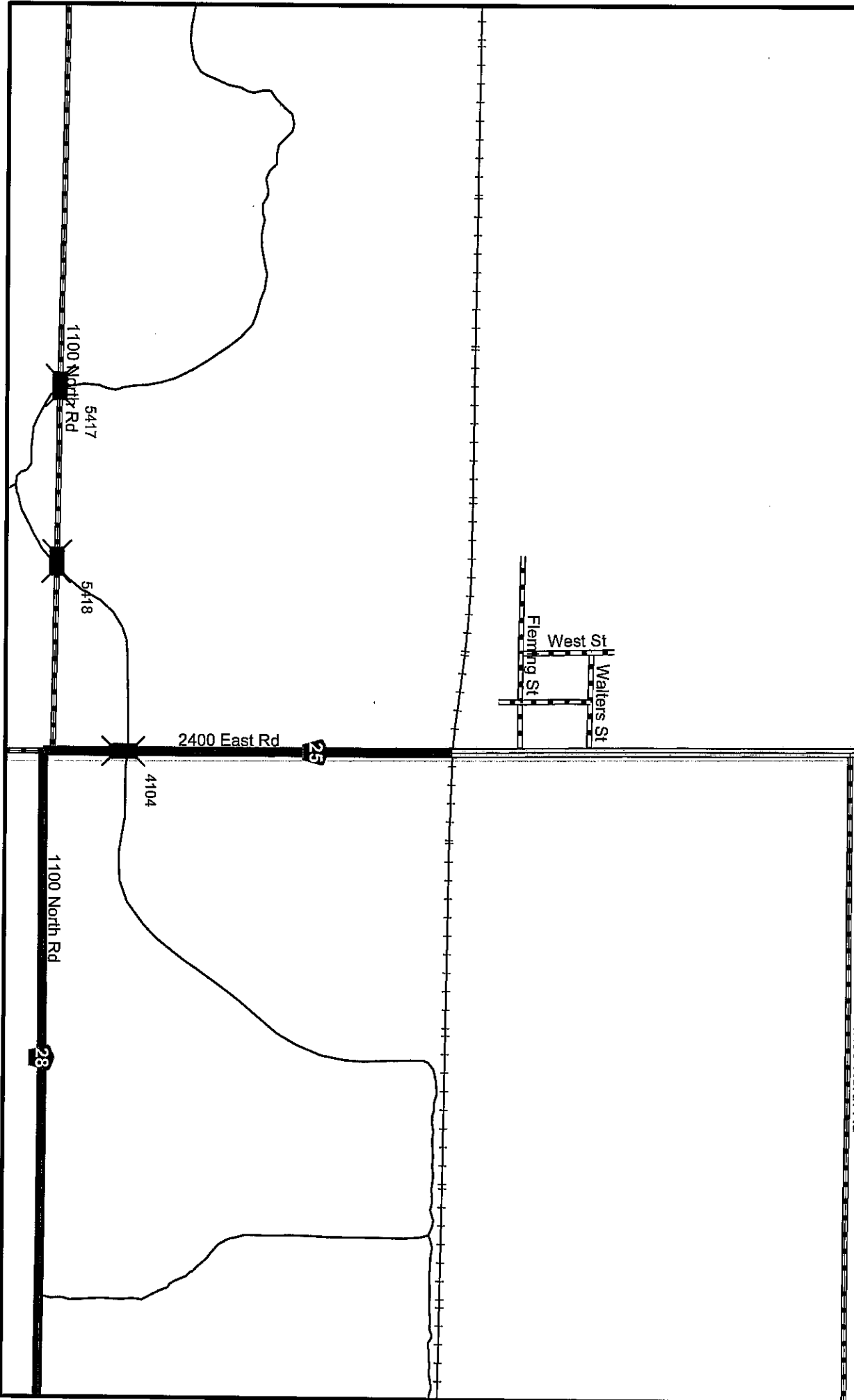
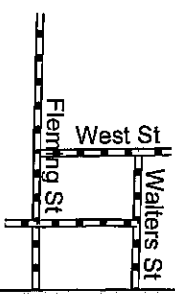

HOLDER

2004 CENSUS POPULATION: N/A (UNINCORPORATED)

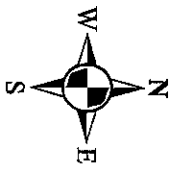

Legend

County Highways

Surface_Type

- Hotmix
- Oil Chip

HUDSON

2004 CENSUS POPULATION: 1623

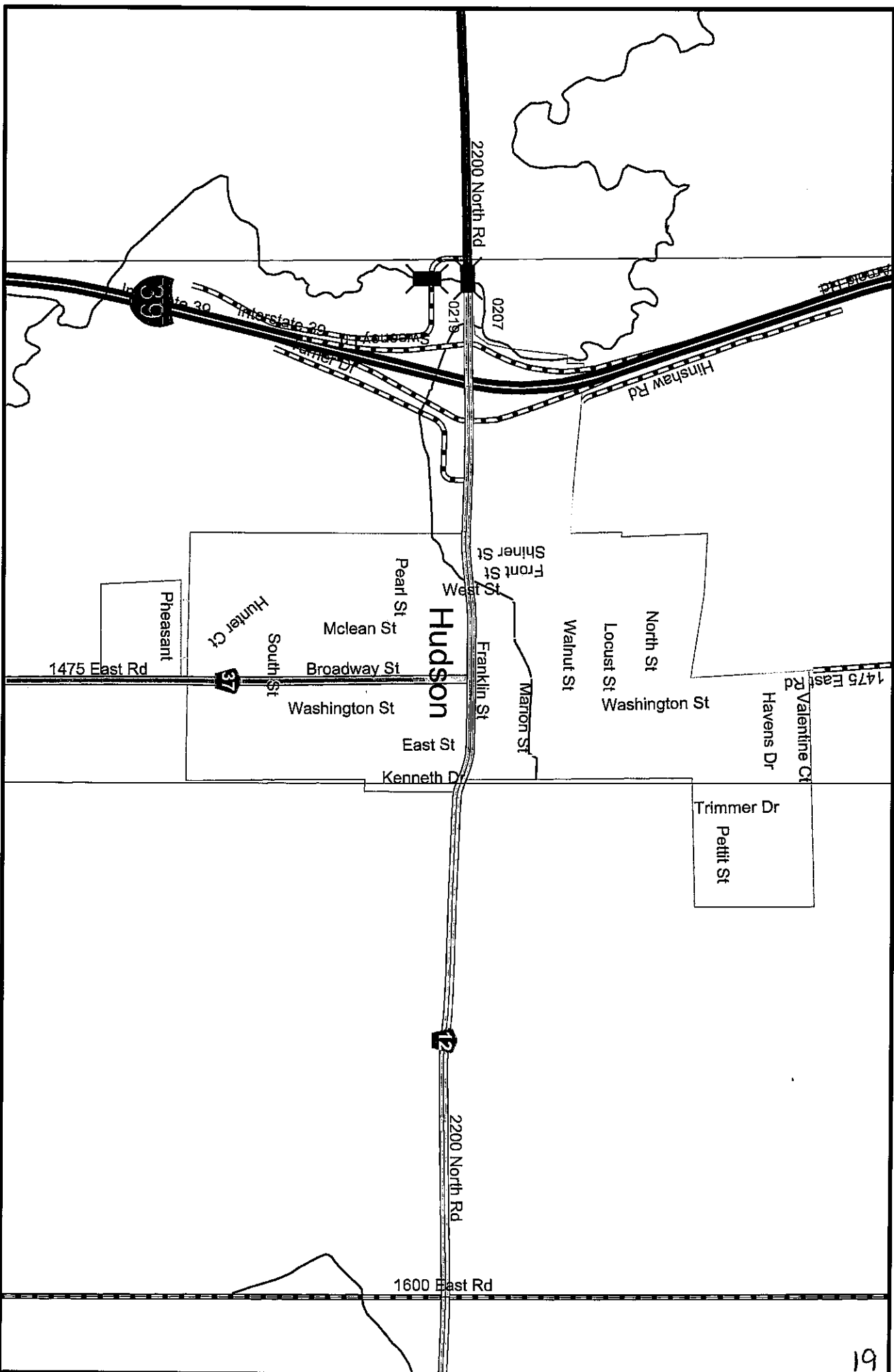

2004 CENSUS POPULATION: 1879

LEXINGTON

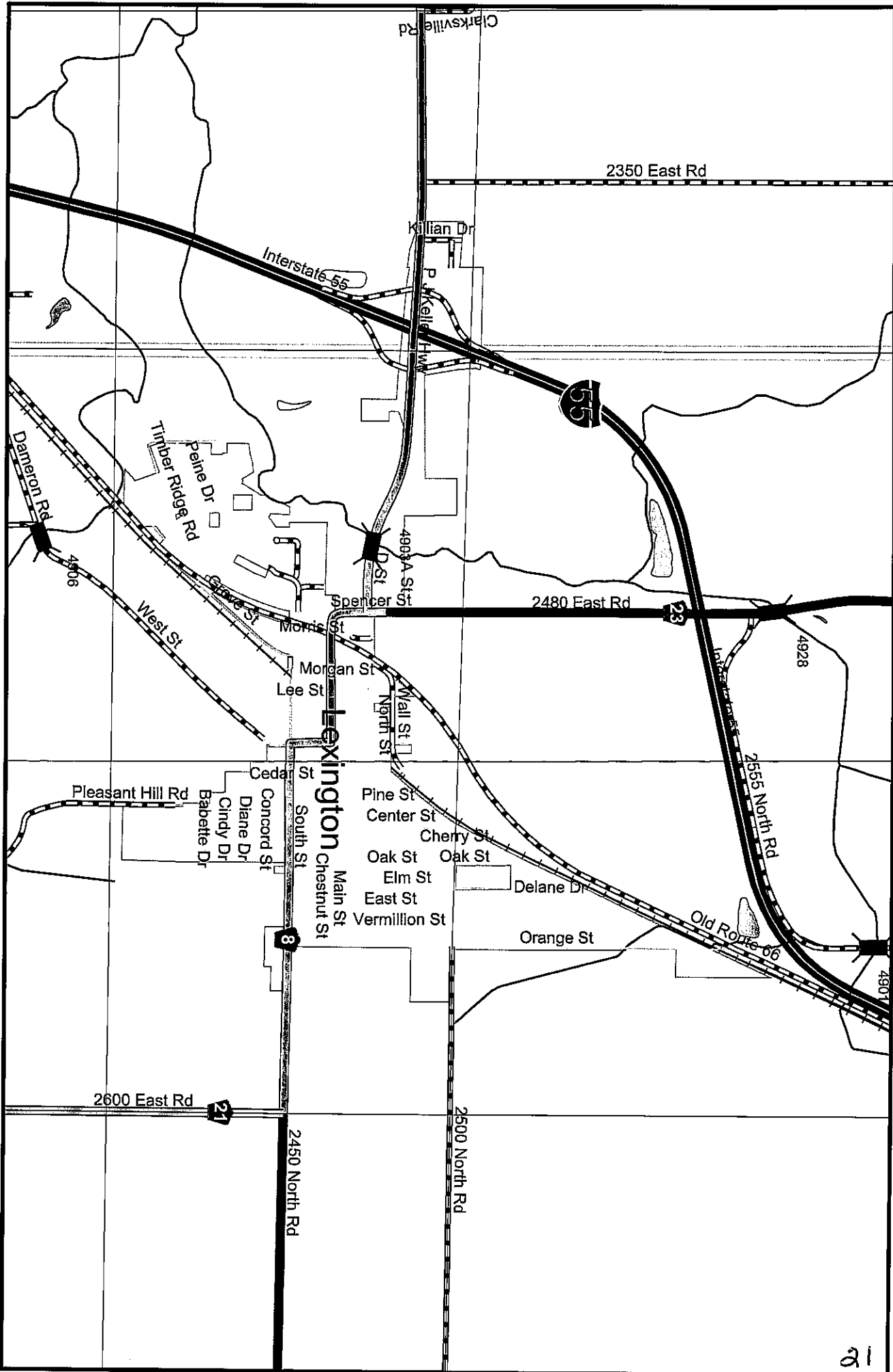

Legend

County Highways

Surface_Type

- Hotmix
- Oil Chip

McLEAN

2004 CENSUS POPULATION: 792

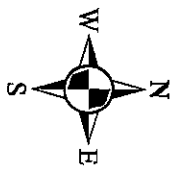
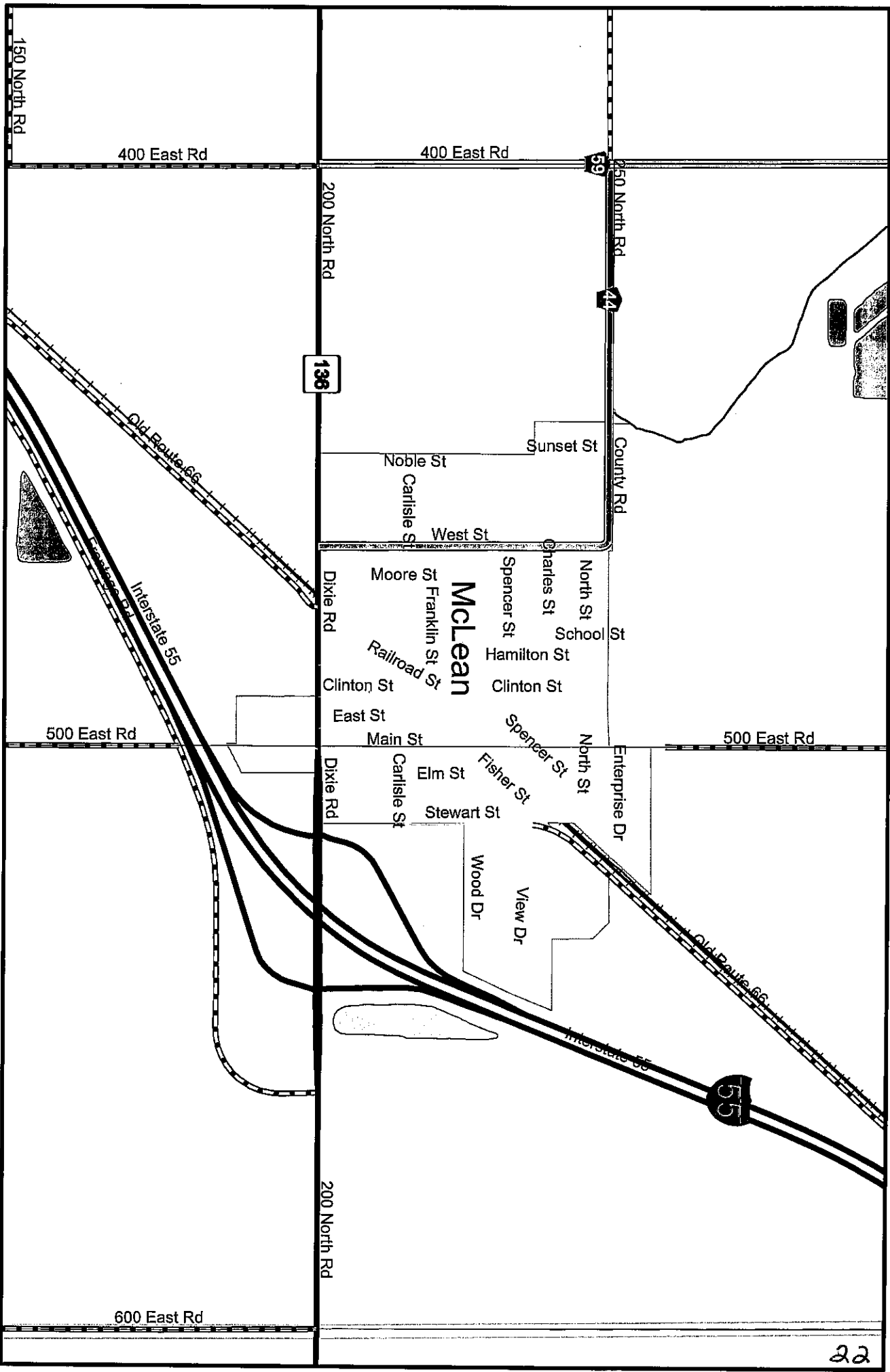

Legend

County Highways

Surface_Type

- Hotmix
- Oil Chip

MEADOWS

2004 CENSUS POPULATION: N/A (UNINCORPORATED)

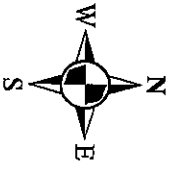
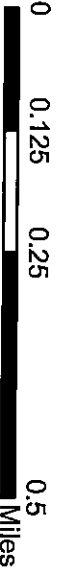
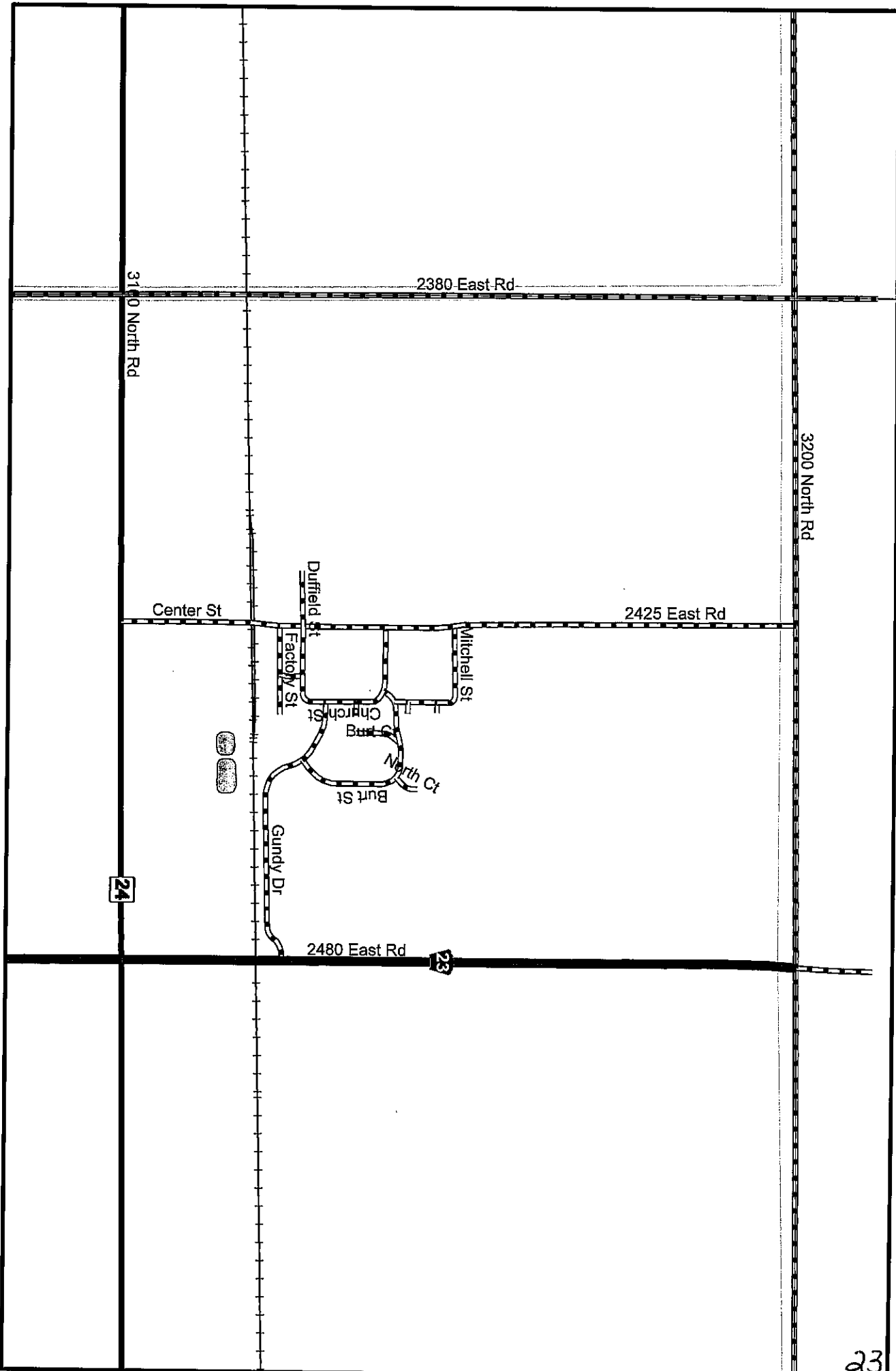

Legend

- County Highways
- Surface_Type
- Hotmix
- Oil Chip

MERNA

2004 CENSUS POPULATION: N/A (UNINCORPORATED)

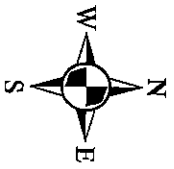
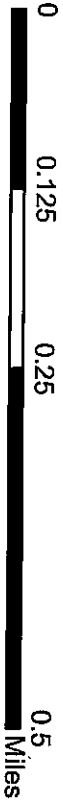
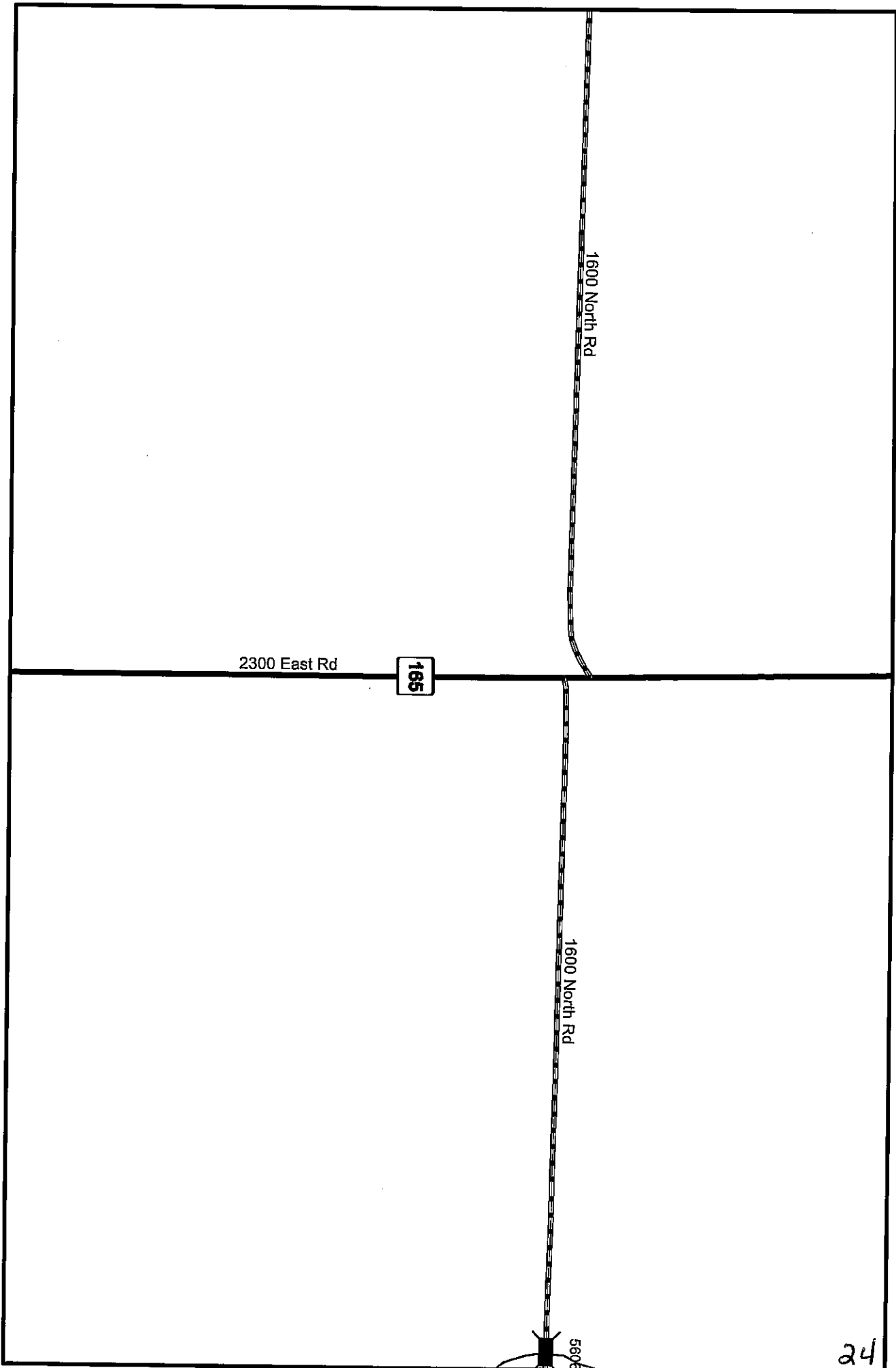

Legend

- County Highways**
- Hotmix
 - Oil Chip

PADUA

2004 CENSUS POPULATION: N/A (UNINCORPORATED)

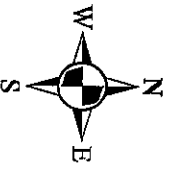
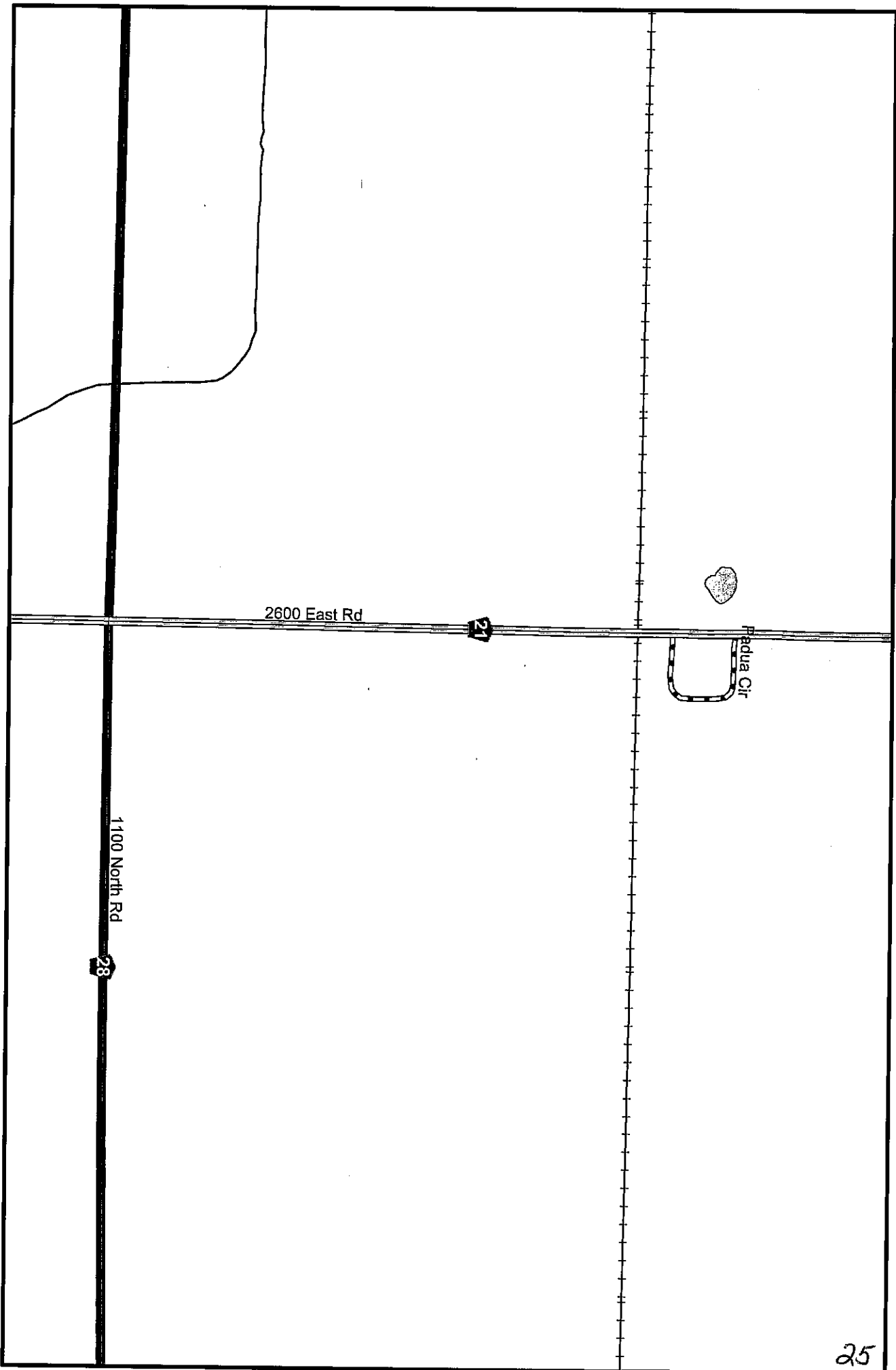

Legend

- County Highways
Surface_Type
Hotmix
Oil Chip

AYBROOK

24 CENSUS POPULATION: 740

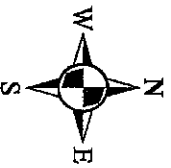
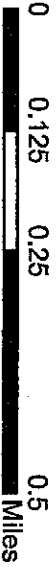
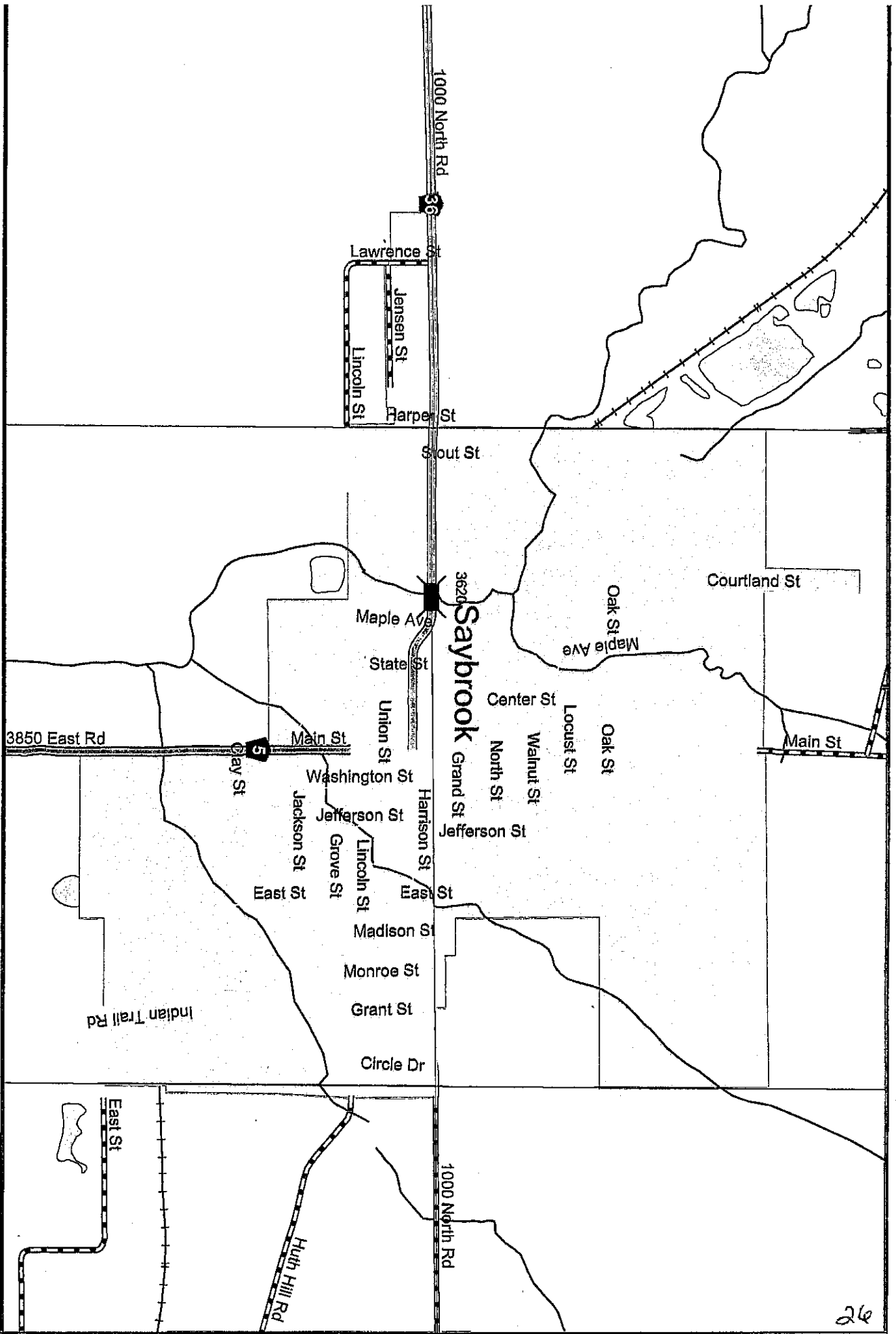

Legend

County Highways

Surface_Type

- County Highway
- Hotmix
- Oil Chip

SHIRLEY
 2004 CENSUS POPULATION: N/A (UNINCORPORATED)

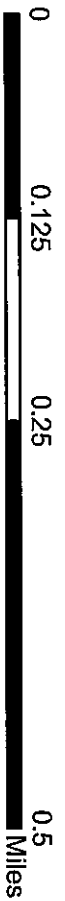
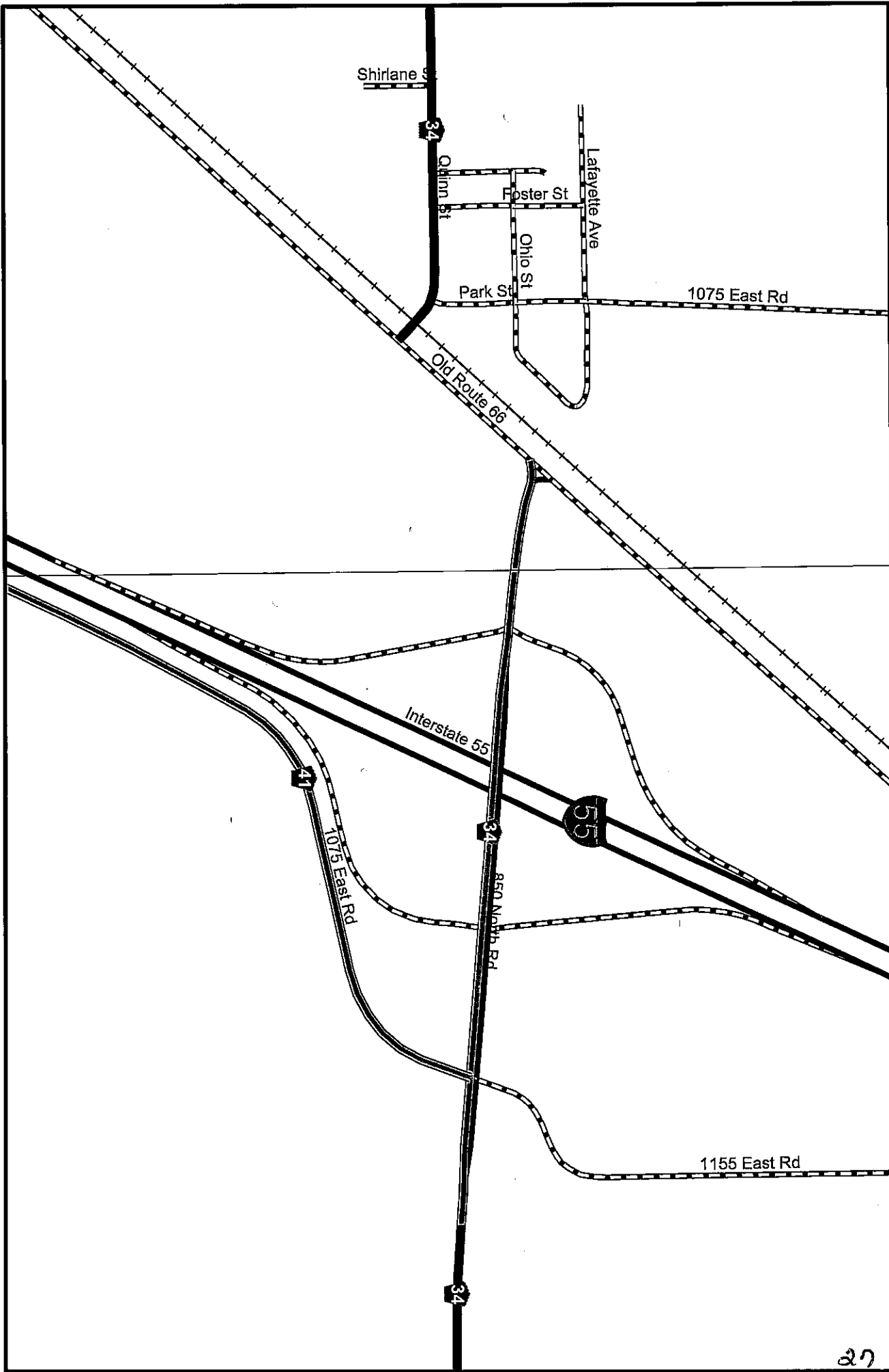

Legend

County Highways

Surface_Type

- Hotmix
- Oil Chip

STANFORD

2004 CENSUS POPULATION: 651

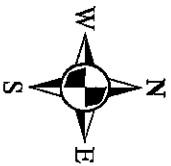
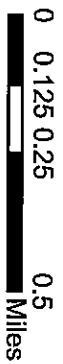
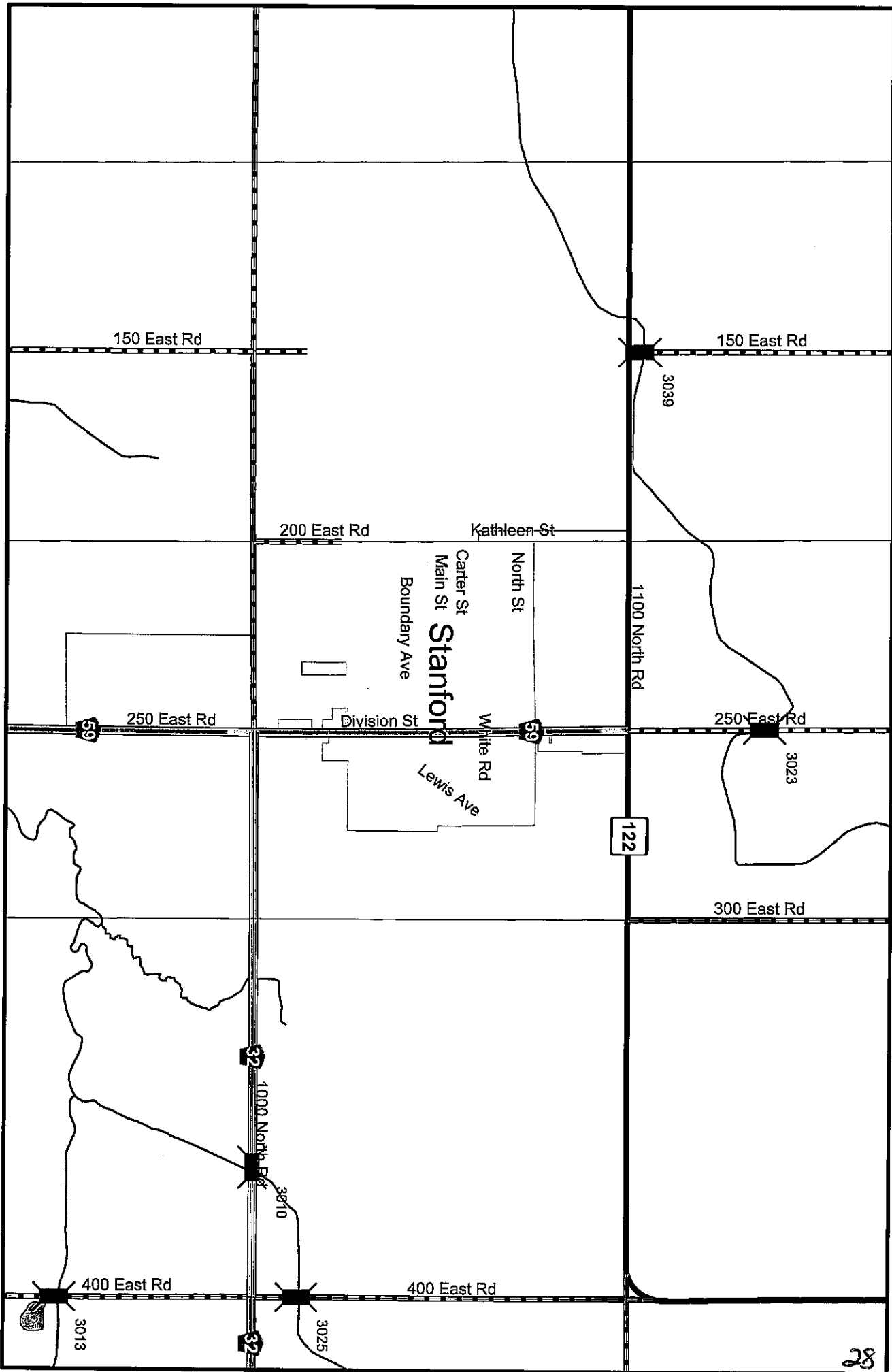

Legend

- County Highways
- Surface_Type
- Hotmix
- Oil Chip

TOWANDA

2004 CENSUS POPULATION: 482

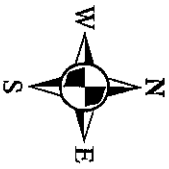
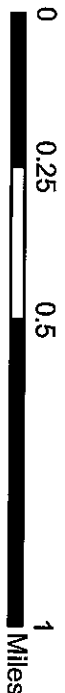
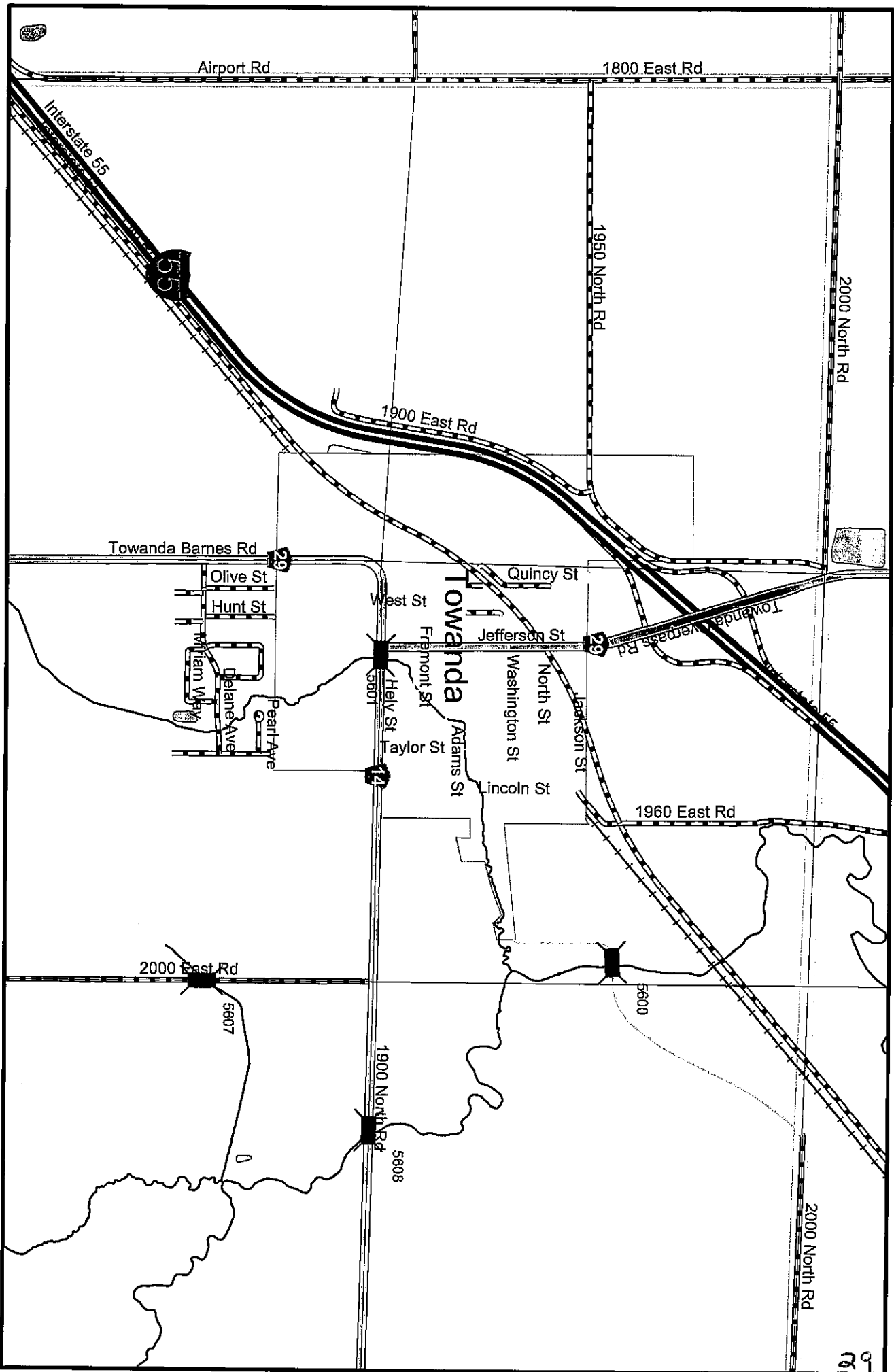

Legend

- County Highways**
- Surface_Type**
- Hotmix
- Oil Chip

3150 North Rd

North St

2nd St
Oak St
1st St

Hazel St

Maple St

2nd St
1st St
Ash St

Elm St

3rd St

3360 East Rd

3100 North Rd

24



WESTON

2004 CENSUS POPULATION: N/A (UNINCORPORATED)

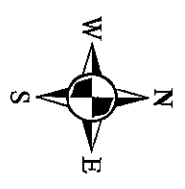
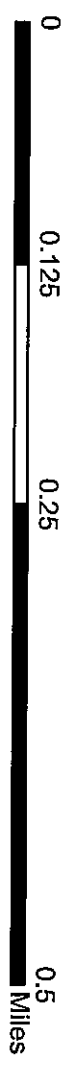

Legend

County Highways

Surface_Type

- Hotmix
- Oil Chip

Local Agency McLean County	 Illinois Department of Transportation	Job Number - Construction C-95-307-06
Section 04-00040-03-WR		Job Number - Engineering

**Truck Access Route Program (TARP)
Agreement**

This Agreement is made and entered into between the above local agency hereinafter referred to as "LA", and the State of Illinois, acting by and through its Department of Transportation, hereinafter referred to as "STATE". The STATE and LA jointly propose to improve the designated location as shown below.

Location

Local Name Bentown-Holder Road Route CH 25 Lane Miles 3.527 miles

Number of Eligible Intersections 3

Terminj from IL 9 to .487 mile south of 1100N & Intersections at IL 9, CH 28 (1200N), & Fleming St.

Current Jurisdiction McLean County / Old Town Road District (North 3.040 miles - McLean Co; south 0.487 mile Old Town Road District)

Project Description

Reconstruction to 80,000 pound access

Division of Cost

Type of Work	TARP (1)	LA (2)	Total
Participating Construction	256,620	1,143,380	1,400,000
Non-Participating Construction			
Preliminary Engineering			
Construction Engineering			
TOTAL	\$256,620	\$1,143,380	\$1,400,000

Note

- 1/ It is mutually agreed that the STATE'S share of the PROJECT cost under the Truck Access Route Program shall be a lump sum amount of \$256,620 not to exceed 50% of the final construction cost, whichever is the lesser.
- 2/ Any remaining balance shall be the responsibility of the LA.

Upon award of the project and request of payment from the LA, the STATE will pay the LA its share of the project costs.

Agreement Provisions

1. It is mutually agreed that the PROJECT will be processed, let and constructed in accordance with Motor Fuel Tax standards, policies and procedures.
 2. The LA will certify to the STATE that all necessary right-of-way, temporary and permanent easements, and temporary use permits have been obtained or are not required, prior to the LA advertising for bids for the PROJECT.
 3. The PROJECT will be let and awarded by the LA upon approval of the plans and specifications by the STATE.
 4. The LA agrees to retain jurisdiction and to maintain or cause to be maintained in a manner satisfactory to the STATE, the completed PROJECT.
 5. Upon approval of the final plans and specifications by the STATE and the LA, the LA agrees to accept bids and award the contract for construction of the proposed improvements after receipt of a satisfactory bid and after concurrence in the award has been received from the STATE and provide, or cause to be provided, all of the initial funding necessary to complete the project subject to partial reimbursement by the STATE.
 6. The LA agrees to pass an ordinance/resolution clearly defining the limits of the proposed 80,000 pound truck route and identifying the truck route class. A copy of said ordinance/resolution is attached as Exhibit B. Such truck route shall be properly signed in accordance with the Illinois Manual on Uniform Traffic Control Devices. Cost of truck route signing is included in estimated cost of the PROJECT.
 7. The LA shall maintain, for a minimum of 3 years after the completion of the project, adequate books, records, and supporting documents to verify the amounts, recipients and uses of all disbursements of funds passing in conjunction with this Agreement. All books, records, and supporting documents related to the project shall be available for review and audit by the Auditor General and the Department. The LA agrees to cooperate fully with any audit conducted by the Auditor General and the Department and to provide full access to all relevant materials. Failure to maintain the books, records and supporting documents required by this section shall establish a presumption in favor of the STATE for the recovery of any funds paid by the STATE under the contract of which adequate books, records, and supporting documentation are not available to support their purported disbursement.
 8. Obligations of the STATE shall cease immediately without penalty or further payment being required if, in any fiscal year, the Illinois General Assembly fails to appropriate or otherwise make available funds for the work contemplated herein.
 9. All projects for the construction of fixed works which are financed in whole or in part with funds provided by this Agreement shall be subject to the Prevailing Wage Act (820 ILCS 130/0.01 et seq.) unless the provisions of that Act exempt its application.
 10. This Agreement shall be binding upon and inure to the benefit of the parties hereto, their successors and assigns.
-

Local Agency McLean County	Section 04-00040-03-WR
-------------------------------	---------------------------

EXHIBITS

Additional information and/or stipulations are hereby attached and identified below as being a part of this Agreement.

Exhibit A - Location Map

Exhibit B - 80,000lb Truck Route Resolution/Ordinance

Addendum #1 - Jurisdiction

The LA further agrees, as a condition of payment, that it accepts and will comply with the applicable provisions set forth in this Agreement and all exhibits indicated above.

APPROVED

Name Michael Sweeney

Title County Board Chairperson
County Board Chairperson/Mayor/Village President/etc.

Signature _____

Date _____

TIN Number 37-6001569

APPROVED

State of Illinois
Department of Transportation

Timothy W. Marlin - Secretary of Transportation

Date _____

Millon R. Sees - Director of Highways/Chief Engineer

Ellen Schanzle-Haskins - Chief Counsel

Ann L. Schneider - Director of Finance and Administration

NOTE: If signature is by an APPOINTED official, a resolution authorizing said appointed official to execute this agreement is required.

Local Agency McLean County	Section 04-00040-03-WR
-------------------------------	---------------------------

LOCATION MAP
McLEAN COUNTY SECTION
04-00040-03-WR
HOLDER RD (CH 25)

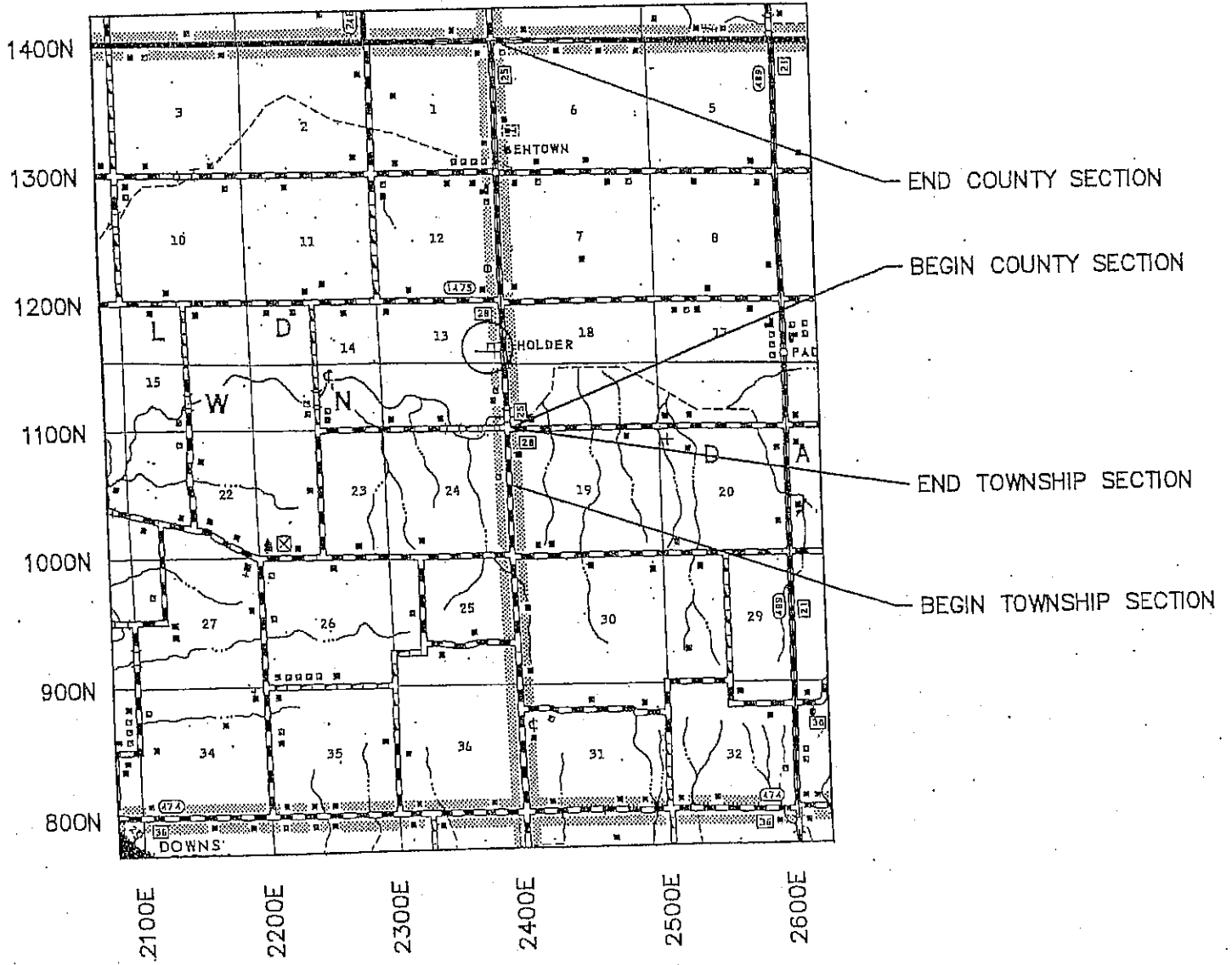

ADDENDUM # 1

Jurisdiction

The ROAD DISTRICT hereby agrees:

1. To the implementation of the subject improvement by the STATE and COUNTY.
2. To retain jurisdiction of the completed improvement.
3. To maintain or cause to be maintained in a manner satisfactory to the STATE and THE FHWA, the completed improvement.

Phil Reynolds
Highway Commissioner

4-27-06
Date

McLEAN COUNTY WEIGHT LIMIT RESOLUTION

WHEREAS, it is hereby deemed to be of mutual benefit for McLean County, Evergreen FS Incorporated, and Streutker Dairy to enter into an agreement to increase the weight limit of the Bentown-Holder Road, McLean County Highway 25, from Illinois Route 9 to County Road 1100N to 80,000 pounds.

NOW THEREFORE, the McLean County Board hereby approves the attached McLean County Weight Limit Agreements with Evergreen FS Incorporated and Streutker Dairy, and authorizes the Chairman of the McLean County Board to sign said agreements, and also,

The McLean County Board hereby establishes the Bentown-Holder Road, McLean County Highway 25, from Illinois Route 9 to County Road 1100N, a distance of 16,051 feet (3.040 Miles), as a Class III Truck Route with an 80,000 pounds maximum weight limit. Said designation to be effective upon the completion of the resurfacing of said highway, Section 04-00040-03-WR, and the erection of the signs designating this portion of road as a Class III Truck Route, as herein authorized.

Dated this 16th day of May, 2006.

APPROVED:

Michael F. Sweeney, Chairman
McLean County Board

ATTEST:

Peggy Ann Milton, Clerk of the County Board
of McLean County, Illinois

McLEAN COUNTY
WEIGHT LIMIT AGREEMENT

This Agreement entered into this day by and between Streutker Dairy and McLean County hereby provides for the following:

1. Streutker Dairy will pay for one-fourth (1/4) of the cost of increasing the weight limit on the Bentown-Holder Road, County Highway 25, from the Railroad Tracks in Holder south approximately 2,731 feet to County Road 1100N, from 73,280 pounds to 80,000 pounds for semi trailer loads. The total estimated cost of this work is based on 340 tons of bituminous hot mix at fifty four dollars (\$54.00) per ton for a total of Eighteen Thousand Three Hundred Sixty dollars (\$18,360.00). Streutker Dairy estimated share of the cost for their one fourth (1/4) of this is Four Thousand Five Hundred Ninety dollars (\$4,590.00). The actual amount owed by Streutker Dairy to the McLean County Highway Department shall be for 85 tons of bituminous hot mix binder course at the bid price on McLean County Section 04-00040-03-WR.
2. McLean County hereby agrees to designate the Bentown-Holder Road, County Highway 25, from the Railroad Tracks in Holder southerly approximately 2,731 feet to County Road 1100N as an 80,000 pound Class III Truck Route upon completion of the resurfacing project, Section 04-00040-03-WR and signed accordingly.
3. Payment by Streutker Dairy is due upon the completion of resurfacing of the Bentown-Holder Road, County Highway 25, Section 04-00040-03-WR and billing from the McLean County Highway Department.
4. McLean County Highway Department shall pay for the balance of the cost of this project.
5. It is mutually agreed that this Agreement shall be null and void should the resurfacing of the Bentown-Holder Road from the Railroad Tracks in Holder to County Road 1100N not be completed within three (3) years after the date of this Agreement.

Streutker Dairy

McLean County Board



Richard Streutker
Streutker Dairy

Michael F. Sweeney, Chairman
McLean County Board

Date: 4/20, 2006

Date: _____, 2006.

McLEAN COUNTY
WEIGHT LIMIT AGREEMENT

This Agreement entered into this day by and between Evergreen FS, Inc. and McLean County hereby provides for the following:

1. Evergreen FS, Inc. will pay for one-fourth (1/4) of the cost of increasing the weight limit on the Bentown-Holder Road, County Highway 25, from IL Rt. 9 south approximately 13,320 feet to the Railroad Tracks in Holder, from 73,280 pounds to 80,000 pounds for semi trailer loads. The total estimated cost of this work is based on 1989 tons of bituminous hot mix at fifty four dollars (\$54.00) per ton for a total of One Hundred Seven Thousand Four Hundred Six dollars (\$107,406.00). Evergreen FS, Inc.'s estimated share of the cost for their one fourth (1/4) of this is Twenty-Six Thousand Eight Hundred Thirty-Eight dollars (\$26,838.00). The actual amount owed by Evergreen FS, Inc. to the McLean County Highway Department shall be for 497 tons of bituminous hot mix binder course at the bid price on McLean County Section 04-00040-03-WR.
2. McLean County hereby agrees to designate the Bentown-Holder Road, County Highway 25, from IL Rt. 9 southerly approximately 13,320 feet to the Railroad Tracks in Holder as an 80,000 pound Class III Truck Route upon completion of the resurfacing project, Section 04-00040-03-WR and signed accordingly.
3. Payment by Evergreen FS, Inc. is due upon the completion of resurfacing of the Bentown-Holder Road, County Highway 25, Section 04-00040-03-WR and billing from the McLean County Highway Department.
4. McLean County Highway Department shall pay for the balance of the cost of this project.
5. It is mutually agreed that this Agreement shall be null and void should the resurfacing of the Bentown-Holder Road from IL Rt. 9 south to the Railroad Tracks in Holder not be completed within three (3) years after the date of this Agreement.

Evergreen FS, Inc.

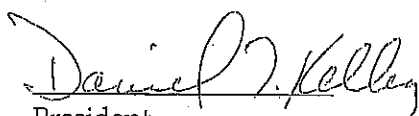

President
Evergreen FS, Inc.

Date: April 20, 2006

McLean County Board

Michael F. Sweeney, Chairman
McLean County Board

Date: _____, 2006.

**AN EMERGENCY REVENUE AND APPROPRIATION ORDINANCE
AMENDING THE MCLEAN COUNTY FISCAL YEAR 2006,
COMBINED ANNUAL APPROPRIATION AND BUDGET ORDINANCE
COUNTY HIGHWAY FUND 0120, DEPARTMENT 0055, PROGRAM 0056**

WHEREAS, the McLean County Board, on November 15, 2005 adopted the Combined Annual Appropriation and Budget Ordinance, which sets forth the revenues and expenditures deemed necessary to meet and defray all legal liabilities and expenditures to be incurred by and against the County of McLean for the 2006 Fiscal Year beginning January 1, 2006 and ending December 31, 2006; and,

WHEREAS, the Combined Annual Appropriation and Budget Ordinance includes the operating budget for the County Highway Department 0055, County Highway Fund 0120; and

WHEREAS, the operating budget for the County Highway Department includes reconstruction of the Ellsworth Road, Arrowsmith Road, and Lexington – LeRoy Road per an agreement with High Trail Wind Farm LLC and Old Trail Wind Farm LLC; and

WHEREAS, the Transportation Committee, on Tuesday, May 2, 2006, approved and recommended to the County Board an Emergency Revenue and Appropriation Ordinance in the amount of \$991,464.95 to account for the added expenditures greater than the budgeted appropriation due to the High Trail Wind Farm LLC and Old Trail Wind Farm LLC Road Agreement, and

NOW THEREFORE BE IT ORDAINED by the McLean County Board as follows:

1. That the County Auditor is directed to increase the Revenue line item 0120-0055-0056-0410.0010 of the County Highway Fund 0120 in the amount of \$ 991,464.95, and
2. That the County Auditor is directed to add to the appropriated budget of the County Highway Department 0055, County Highway Fund 120, the following appropriation:

0120-0055-0056-0810.0001	\$991,464.95
--------------------------	--------------
3. That the County Clerk shall provide a copy of this ordinance to the County Administrator, County Auditor, County Treasurer, and the County Engineer of the County Highway Department.

ADOPTED by the County Board of McLean County this 16th day of May 2006.

ATTEST:

APPROVED:

Peggy Ann Milton, Clerk of the County
Board of McLean County, Illinois

Michael F. Sweeney, Chairman
McLean County Board